

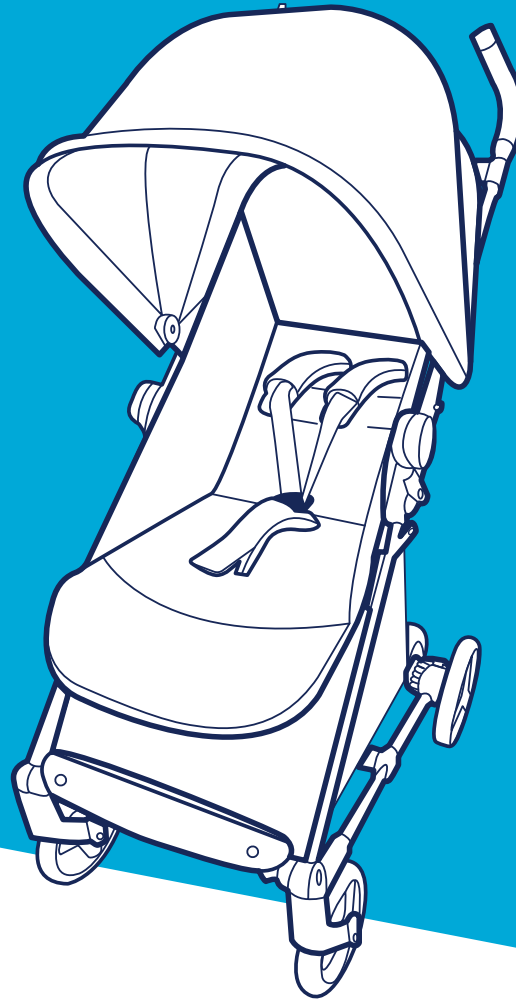

# Mara XT

Ultra Compact Stroller  
50 lb (22.7 kg)



**MAXI-COSI**® 4358-8155 3.3.21

We carry the future

KEEP INSTRUCTIONS FOR FUTURE USE.  
Read all instructions before using this stroller.

# Safety Information

## **WARNING:**

**FOR THE SAFETY OF YOUR CHILD, PLEASE READ THE FOLLOWING WARNINGS AND INSTRUCTIONS AND KEEP FOR FUTURE REFERENCE.**

- Adult assembly required.
- **NEVER LEAVE CHILD UNATTENDED. ALWAYS** keep child in view when in stroller.
- **AVOID SERIOUS INJURY** from falling or sliding out. **ALWAYS** use the harness system. Check frequently to make sure it is secure.
- **ALWAYS** keep fingers away from moving parts, when folding, unfolding or adjusting stroller to prevent finger entrapment.
- **ALWAYS** make sure stroller is fully open and locked before using.
- **ALWAYS** use the brakes when stroller is stopped.
- **ALWAYS** remove protective material and poly bags and dispose before assembly.
- **NEVER** put hot liquids in the cup holder.
- **NEVER** use stroller on stairs or escalators.
- **NEVER** rollerblade with stroller.
- **NEVER** allow children to play with or hang onto the stroller.
- **NEVER** allow children to climb into the stroller unassisted. Stroller may tip over and injure child.

- **NEVER** place or hang parcels, bags, or accessories on the handle or canopy. The stroller may tip over or the canopy may collapse.
- This product will become unstable if a parcel bag or rack is used when there is no provision for one.
- This product may become unstable if a parcel bag, other than the one recommended by the manufacturer is used.
- This product will become unstable if the manufacturer's recommended load is exceeded.
- Care must be taken when folding and unfolding the stroller to prevent finger entrapment.
- **DO NOT** carry additional children, goods, or accessories in or on this product except as recommended in the manufacturer's instructions.
- **NEVER** place more than 2 lbs (.9 kg) in the cup holder.
- **NEVER** place more than 1 lb (.5 kg) in the storage pocket.
- **NEVER** place more than 10 lb (4.5 kg) in the storage basket. If weight is exceeded, hazardous unstable conditions may exist.
- **STROLLER** is only for use with children up to 50 lb (27.7 kg), **AND WHEN SEATED**, the mid-point of your child's head is at or below the top of the stroller seat.
- **ONLY** use this stroller with **ONE** child at a time.
- **STROLLER** is for use with children who can sit up unassisted and is **NOT** recommended for newborns.
- Failure to follow the steps and warnings on the labels and in the instruction manual can result in serious injury or death to your child.

# Contents

Parts of Stroller .....	1	Adjusting Stroller Seat Harness Straps .....	10
Installing & Removing Front Wheels .....	2	Securing Child in Stroller Seat .....	12
Unfolding Stroller Frame .....	3	Folding Stroller .....	13
Using Parking Brake & Locking Swivel Wheels .....	4	Accessory Use & Care .....	14
Canopy Use .....	5	Wash & Care of Stroller Parts .....	14
Attaching Car Seat to Stroller Frame .....	6	Dorel Juvenile Group Information .....	15
Removing Car Seat from Stroller Frame .....	7	Replacement Parts .....	15
Reclining Stroller Seat .....	8	Warranty .....	15
Adjusting Footrest .....	8		
Storage Basket & Pocket Use .....	9		

# Parts of Stroller

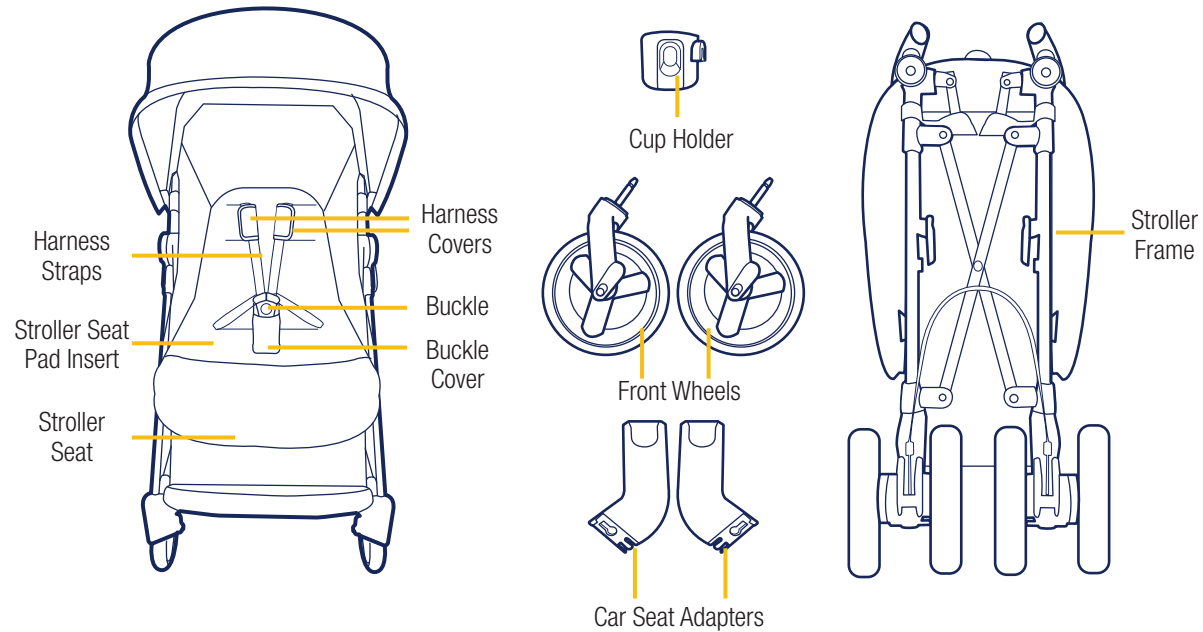

Lay out and identify all of the parts.

If any parts are missing, **do not return this product to the place of purchase.**

Please contact Consumer Care via:

- Phone: 1-800-951-4113
- Text: 1-812-652-2525
- Chat: [www.maxicosi.com](http://www.maxicosi.com)

You will need to know the model number and manufacture date.

It is located on a label on the stroller frame.

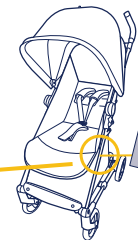

# Installing & Removing Front Wheels

## Installing Front Wheels

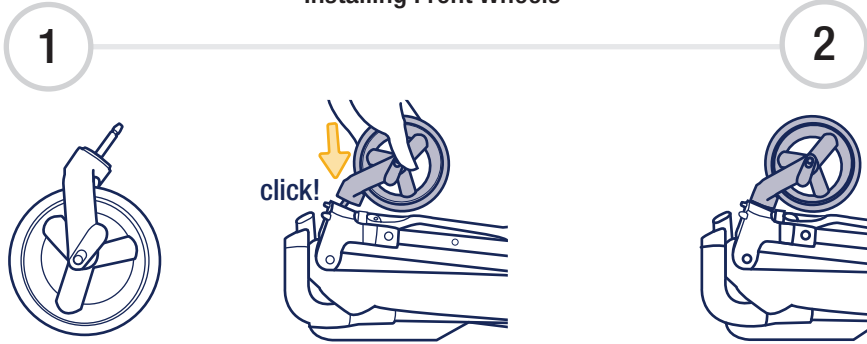

Attach the front wheels as shown.

**Finished!**

**NOTE:** Pull out on the wheels to make sure they are secured.

## Removing Front Wheels

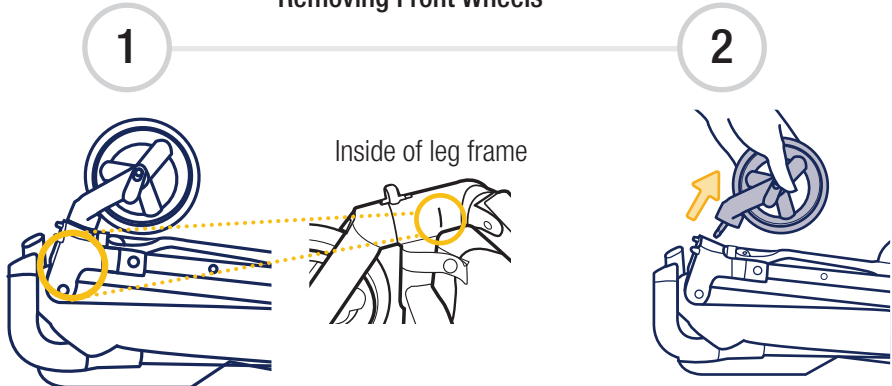

Press the release button on the stroller frame and hold it in.

Remove the front wheels.

# Unfolding Stroller Frame

Stroller Frame Latch

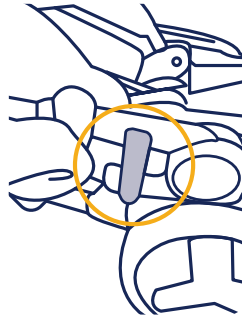

1



Push in on the stroller frame and then pull the stroller frame latch away from the stroller.

2

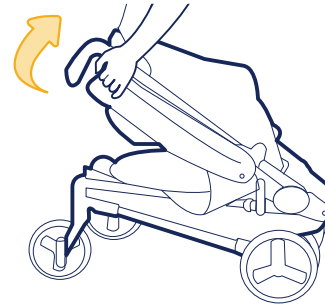

Hold the stroller frame as shown and lift up.

3



Continue to lift up until the stroller locks into place.

4

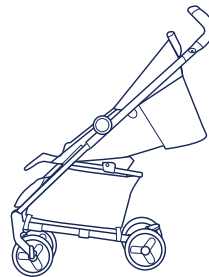

Finished!

## **⚠ WARNING:**

**ALWAYS** keep fingers away from moving parts, when folding, unfolding, or adjusting stroller to prevent finger entrapment.

# Using Parking Brake & Locking Swivel Wheels

## Rear Wheels

**Parking Brake**  
(locks both rear wheels)

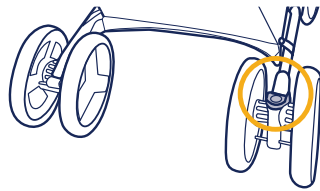

**To Lock Parking Brake**  
Push down.

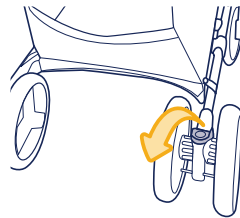

**To Release Parking Brake**  
Lift up.

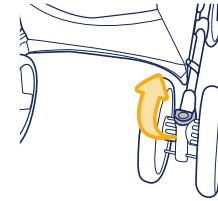

## Front Wheels

**Front Swivel Wheels**

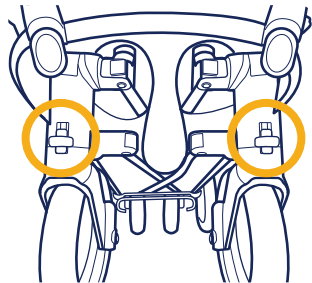

**To Lock Swivel Wheels**

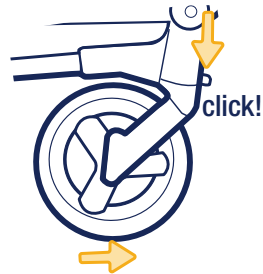

**To Unlock Swivel Wheels**



- The wheels must face forward as shown.
- Firmly push the lock tab down.
- Locked swivel wheels are best for traveling over rocky or uneven surfaces.

- Firmly pull the lock tab up.
- Unlocked swivel wheels are best for everyday strolling.



# Canopy Use

Pull the canopy forward to extend.

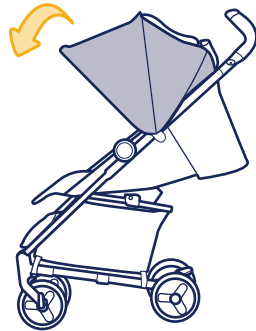

Locate the zipper and unzip to extend the canopy farther.

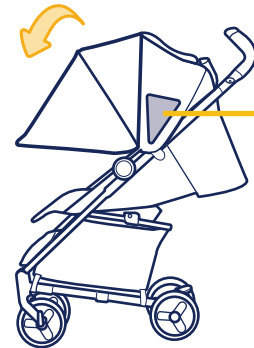
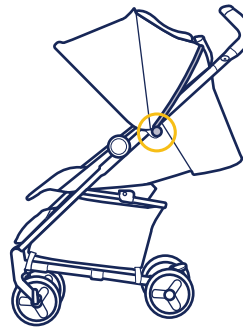

Air Flow Windows

Lift the fabric to access the Peek-a-Boo window.

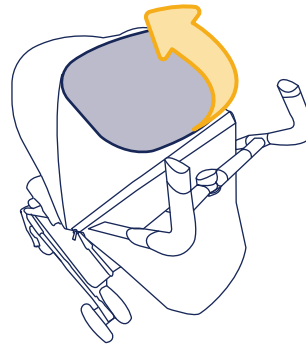

# Attaching Car Seat to Stroller Frame

Illustrations show a generic car seat icon.

1

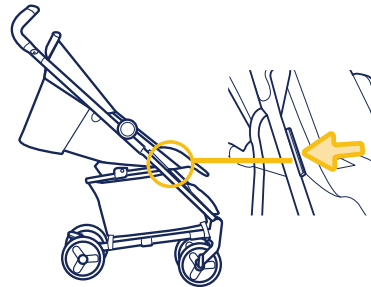

Locate the car seat adapter attachments on the stroller frame.

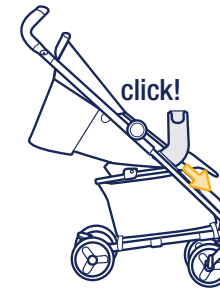

Match the colored dots on the adapters with the colored dots on the attachments.  
Slide the car seat adapters onto the attachments.

2

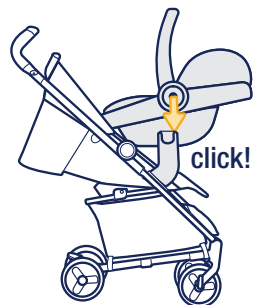

Attach the car seat to the car seat adapters.  
**ONLY** install the car seat rear-facing.

3



Pull up on the car seat either at the carry handle or handle hubs to check if it is securely attached.

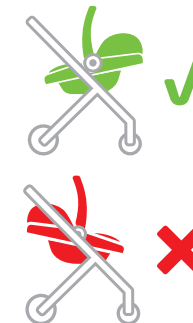

# Removing Car Seat from Stroller Frame

Illustrations show a generic car seat icon.



Mico Models'  
Stroller Release Buttons



Coral Models'  
Stroller Release Lever

1

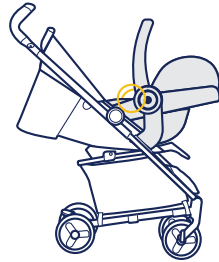

Car seat stroller  
release mechanisms  
& locations vary by  
car seat model.

Review your car seat's  
instruction manual  
to locate the stroller  
release mechanism  
on your car seat.

2

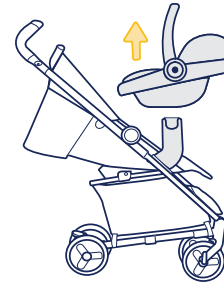

While engaging  
your car seat's  
stroller release  
mechanism, lift  
the car seat off  
the stroller frame.

## Removing Car Seat Adapters

You can fold and store the stroller with the adapters still attached.  
You **must** remove the adapters before placing your child in the stroller seat.

1

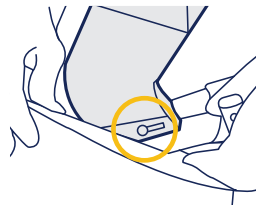

Press the release buttons on the  
car seat adapters.

2

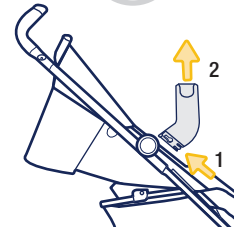

Slide the car seat adapters off of the  
attachments and then lift up to remove.

# Reclining Stroller Seat

This stroller seat has multiple recline positions.  
Adjust to a position that is comfortable for your child.

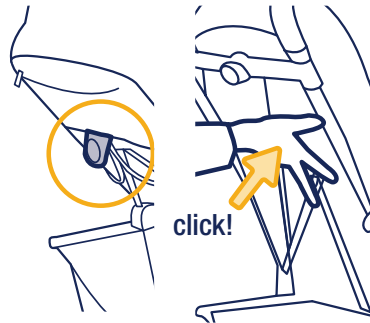

Locate the recline lever and lift it up.  
Then push the stroller seat forwards or backwards to the desired position.

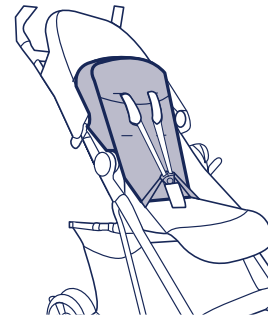
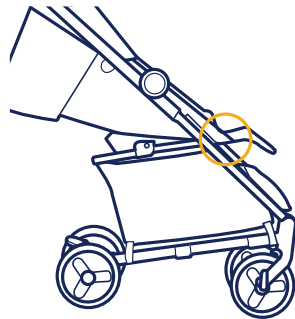

Illustration shows the stroller seat upright. However, there are multiple recline positions.

# Adjusting Footrest

This stroller seat has multiple foot rest positions.  
Adjust to a position that is comfortable for your child.



Locate the buttons on each side of the footrest.



**To raise footrest,** lift the footrest to the desired position.

**To lower footrest,** press the buttons in and lower the footrest to the desired position.

## Storage Basket & Pocket Use

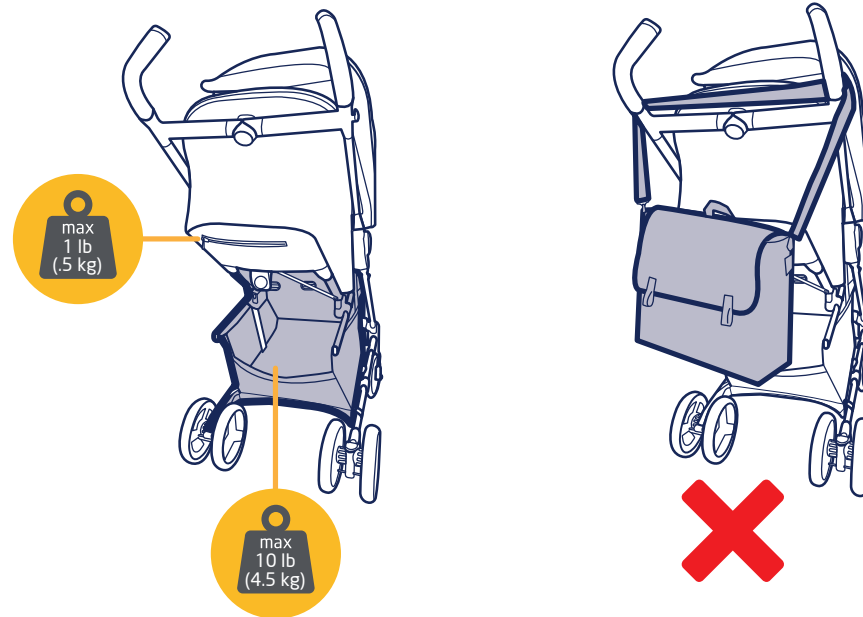

### **⚠ WARNING:**

- **NEVER** place more than 10 lb (4.5 kg) in the storage basket. If the weight is exceeded, hazardous unstable conditions may exist.
- **NEVER** place more than 1 lb (.5 kg) in the storage pocket.

# Adjusting Stroller Seat Harness Straps

As your child grows, you will need to adjust the harness strap height.

## Harness System

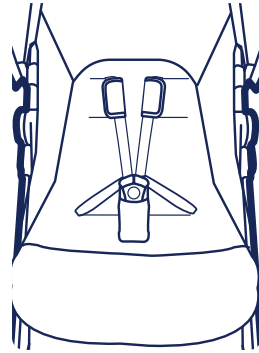

1

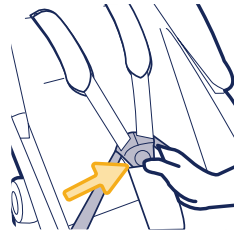

Unbuckle.

2

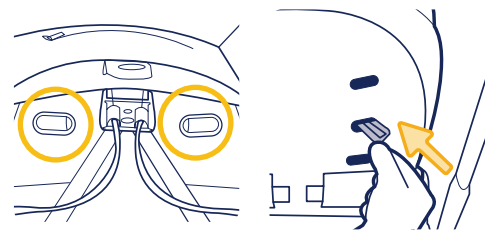

From the back of the seat, push the harness retainers through the harness slots.

3



Pull the harness strap out of the harness slot.

4



Push the harness retainers into the harness slot closest to your child's shoulders.

5



From the back of seat, pull the harness retainers through the harness slots.

## WARNING:

- Belts must be threaded exactly as shown.
- Failure to follow these instructions could result in serious injury or death of your child.

### To Shorten Harness Strap

1

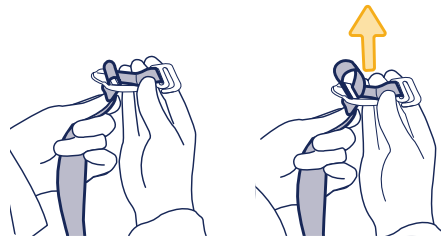

Hold the **long end** of the strap and then push it up.

2

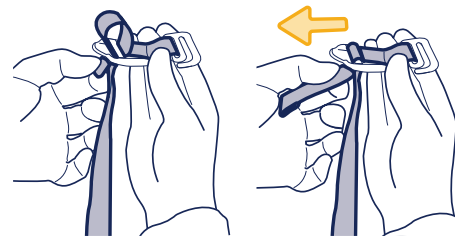

Hold the **short end** of the strap and then pull it out to tighten.

### To Lengthen Harness Strap

1

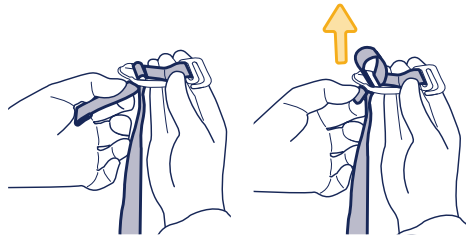

Hold the **short end** of the strap and then push it up.

2

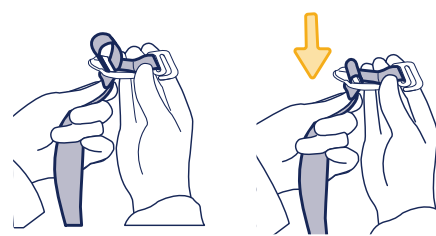

Hold the **long end** of the strap and then pull it down.

# Securing Child in Stroller Seat

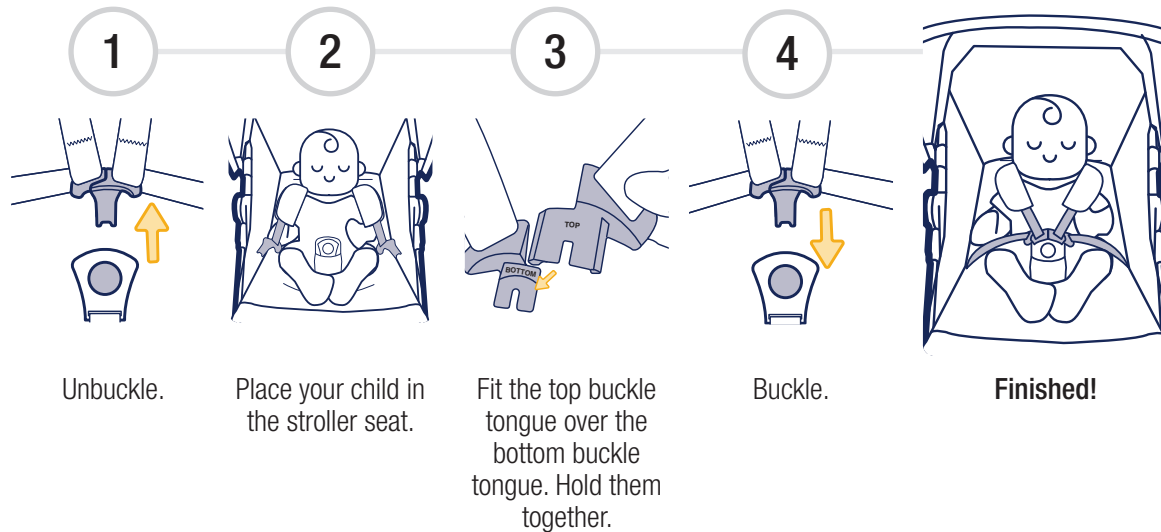

## ⚠ WARNING:

- **NEVER LEAVE CHILD UNATTENDED. ALWAYS** keep child in view when in stroller.
- **AVOID SERIOUS INJURY** from falling or sliding out. **ALWAYS** use the harness system. Check frequently to make sure it is secure.
- **ONLY** use this stroller with **ONE** child at a time.
- **STROLLER** is only for use with children up to 50 lb (22.7 kg), and **WHEN SEATED**, the midpoint of your child's head is at or below the top of the stroller seat.
- **ONLY** use this stroller with **ONE** child at a time.
- **STROLLER** is for use with children who can sit up unassisted and is **NOT** recommended for newborns.
- Failure to follow these instructions could result in serious injury or death of your child.



# Folding Stroller

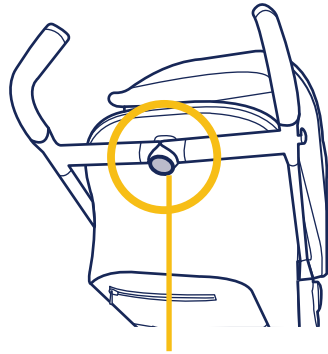

Release Button

1

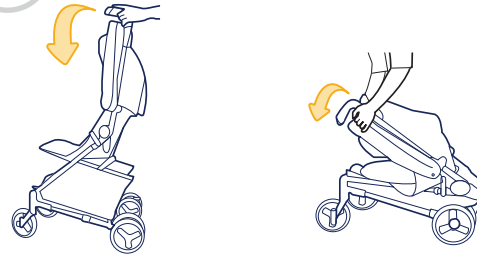

- Press the release button and pull the crossbar away from the stroller.
- With the lock and crossbar disengaged, push the top of the stroller forward until the stroller starts to fold.
- Then lower the stroller frame until it folds together.

2

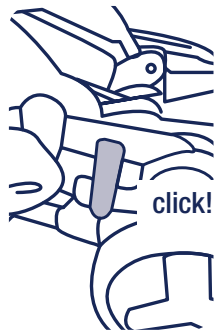

Push down on the frame so the stroller latch locks into place.

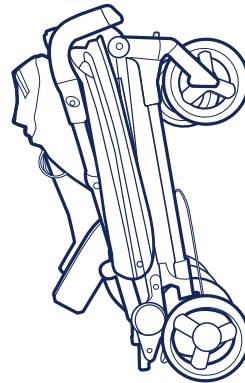

**Finished!**

The stroller is self-standing.

## **⚠ WARNING:**

**ALWAYS** keep fingers away from moving parts, when folding, unfolding, or adjusting stroller to prevent finger entrapment.

# Accessory Use & Care

## Cup Holder

Secure the cup holder to the attachment on the side of the stroller as shown. The cup holder is top-rack dishwasher safe.

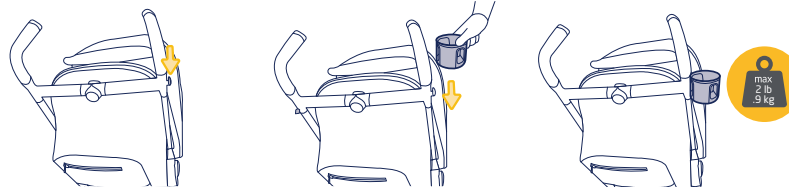

## ⚠ WARNING:

**NEVER** place more than 2 lb (.9 kg) in the cup holder.

# Wash & Care of Stroller Parts

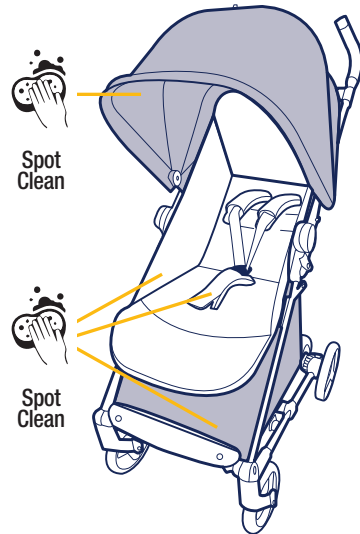

## Cleaning Harness Covers

- Machine wash separately with cold water on a gentle cycle.
- Make sure the harness covers are closed so the fastening strips are not exposed.
- Do not use bleach.
- Tumble dry separately for 10-12 minutes on low heat.
- Remove immediately.

# Dorel Juvenile Group Information

Thank you for choosing this stroller.

The DJG family is committed to creating strollers with the most comfort and convenience available today.

If you have questions or any concerns with this stroller, please contact our Consumer Care Department.

**For parts availability and questions,** please contact us via phone, text, or chat.

Include the model number and manufacture date (found on a sticker on the stroller frame) and a brief description of the part.

- Front Wheels (2)
- Harness Strap Covers (2)
- Cup Holder
- Car Seat Adapters



**Call:** 1-800-951-4113



**Text:** 1-812-652-2525



**Chat:** [www.maxicosi.com](http://www.maxicosi.com)

## Hours of Operation:

M-TH: 8:00 AM - 6:00 PM EST

FRI: 8:00 AM - 4:30 PM EST

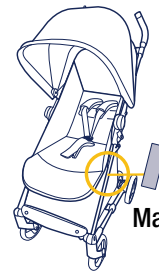

**Date of  
Manufacture Label**

## Two-Year Limited Warranty

Dorel Juvenile Group, Inc. warrants to the original purchaser that this product (Mara XT Ultra Compact Stroller), is free from material and workmanship defects when used under normal conditions for a period of two (2) years from the date of purchase. Should the product contain defects in material or workmanship Dorel Juvenile Group, Inc., will repair or replace the product, at our option, free of charge. Purchaser will be responsible for all costs associated with packaging and shipping the product to Dorel Juvenile Group Consumer Care Department at the address noted on the back of this document and all other freight or insurance costs associated with the return. Dorel Juvenile Group will bear the cost of shipping the repaired or replaced product to the purchaser. Product should be returned in its original package accompanied by a proof of purchase, either a sales receipt or other proof that the product is within the warranty period. This warranty is void if the owner repairs or modifies the product or the product has been damaged as a result of misuse. This warranty excludes any liability other than that expressly stated previously, including but not limited to, any incidental or consequential damages. SOME STATES DO NOT ALLOW THE EXCLUSION OR LIMITATION OF INCIDENTAL OR CONSEQUENTIAL DAMAGES, SO THE ABOVE LIMITATION OR EXCLUSION MAY NOT APPLY TO YOU. THIS WARRANTY GIVES YOU SPECIFIC LEGAL RIGHTS, AND YOU MAY ALSO HAVE OTHER RIGHTS THAT MAY VARY FROM STATE TO STATE.



# Mara XT

Ultra Compact Stroller

50 lb (27.7 kg)



©2021 Dorel Juvenile Group, Inc. (800) 951-4113 [www.maxicosi.com](http://www.maxicosi.com). Styles and colors may vary. Les styles et les couleurs peuvent varier. Made in China  
Fabriqué en Chine. Distributed by (distribué par) Dorel Juvenile Group, Inc., 2525 State St., Columbus, IN 47201-7494. Dorel Juvenile Canada, 2855 Argentinia  
Road, Unit 4, Mississauga, ON L5N 8G6. Importado y Distribuido en Chile por: Comercial e Industrial Silfa S.A. - San Ignacio 0201 / Parque Industrial Portezuelo  
Quilicura, Santiago Chile. Fono (562) 2339 9000. En Perú por: Comexa S.A. - Los Libertadores 455 - San Isidro, Lima - Perú. Fono (511) 4469014. En Centro  
América, Caribe y Ecuador por: Best Brands Group S.A. - Av. Balboa, Bay Mall Plaza, Planta Baja, local 9, Panamá. - Fono: (507) 300 2884. En Colombia por:  
Baby Universe S.A.S. - Vía 40 No. 77-29, Barranquilla, Colombia - Fono: (575) 353 1110 Importador: DJGM, S.A. DE C.V. Gabriel Mancera No.  
1041 Col. Del Valle, Benito Juárez C.P. 03100 México, Ciudad de México R.F.C. DJG140305GN9 Tel. (55) 67199202



3/21 4358-8155

[www.maxicosi.com](http://www.maxicosi.com)



**MAXI-COSI**<sup>®</sup>

We carry the future

## Coral XP

Infant Car Seat

**KEEP INSTRUCTIONS  
FOR FUTURE USE.**

Read all instructions  
before using this  
child restraint.



4358-7873C  
8.21.20



**⚠ Failure to follow the warnings on the labels  
and in the instruction manual can result in  
serious injury or death to your child.**

## Overview

Welcome to the Maxi-Cosi family and thank you for choosing this car seat, also known as a child restraint!

To help you get started using your child's new car seat, here are the 4 main tasks you'll need to complete:



**Measure Your Child**



**Adjust Car Seat to Fit Your Child**



**Install Car Seat into Your Vehicle**



**Snugly Secure Your Child in Car Seat**

Your child's safety is worth the time it will take for you to read and follow these instructions.

**Ready? Let's go!**

**Pages 1-5** will introduce you to the parts of the car seat.

**Page 90** has our contact information. If at any point you would like assistance, please feel free to reach out to us.

## Quick Navigation



### REAR-FACING

**4-22 lb (1.8-10 kg) and  
29 in. (73.6 cm) or less in height  
PAGE 6**



Preparing Car Seat for Child Fit **PAGES 8-10**



Checking Your Child's Fit **PAGE 11**



Securing Child in Inner Carrier **PAGES 12-15**



Install  
with  
Base



Install  
without  
Base



Lower  
Anchor Belt  
**PAGE 43**



Vehicle  
Belt  
**PAGE 49**



Vehicle  
Belt  
**PAGE 58**

## Contents

### Getting Started

Parts of Car Seat.....	1
Accessory Use.....	4
<b>Rear-Facing</b> Use Requirements.....	6
Preparing Car Seat for Child Fit.....	8
■ Checking Your Child's Fit.....	11

### ■ Securing Child in Inner Carrier ..... 12

#### Carrier Use

Changing Harness Strap Position.....	16
Outer Carrier & Base: Removing & Installing.....	19
Outer Carrier Use with Inner Carrier.....	20
Carry Handle Use.....	20
Inner Carrier & Outer Carrier: Removing & Installing.....	21
Inner Carrier Use.....	22
Crossbody Strap Use.....	22

#### Base Use

Adjusting Base.....	28
Load Leg.....	29
Release Lever for Vehicle Belt Lockoff & LATCH:	
Lower Anchor Belts.....	30
Tightness Indicators.....	32

### Choosing LATCH: Lower Anchor or Vehicle Belt

■ LATCH: Lower Anchor Use.....	33
■ Vehicle Belt Use.....	35

©2020 Dorel Juvenile. All Rights Reserved.

### Rear-Facing Use With Base ..... 41

<b>LATCH: Lower Anchor Belt</b> Install With Base.....	43
<b>Vehicle Belt</b> Install with Base.....	49

### Installing Outer Carrier to Installed Base.... 55

### Rear-Facing Use Without Base ..... 57

<b>Vehicle Belt</b> Install without Base.....	58
---	----

### Wash & Care of Car Seat Parts

Removing Harness System.....	63
Removing Seat Pad.....	66
Removing & Installing Canopy.....	69
Cleaning Parts of Car Seat.....	70
Installing Seat Pad.....	71
Installing Harness System.....	75

### Safety Information

<b>Aircraft Information</b> .....	78
<b>Replacement and Expiration</b> of Car Seat.....	79
Child Restraint Use.....	81
Installation in Vehicle.....	82
Vehicle Seating Position.....	82
Registration and Safety Notices.....	84

### Additional Information

Troubleshooting.....	86
Warranty.....	87
Replacement Parts List.....	89
Dorel Juvenile Group Information.....	90

## Parts of Car Seat

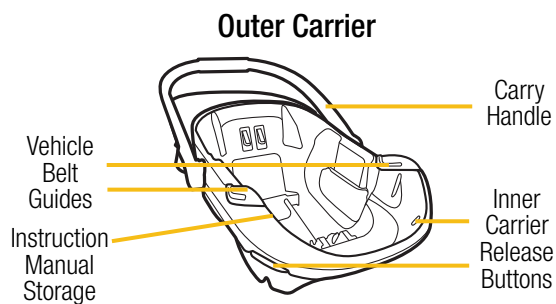
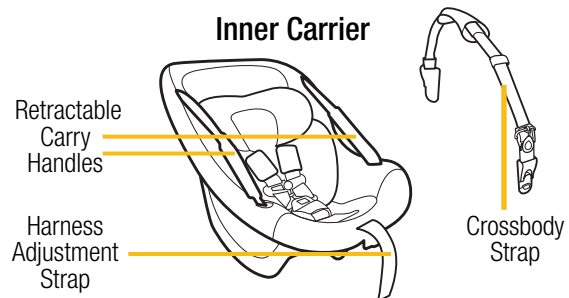

## Back of Outer Carrier

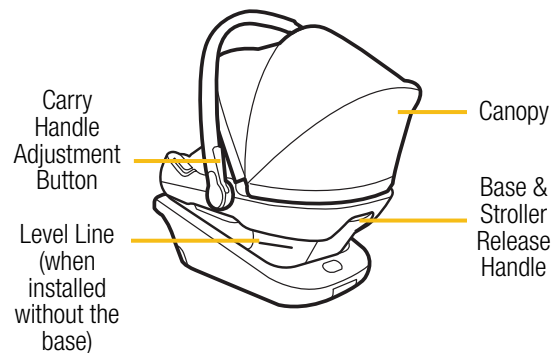

## Top & Front of Base

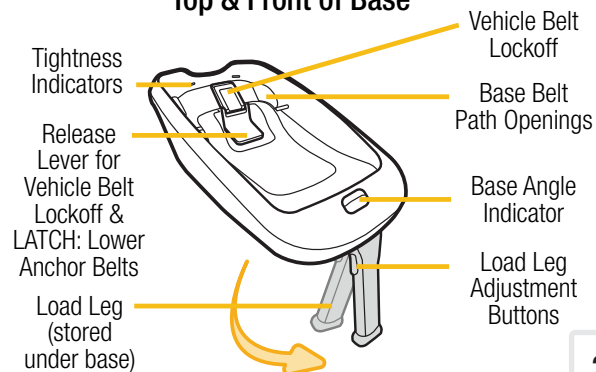



### Front of Inner Carrier

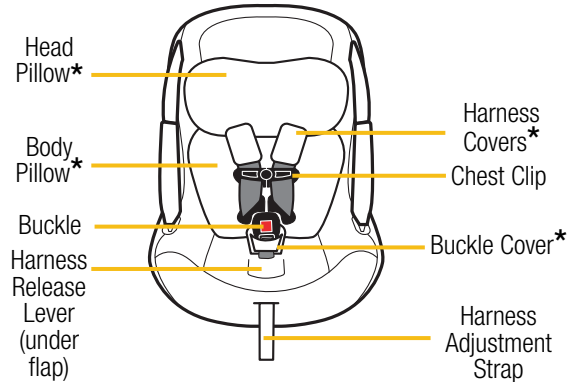

### Back of Inner Carrier

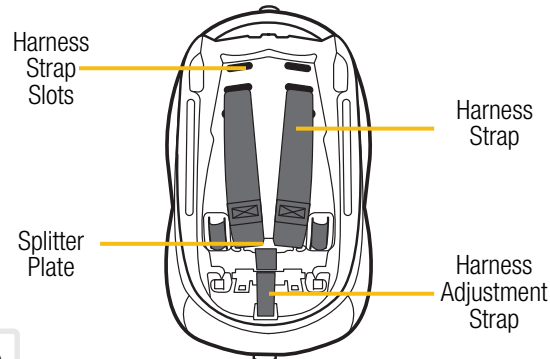

3

\*See pages 4 & 5 for Accessory Use.

## Accessory Use

For wash and care instructions, see page 70.



### Head Pillow

When using the head pillow, make sure it does not cover your infant's face in any way.

You **must use** the head pillow for children who weigh **4-8 lb** (1.8-3.6 kg).

You may remove it for bigger infants.

**To remove**, pull it off of the harness straps.



### Body Pillow

The body pillow provides comfort and helps achieve a snug harness fit.

**To learn how to check harness tightness**, see pages 16-18.

You **must use** the body pillow for children who weigh **4-8 lb** (1.8-3.6 kg).

You may remove it for bigger infants.

**To remove**, pull it out from behind the harness straps.

4

*continued on next page*



### Harness Covers

The harness covers help provide comfort to your child's neck. If the harness covers will not allow proper positioning of the chest clip or interfere with getting a tight enough harness fit, remove and **do not** use.

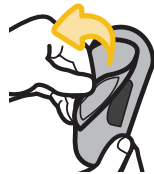

Store until your child is large enough to use the harness covers while maintaining a properly fitting harness.

**To remove,** pull the fastening strips apart and pull the harness covers off of the harness strap.

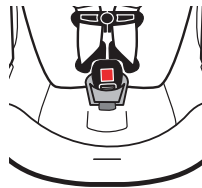

### Buckle Cover

**To remove,** pull up on the buckle cover and slide it off of the buckle and pull it out of the buckle slot in the seat pad.

## Rear-Facing Use Requirements



### Measure your child's weight and height (do not guess) before using this car seat.

Your child's height, weight, and age determine how the car seat should be placed in the vehicle.

Children vary widely in body size, shape, and temperament—**please consult your doctor before switching between any types or modes of a car seat within the limits and fit requirements of the car seat.**

### State Laws

Please be certain to follow your state's laws regarding car seat use.

### American Academy of Pediatrics Recommendations

#### Infants and Toddlers

Should ride in a rear-facing car seat as long as possible, until they reach the highest weight or height allowed by their seat.

#### Toddlers and Preschoolers

Once they are facing forward, children should use a forward-facing car seat with a harness for as long as possible, until they reach the height and weight limits for their seats.

### School-Aged Children

Once they have outgrown their forward-facing car seat, children should use a belt-positioning booster seat until the vehicle's lap and shoulder seat belt fits properly. This is often when they have reached at least 4 feet 9 inches in height and are 8 to 12 years old.

### Older Children

All children younger than 13 years should be restrained in the rear seats of vehicles for optimal protection.

**This car seat can only be used **REAR-FACING**.**

**4-22 lb (1.8-10 kg) and 29 in. (73.6 cm) or less in height**

Children under 1 year of age **must ride Rear-Facing.**

**Your child can remain in this car seat until they outgrow any one of the following:**

- **Weight Limit:** 22 lb (10 kg); **OR**
- **Height Limit:** 29 in. (73.6 cm); **OR**
- **Child Fit:** See page 11

7

## Preparing Car Seat for Child Fit

1

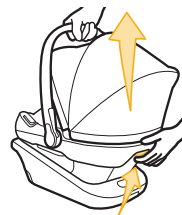

### Remove Outer Carrier From Base

- From the back of the outer carrier, slide the base release handle up.
- Then lift the outer carrier out of the base.

2



### Remove Inner Carrier from Outer Carrier

- From the front of the outer carrier, squeeze one of the inner carrier release buttons.
- Lift the inner carrier out of the outer carrier.

8

*continued on next page*

3

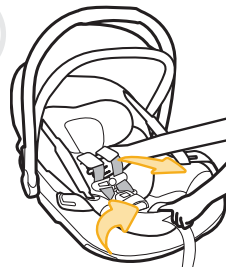

### Loosen Harness Straps

- Locate the harness release lever through the opening in the pad.
- Push and hold down the harness release lever.
- Then pull both harness straps out together as shown.

4

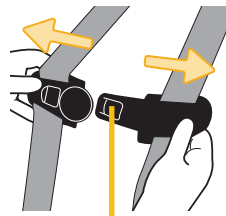

Release Button

### Release Chest Clip

- Hold each side of the chest clip.
- Press the release button with your thumb.
- Pull the chest clip apart.

5

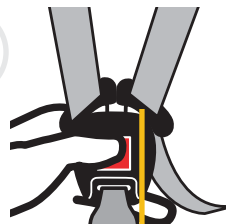

Buckle Tongue

### Unbuckle Harness

- Press the red button.
- Pull the buckle tongues out.

6



### Place Child in Inner Carrier

Your child's bottom and back should be flat against the inner carrier.

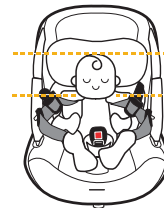

### Check for Proper Fit See page 11.



### Head and Body Pillow

You **must** use the head and body pillow for children who weigh **4-8 lb** (1.8-3.6 kg).

You may remove them for bigger infants.

**To remove**, see page 4.

9

10

## Checking Your Child's Fit

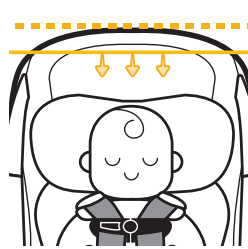

### Head Position

The top of your child's head **must be at least 1 in. (2.5 cm) below** the top of the inner carrier.

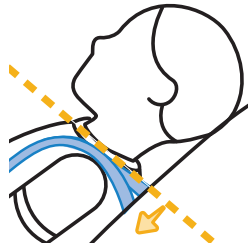

### Harness Strap Position

The harness strap **must be at or slightly below** your child's shoulders; **never above.**

### Need to make adjustments?

To change harness height, see pages 16-18.

## Securing Child in Inner Carrier

1



### Place Child in Inner Carrier

- Your child's bottom and back should be flat against the inner carrier.
- Position the harness straps over your child's shoulders and upper thighs.

2

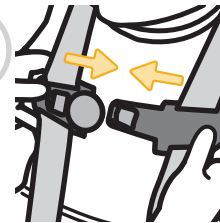

### Fasten Chest Clip

- Insert the right half of chest clip into the left half.
- Snap together.

3

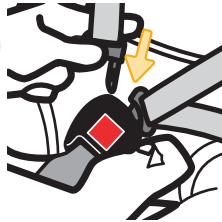

### Buckle Harness

- Push the buckle tongues into the buckle until you hear them “click”.
- Pull up on the harness straps to make sure the buckle is locked.

4

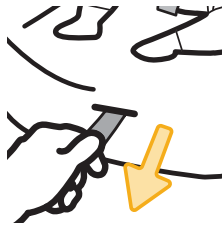

### Tighten Harness

Pull the harness adjustment strap straight out to snugly tighten the harness system.

5

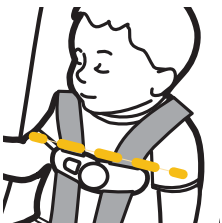

### Position Chest Clip

- Slide the chest clip up the harness straps.
- Position it mid-chest (even with armpits) and away from your child's neck.

6

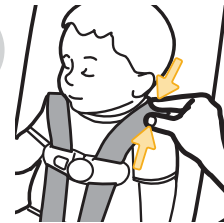

### Check Tightness

- Unfasten the harness covers.
- Try to vertically pinch the harness strap at your child's shoulder between your index finger and thumb as shown.
- If your fingers slip off, the harness system is tight enough.
- If you can pinch the harness strap, tighten more.
- Fasten the harness covers.

**A snug strap should not allow any slack.**

**It lies in a relatively straight line without sagging.**

**It does not press on the child's flesh or push the child's body into an unnatural position.**



### Finished!

Your child is now secured in the inner carrier.  
Check your child's fit often and make any needed adjustments to the inner carrier as they grow.

#### To Remove Child from Inner Carrier:

1. Loosen Harness Strap
2. Unbuckle Harness
3. Release Chest Clip
4. Remove Child



Failure to fasten and tighten the harness system correctly may allow the child to be ejected from the child restraint in a crash or sudden stop causing serious injury or death.

Do not mistake comfort for safety. The harness system must be snugly adjusted.



Do not put snowsuits or bulky garments on your child when placing them in the child restraint. Bulky clothing can prevent the harness straps from being tightened properly.

## Changing Harness Strap Position

1

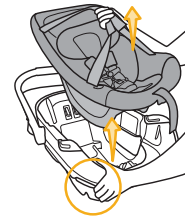

#### Remove Inner Carrier from Outer Carrier

- From the front of the outer carrier, squeeze one of the inner carrier release buttons.
- Lift the inner carrier out of the outer carrier.

2

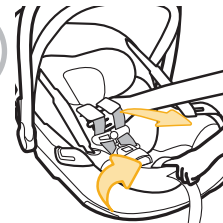

#### Loosen Harness Straps

3

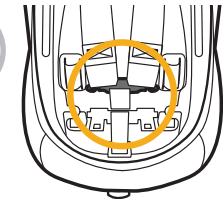

#### Turn Inner Carrier Over & Locate Splitter Plate

4

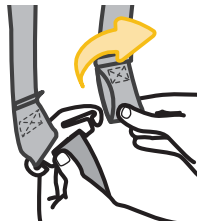

Remove Harness Strap Loops From Splitter Plate

5

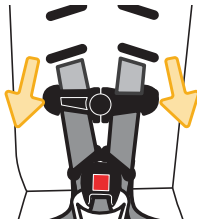

From Front of Inner Carrier, Pull Harness Straps Out of Shoulder Harness Slots

6

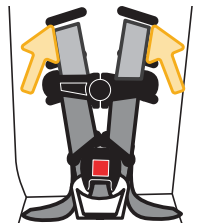

Rethread Harness Strap Into Correct Shoulder Harness Slots For Your Child

For Child Fit, see page 11.

17

7

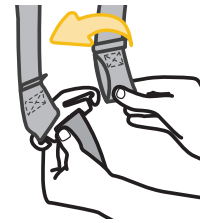

Attach Harness Strap Loops to Splitter Plate

- The sewn ends of the harness strap loops **must face** towards you.
- **Do not** twist the harness strap or the harness adjustment strap.
- Make sure the harness strap loops are fitted completely on both sides of the splitter plate.

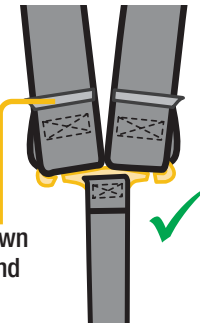

Check your child's fit often.

Check the harness straps often for any wear or damage.

**⚠** The harness system must be installed correctly. Do not use a child restraint with damaged harness straps.

18



## Outer Carrier & Base: Removing & Installing



### Removing Outer Carrier From Base

- From the back of the outer carrier, slide the base release handle up.
- Then lift the outer carrier out of the base.

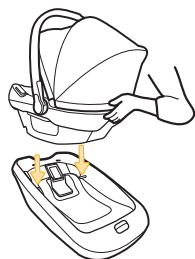

### Installing Outer Carrier to Base

- Align the slots on the sides of the outer carrier with the lock bars in the base.
- Push down firmly on the carry handle and the front of the outer carrier to lock it to the base.
- Pull up on the front two corners of the outer carrier to make sure it's locked to the base.

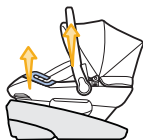

19

## Outer Carrier Use with Inner Carrier

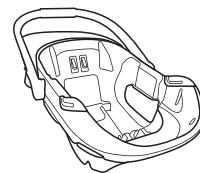

### Used For:

- Attaching to compatible strollers.
- Attaching to the base when the base is installed in the vehicle.
- Carrying with the inner carrier installed to the outer carrier.

**⚠ Never put a child in the outer carrier.**

## Carry Handle Use

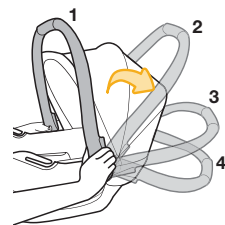

- Squeeze both buttons on the carry handle.
- Rotate the carry handle up or down to the desired location.
- Release the buttons.
- Make sure both buttons are in locked into position.



**The carry handle must be locked in position 1 when carrying and locked in position 1 or position 2 when installed in the vehicle.**

20

## Inner Carrier & Outer Carrier: Removing & Installing

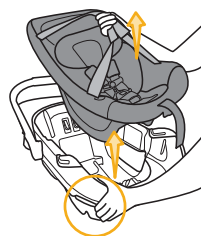

### Removing Inner Carrier from Outer Carrier

- From the front of the outer carrier, squeeze one of the inner carrier release buttons.
- Lift the inner carrier out of the outer carrier.

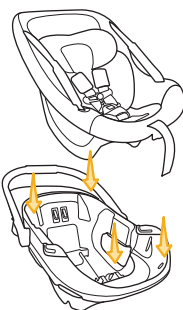

### Installing Inner Carrier to Outer Carrier

- Hold the retractable carry handles together.
- Lower the inner carrier into the outer carrier.
- Push down firmly on the inner carrier to lock it to the outer carrier.
- Pull up on the front two corners and the back of the inner carrier to make sure it's locked to the outer carrier.

21

## Inner Carrier Use

### Used For:

- Carrying when it is installed to the outer carrier or without the outer carrier.
- Attaching to the outer carrier when installed in the vehicle.
- Attaching to compatible strollers using the inner carrier stroller adapter.



Coral XP inner carrier stroller adapter is sold separately. Visit [maxicosi.com](http://maxicosi.com) for more information.

**⚠ Do not install the inner carrier in the vehicle without installing it to the outer carrier.**

## Crossbody Strap Use (optional carry mode)

### Installing Crossbody Strap

1

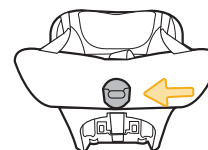

**Locate Attachment Hubs at Top and Bottom of Inner Carrier**

*continued on next page*

22

2

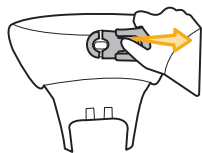

**With Your Thumb, Pull Down Locking Lever to Expand Attachment Openings**

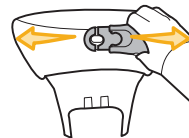

- Attach to the hubs.
- Release the locking lever to secure the strap.
- Pull on the strap to check if it is locked into place.
- Start with the Crossbody Strap in the shortest length. Once you put it on, it will be easier to lengthen. See page 25.

3



**Secure Child in Inner Carrier**

23

4



**Place Crossbody Strap Over Your Shoulder to Check For Fit**



**⚠ Always keep one hand on the inner carrier while using the Crossbody Strap.**

**Your child must always be snugly secured in the inner carrier.**

The Crossbody strap may remain attached to the inner carrier when it has been installed in the outer carrier and when the outer carrier is installed in the vehicle with or without the base.

To adjust length of the Crossbody Strap, see page 25.

24

## Adjusting Length of Crossbody Strap

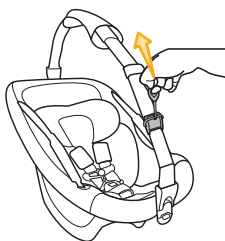

### To Shorten

- Place inner carrier on a stable flat surface.
- Locate the pull ring on the Crossbody Strap.
- Pull the ring up to shorten.



### To Lengthen

- Locate the pull ring on the Crossbody Strap.
- Pull the ring down to lengthen.

## Removing Crossbody Strap

1

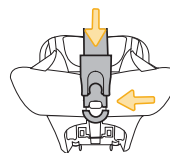

**Locate Attachment Hubs at Top and Bottom of Inner Carrier**

2

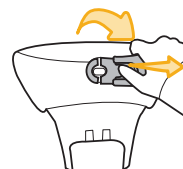

**With Your Thumb, Pull Down Locking Lever to Expand Attachment Openings**

- Remove from hubs.

Store in a safe place until ready for next use.  
For wash and care instructions, see page 70.

## WARNINGS

Read ALL instructions before using child restraint as a carrier.

**NEVER** use carrier unless child is properly secured.

Use only as a carrier by children weighing 4-22 pounds (1.8-10 kg) and 29 inches (73.6 cm) or less in height.

**NEVER** leave child unattended. Always keep child within arm's reach.

**Suffocation Hazard:** Infant carrier can roll over on soft surfaces and suffocate child. **NEVER** place carrier on beds, sofas or other soft surfaces. Keep child's face free from obstructions at all times.

**Strangulation Hazard:** Children have **STRANGLED** in loose or partially buckled harness straps. Fully restrain the child even when carrier is used outside the vehicle.

**Fall Hazard:** Child's movement can slide carrier. **NEVER** place carrier on counter tops, tables, or any other elevated surface.



The carrier can fall from the shopping cart. Do not use on shopping cart.

Leaning, bending over, or tripping can cause child to fall. Always keep one hand on the inner carrier while using the Crossbody Strap.

**NEVER** use the inner carrier as a means to transport an infant in a motor vehicle without installing it to the outer carrier.

27

Do not use the carrier if it is damaged or broken, or if any parts are missing.

## Adjusting Base

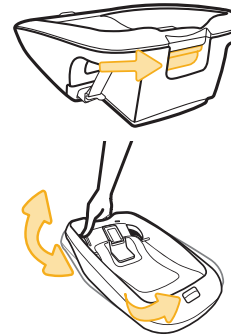

The base has multiple positions to help achieve the correct recline angle.

- The adjustment handle is at the back of the base.
- Squeeze the adjustment handle.
- Lift the back of base up.
- Then release the handle so the base foot locks into a position.
- The **horizontal** section of the angle indicator will turn **completely green** when correct. No red should be showing.

## Base Foot Positions

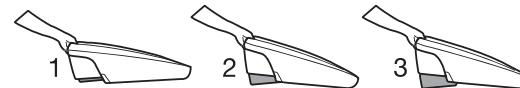

28

## Load Leg

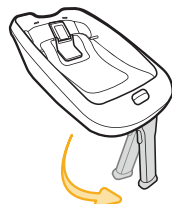

The load leg is stored under the base. This is an optional feature.

The base install is equally safe with or without the use of the load leg.

In a crash, load legs reduce downward rotation, limit rebound, provide additional stability, and energy absorption.

- Fold the load leg out.
- Squeeze the buttons on the load leg and pull it down until it meets the vehicle floor.
- Release the buttons.
- Lift the front of the base while holding the load leg in place to lock it into position.
- It **must be** perpendicular to the vehicle floor.

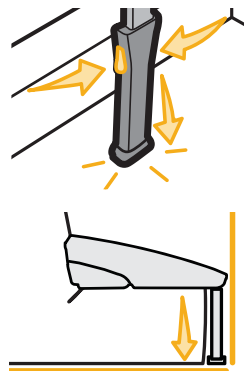

**⚠ Do not use the load leg on top of vehicle storage compartments. Review your vehicle owner's manual. Do not use the load leg if it does not reach the floor of your vehicle. When not in use, the load leg must be stored under the base.**

## Release Lever for Vehicle Belt Lockoff & LATCH: Lower Anchor Belts

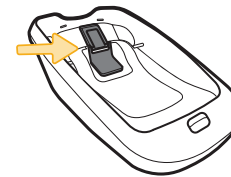

This base has a release lever that has two functions; one for LATCH: Lower Anchor and one for vehicle belts.

Lockoffs prevent the vehicle belt from loosening after tightening.

### Opening Release Lever

Lift release lever to open Lockoff and release LATCH: Lower Anchor belts.

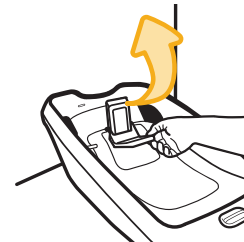

### Closing Release Lever

Push down on lever to close Lockoff and to allow the LATCH: Lower Anchor belts to retract.

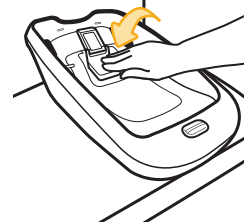

*continued on next page*

For LATCH: Lower Anchor Belt with Base Install **Page 43**



- You **must Lift the Release Lever** in order for the LATCH: Lower Anchor belts to loosen.
- You **must Push the Release Lever Down** in order for the LATCH: Lower Anchor belts to tighten.

For Vehicle Belt with Base Install **Page 49**



- You **must Lift the Release Lever** in order to thread the lap belt or the lap/shoulder belt under both the belt path guides and the Lockoff.
- You **must** tighten the vehicle belt **BEFORE Pushing the Release Lever Down** to close the Lockoff.
- The vehicle belts **must be** completely under the Lockoff.

## Tightness Indicators

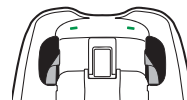

This base has indicators that show when the LATCH: Lower Anchor or vehicle belt have been securely tightened.

The red will turn **completely green** when tightened correctly. No red should be showing.

For more information about how to tighten, see the base install section you will be using:



LATCH: Lower Anchor Belt  
with Base Install  
**Page 43**



Vehicle Belt with Base Install  
**Page 49**

## LATCH: Lower Anchor Use



Your vehicle's features may be considerably different than those pictured here.

The lower anchors of **LATCH** (Lower Anchors and Tethers for **CH**ildren) is a universal system for installing car seats without using vehicle seat belts. The LATCH: lower anchor belt can **only** be used in vehicles that have the LATCH: lower anchor bars installed in designated seating positions. Most vehicles manufactured after September 2002 are equipped with LATCH: lower anchor bars. Review your vehicle owner's manual to see which seating positions may be equipped with LATCH: lower anchor bars.

**⚠ Do not use both the lower anchor belt and vehicle belt at the same time. When used correctly the LATCH: lower anchor belt or the vehicle belts are equally safe.**

33

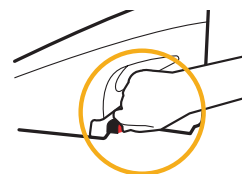

### Removing Connectors from Storage Location

- Press in red button. Push connector into storage location.
- Then pull it and the belt out.

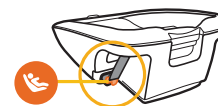
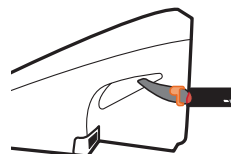

### Storing Lower Anchor Belt

**When using the vehicle belt to install or when the base is not installed in a vehicle, attach the connectors to the attachments in the base as shown.**

### Removing Lower Anchor Belt from Vehicle Anchor Bars

Press the red release button on each connector, then pull the connectors out of the vehicle seat.



34



## Vehicle Belt Use

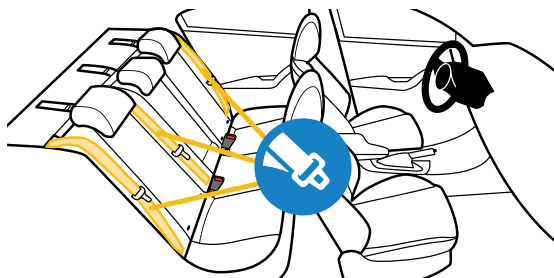

Your vehicle's features may be considerably different than those pictured here.

If LATCH: lower anchors are not an option, you **must** use the vehicle seat belt system to install the car seat.

**Not all vehicle belts and seating positions will work with car seats.**

Please go through the steps on the next page to understand how to lock a car seat with a vehicle belt.

**⚠ Do not use both the LATCH: lower anchor belt and vehicle belt at the same time. When used correctly the lower anchor belt or the vehicle belts are equally safe.**

35

1



### You Must Review Your Vehicle Owner's Manual

Your vehicle owner's manual will let you know which vehicle belts and seating positions car seats can be installed in.

2



### Check How This Car Seat Will Be Locked Into Place

The vehicle belt **must not** loosen after tightening. There needs to be a way to lock the vehicle belt.

#### The ways to lock a vehicle belt are:

- By using this base's Lockoff, see step 3; **OR**
- By using the seat belt's retractor, see step 4; **OR**
- By using the seat belt's latch plate, see step 5.

36

*continued on next page*

3

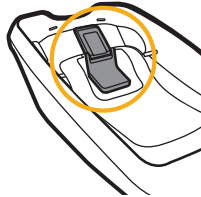

### Lockoff

When used correctly, this base's Lockoff will lock the vehicle belt.

Please go to the vehicle belt with base installation section of the manual to see how to properly use this feature.

Vehicle Belt with Base Install | Page 49

If you will be installing without the base, you **must** lock the vehicle belt using the retractor or the latch plate; continue to step 4.

4

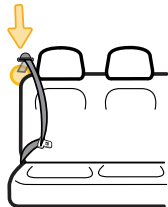

### Check Retractor

Retractors pull seat belts into stored positions and lock the belt to hold passengers in place.

See the next page for some common types of vehicle belt retractors that will work with this car seat.

37

## Types of Retractors

**Switchable Retractor**  
(most vehicles have this type)



This retractor can be switched to a locking mode.

You **must have the retractor in the locking mode** to use the seat belt with this car seat.

**Switching to locking mode:** Slowly pull the shoulder belt all the way out, then let it go back in **1-2 in.** (2.5-5 cm).

As it goes back in, you will most likely hear a ratcheting sound.

Gently pull the belt to see if it has locked. You will not be able to pull any more belt out if the lock has engaged.

**Automatic Locking Retractor**



This retractor always locks.

It will automatically lock after slowly pulling the seat belt out at least halfway and letting the belt go back into the retractor **1-2 in.** (2.5-5 cm).

38

*continued on next page*

## Emergency Locking Retractor

See Step 5, "Check Latch Plates".

If the retractor does not lock, it is most likely an Emergency Locking Retractor. These retractors only lock during a sudden stop or collision.

You will need to determine if your seat belt's latch plate can lock the belt. See step 5, "Check Latch Plates".

5



### Check Latch Plates

Latch plates are the part of the seat belt that goes into the buckle.

#### To see if the latch plate locks:

1. Buckle Vehicle Belt
2. Firmly Tug Lap Portion of Seat Belt While Pulling It Up

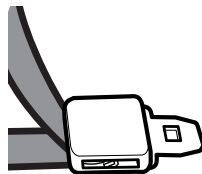

Locking Latch Plate

If the vehicle belt does not slide through the latch plate, it's locked.

39

If the latch plate slides up and down the vehicle belt, it is a **sliding latch plate**.

Sliding latch plates easily slip between the lap and shoulder portions of the belt.

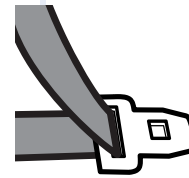

Emergency Locking Retractor with a Sliding Latch Plate

**If you have an Emergency Locking Retractor with a Sliding Latch Plate, you must use a locking clip.**

Please contact us for one, see page 89.

### Never Use With This Car Seat

Emergency Locking Retractor Lap Only Belt



Inflatable Seat Belts



40

## Rear-Facing Use with Base

**4-22 lb (1.8-10 kg) and  
29 in. (73.6 cm) or less in height**



Lap/Shoulder Belt



Lap Belt



LATCH: Lower  
Anchor Belt



Never install a rear-facing child restraint in the front seat of a vehicle equipped with an active frontal airbag.

Check the vehicle belt or the LATCH: lower anchor belt before each use. Use only if the belt can be tightened properly and locked securely in place.

Do not fasten multiple LATCH: lower anchor connectors on the same LATCH: lower anchor bar in the vehicle.

Child restraint must be securely attached to base.

Do not use the load leg on top of vehicle storage compartments. Review your vehicle owner's manual.

Do not use the load leg if it does not reach the floor of your vehicle.

Do not refer to the level line on the shell when installing with the base.

This child restraint must always face the rear of the vehicle.

Failure to follow these warnings can result in serious injury or death.

## LATCH: Lower Anchor Belt Install with Base

Before you begin installing the base into your vehicle, did you check:

Your child's weight and height? See page 7.

Your child's fit? See page 11.

1



### Unfold Load Leg

This is an optional feature.

In a crash, load legs reduce downward rotation, limit rebound, provide additional stability, and energy absorption.

 **Do not** fully extend yet.

 **Do not** use the load leg to adjust the base angle.

Review your vehicle owner's manual for load leg use.

43

2

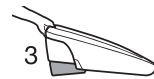
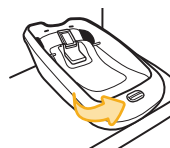

### Check Base Angle

The angle indicator will turn **completely green** when correct. No red should be showing.

### Adjusting the Base

If the angle indicator is not correct, adjust the base foot.

There are 3 positions.

- The adjustment handle is at the back of the base.
- Squeeze the adjustment handle to release the base foot.
- Then release the handle so the base foot locks into one of the positions.

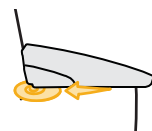

**NOTE:** Only if necessary, you may need to place a tightly rolled towel(s) or foam pool noodle(s) under the back of the base to help get the correct angle. Check the padding often to make sure it is still in place.

44

*continued on next page*

3



### Lift Release Lever

You must **Lift the Release Lever** in order for the LATCH: Lower Anchor belts to loosen.

4

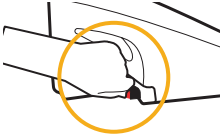

### Release LATCH: Lower Anchor Connectors from Storage Location

- Press in red button. Push connector into storage location.
- Then pull it and the belt out.

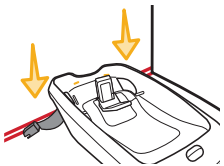
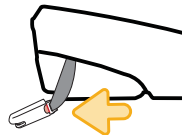

### Attach Connectors to Vehicle Anchors

Review your vehicle owner's manual for LATCH: lower anchor locations and LATCH: lower anchor use.



5



### Push Release Lever Down

You must **Push the Release Lever Down** in order for the LATCH: Lower Anchor belts to tighten.

6

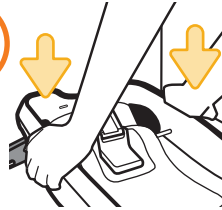

### Push Down on Base to Tighten LATCH: Lower Anchor Belts

The belts will begin to automatically retract and tighten as you push down.



### Check Tightness Indicators

The red will turn **completely green** when tightened correctly. No red should be showing.



You may need to **adjust the base foot** into another position for the tension indicators to turn completely green. See **step 2**.

**You can also check the tightness by:**

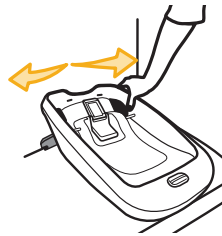

- Holding the base **ONLY at the belt path** with your non-dominant hand.
- Pushing and pulling from side to side.
- The base should not move more than **1 in. (2.5 cm)**.

**If it moves more than 1 in. (2.5 cm), you can try:**

- Pushing down on the base more; **OR**
- Reinstalling the base; **OR**
- Changing to a different seating location; **OR**
- Switching to vehicle belt installation

7

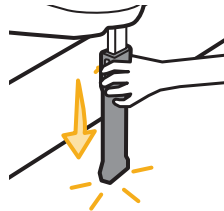

**Extend Load Leg**

- Squeeze the buttons on the load leg and pull it down until it meets the vehicle floor.
- Release the buttons.

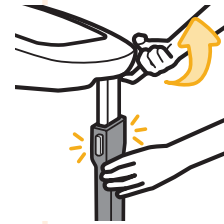

- Lift the front of the base while holding the load leg in place as shown to lock it into position.
- It **must be** perpendicular to the vehicle floor.

**⚠ Do not** use the load leg if it does not reach the floor of your vehicle.

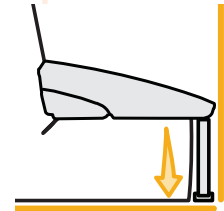

**⚠ Do not** use the load leg on top of vehicle storage compartments.

Review your vehicle owner's manual.

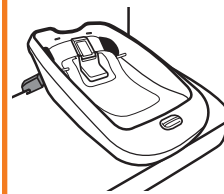

**LATCH: Lower Anchor Belt with Base Install Finished!**

**To install the outer carrier to the base, see page 55.**

Check the tightness of the install often to make sure it has not loosened.

## Vehicle Belt Install with Base

Before you begin installing the base into your vehicle, did you check:

Your child's weight and height? See page 7.

Your child's fit? See page 11.

1



### Unfold Load Leg

This is an optional feature.

In a crash, load legs reduce downward rotation, limit rebound, provide additional stability, and energy absorption.

 **Do not** fully extend yet.

 **Do not** use the load leg to adjust the base angle.

Review your vehicle owner's manual for load leg use.

49

2

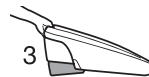
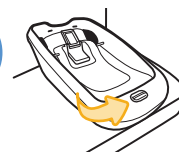

### Check Base Angle

The angle indicator will turn **completely green** when correct. No red should be showing.

### Adjusting the Base

If the angle indicator is not correct, adjust the base foot.

There are 3 positions.

- The adjustment handle is at the back of the base.
- Squeeze the adjustment handle to release the base foot.
- Then release the handle so the base foot locks into one of the positions.

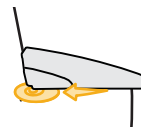

**NOTE:** Only if necessary, you may need to place a tightly rolled towel(s) or foam pool noodle(s) under the back of the base to help get the correct angle. Check the padding often to make sure it is still in place.

50

*continued on next page*



3

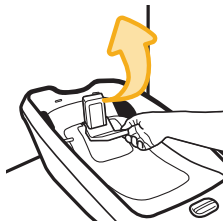

Lift Release Lever



**Check if Your Vehicle Belts Will Work With This Car Seat**



Review pages 35-40 and your vehicle owner's manual to find out what kind of vehicle belts you have.

4

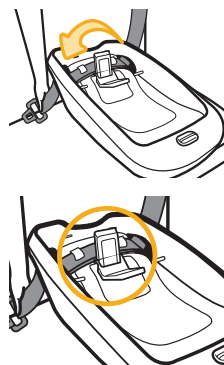

**Route Belt Through Belt Path Openings As Shown**

The lap belt or the lap/shoulder belt both go **completely under** the belt path guides and the Lockoff as shown.

Buckle the vehicle belt.

51

5

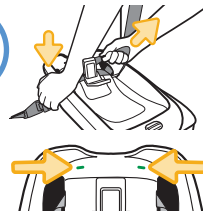

**Push Down on Base While Tightening Belt**

You **must** tighten the vehicle belt **BEFORE** closing the Lockoff.



**Check Tightness Indicators**

The red will turn **completely green** when tightened correctly. No red should be showing.

You may need to **adjust the base foot** into another position for the tension indicators to turn completely green. See **step 2**.

6

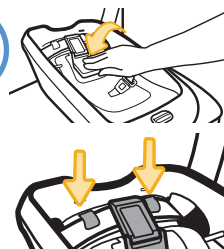

**Push Release Lever Down**

The lap belt or the lap/shoulder belt both go **completely under** the belt path guides and the Lockoff as shown.

**After the base has been installed**, if your car has a switchable retractor, you may also use it to lock the belt. **If the Lockoff cannot be used properly**, then do not install the base using vehicle belt installation. See page 43 for UAS install.

52

*continued on next page*

### You can also check the tightness by:

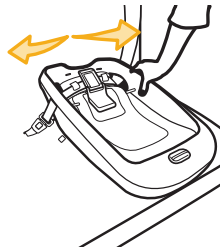

- Holding the base **ONLY at the belt path** with your non-dominant hand.
- Pushing and pulling from side to side.
- The base should not move more than **1 in. (2.5 cm)**.

### If it moves more than 1 in. (2.5 cm), you can try:

- Tightening the belt more; **OR**
- Reinstalling the base; **OR**
- Changing to a different seating location; **OR**
- Switching to LATCH: Lower Anchor belt installation

7

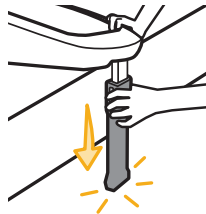

### Extend Load Leg

- Squeeze the buttons on the load leg and pull it down until it meets the floor of the vehicle.
- Release the buttons.

53

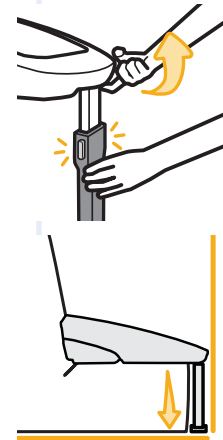

- Lift the front of the base while holding the load leg in place as shown to lock it into position.
- It **must be** perpendicular to the vehicle floor.

**⚠ Do not** use the load leg if it does not reach the floor of your vehicle.

**⚠ Do not** use the load leg on top of vehicle storage compartments.

Review your vehicle owner's manual.

## Vehicle Belt with Base Install Finished!

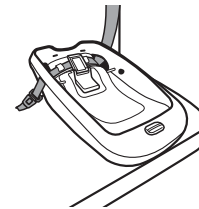

To attach the outer carrier to the base, see page 55.

Check the tightness of the install often to make sure it has not loosened.

54

## Installing Outer Carrier to Installed Base

Illustrations show the base installed with the LATCH: Lower Anchor belt; however, the same steps apply for a vehicle belt install.

1

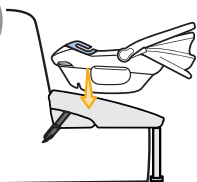

### Install Outer Carrier to Base

Pull up on the front two corners and the back of the outer carrier to make sure it's locked to the base.

2



### Secure Child in Inner Carrier

To properly secure your child in the inner carrier, see pages 12-15.

3



### Install Inner Carrier to Outer Carrier

Pull up on the front two corners and the back of the inner carrier to make sure it's locked to the outer carrier.

55

4



**Carry Handle Must Be Locked and in Position 1 or Position 2**

5

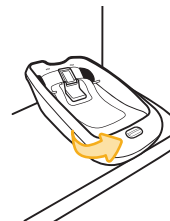

### Recheck Angle Indicator on Base

Redo the base installation if the angle indicator is not correct.

LATCH: Lower Anchor Belt Base Install | Page 43  
Vehicle Belt Base Install | Page 49

### LATCH: Lower Anchor Belt Install



### Vehicle Belt Install



56

## Rear-Facing Use Without Base

4-22 lb (1.8-10 kg) and  
29 in. (73.6 cm) or less in height

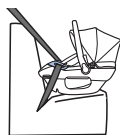

Lap/Shoulder Belt



Lap Belt



Never install a rear-facing child restraint in the front seat of a vehicle equipped with an active frontal airbag.

Check the vehicle belt before each use. Use only if the belt can be tightened properly and locked securely in place.

This child restraint must always face the rear of the vehicle.

57

Failure to follow these warnings can result in serious injury or death.

## Vehicle Belt Install Without Base

Before you begin installing the seat into your vehicle, did you check:

Your child's weight and height? See page 7.

Your child's fit? See page 11.

1



### Secure Child in Inner Carrier

To properly secure your child in the inner carrier, see pages 12-15.

2

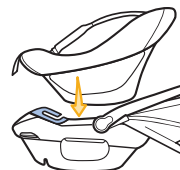

### Install Inner Carrier to Outer Carrier

Pull up on the front two corners and the back of the inner carrier to make sure it's locked to the outer carrier.

*continued on next page*

58

3

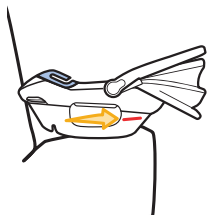

### Place Outer Carrier into Vehicle Rear-Facing

#### Check Level Line

The level line on the side of shell must be parallel with the ground.



**NOTE:** Only if necessary, you may need to place a tightly rolled towel(s) or foam pool noodle(s) under the front of the outer carrier to help get the correct angle.

Check the padding often to make sure it is still in place.



#### Check if Your Vehicle Belts Will Work With This Car Seat



Review pages 35-40 and your vehicle owner's manual to find out what kind of vehicle belts you have.

4

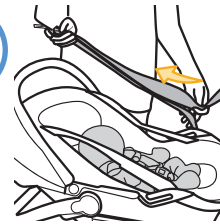

### Route Vehicle Lap or Lap/Shoulder Belt Through Belt Guides on Both Sides of Shell

Buckle the vehicle belt.

If your car's vehicle belt has a switchable retractor, use it to lock the vehicle belt.

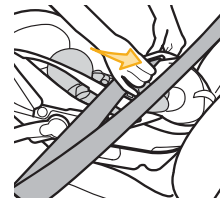

For information about switchable retractors, see page 38 or review your vehicle owner's manual.

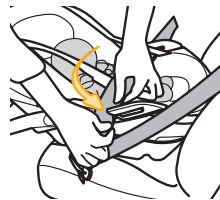

5

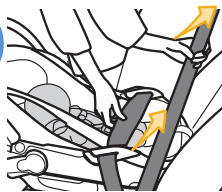

### Tighten Belt

Pull the shoulder belt or the free end of the lap belt to tighten.

6

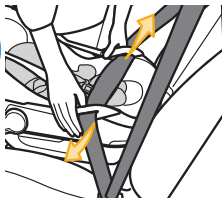

### Check Belt Tightness

- Hold the car seat **ONLY at the belt path** with your non-dominant hand.
- Push and pull from side to side.
- It should not move more than **1 in. (2.5 cm)**.

If it moves more than 1 in. (2.5 cm), you can try:

- Pulling the belt tighter; **OR**
- Reinstalling the car seat; **OR**
- Changing to a different seating location

61

7

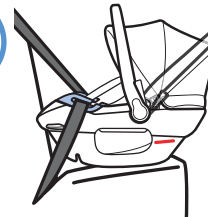

### Recheck Level Line

Redo the installation if level line is not parallel with the ground.

8

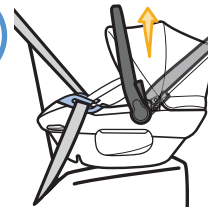

Carry Handle Must Be Locked and in Position 1 or Position 2

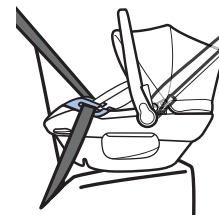

### Vehicle Belt Install without Base Finished!

Check the tightness of the install often to make sure it has not loosened.

62

## Removing Harness System

You must partially remove the harness system in order to remove the pad.

To remove accessories, see pages 4-5.

1



Remove Inner Carrier from Outer Carrier

2

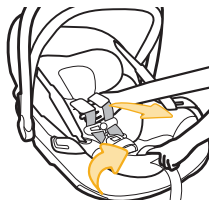

Loosen Harness Straps

3

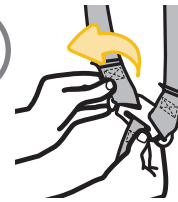

Turn Inner Carrier Over and Remove Harness Strap Loops From Splitter Plate

4

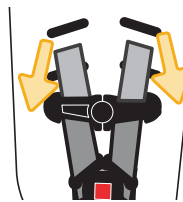

From Front of Inner Carrier, Pull Harness Straps Out of Shoulder Harness Slots

5

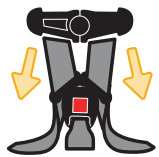

**Unthread Chest Clip**

6



**Unthread Buckle**  
Do not unbuckle.  
The buckle cannot be removed from the inner carrier.



**You Do Not Need to Completely Remove Harness Strap from Inner Carrier to Remove Pad**

## Removing Seat Pad

You must partially remove the harness system in order to remove the pad. See pages 63-65.

1

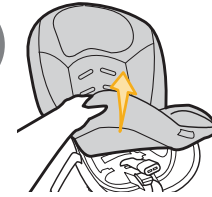

**Pull Seat Pad off of Bottom of Inner Carrier**

Pull harness adjustment strap, harness strap, and buckle through the slots in the pad.

2

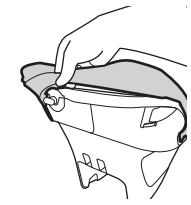

**Pull Seat Pad off of Top and Sides of Inner Carrier**

3

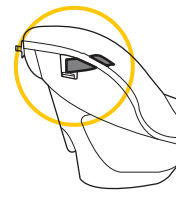

**Locate Retractable Carry Handles' Metal Retainers**

*continued on next page*



4

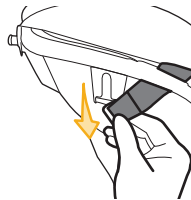

Pull Metal Retainers  
Down and Out of  
Slot in Inner Carrier

5



Pull Metal Retainers  
Out of Slot in Shell

6

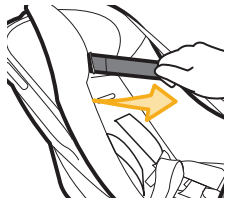

Pull Retractable  
Carry Handle Out of  
Seat Pad Slot

7



Pull Seat Pad  
Around and Off of  
Retractable Carry  
Handle Guide

8

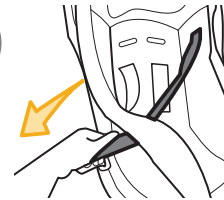

Pull Retractable  
Carry Handles Out  
of Pad

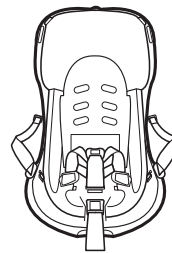

Finished!

## Removing & Installing Canopy

### Removing Canopy

1

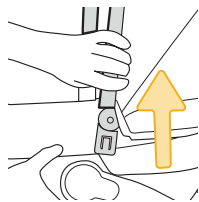

**Pull Canopy Hub  
Off of Outer Carrier**

For wash and care instructions, see page 70.

### Installing Canopy

1

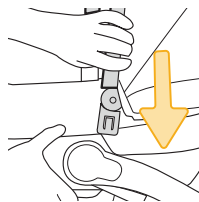

**Attach Canopy Hubs  
to Outer Carrier**

2

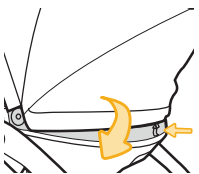

**Pull Canopy Over  
Back of Outer Carrier  
Over Edge**

69

## Cleaning Parts of Car Seat

### Cleaning Seat Pad, Head & Body Pillows, & Buckle & Harness Covers

Machine wash separately with cold water on a gentle cycle. Make sure the harness covers are closed so the fastening strips are not exposed. Do not use bleach. Tumble dry separately for 10-12 minutes on low heat. Remove immediately.

### Cleaning Canopy

Spot clean using warm sudsy water and damp cloth. Line dry.

### Cleaning Harness Strap

**Check the harness straps often for any wear or damage.**

Spot clean using warm sudsy water and damp cloth. Spilled food and liquids on the car seat may result in mold or bacterial growth over time. These spills could also attract insects or rodents.

### Cleaning Buckle, Crossbody Strap, & Inner and Outer Carriers

Spot clean using warm sudsy water and damp cloth. Do not submerge into water.

**⚠ Do not use the child restraint without the seat pad or with damaged harness straps.**

70

## Installing Seat Pad

1



Pull Harness Straps Through Slots in Seat Pad

2



Pull Buckle Through Buckle Slot in Seat Pad

3

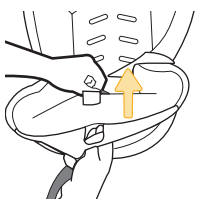

Pull Harness Adjustment Strap Through Slot in Seat Pad

71

4

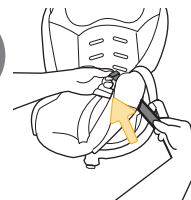

Pull Carry Handles Through Slots in Seat Pad

5



Push Top of Retractable Carry Handles Through Slots at Top & Sides of Seat Pad

**Do not** twist the retractable carry handles.

72

*continued on next page*

6

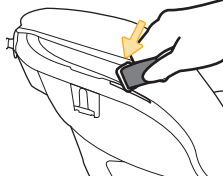

Push Retractable Carry Handles' Metal Retainers Down Through Slots in Inner Carrier

7

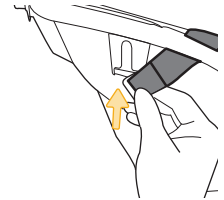

Push Retractable Carry Handles' Metal Retainers Up into Slots in Inner Carrier

8

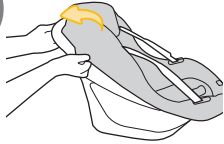

Pull Seat Pad Around Top of Inner Carrier

9

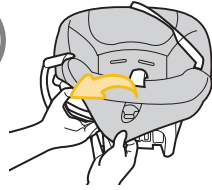

Pull Seat Pad Down Around Bottom of Inner Carrier & Around Carry Handle Guide

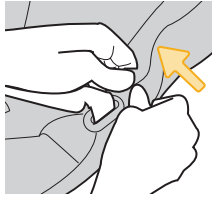

To install accessories, see pages 4-5.

## Installing Harness System

If you have not removed the harness strap completely from the inner carrier, skip to step 4.



### 1 Thread Harness Strap

With the sewn end of the harness strap loop facing the buckle, thread the harness strap down through the hip harness slot.

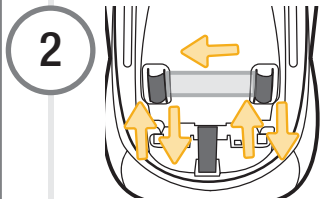

2 Lift Up Front of Pad and Weave Harness Strap In and Out of Shell As Shown

75

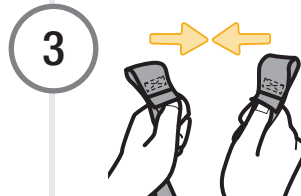

### 3 Make Harness Strap Even

The sewn ends of the harness strap loops **must** face each other.

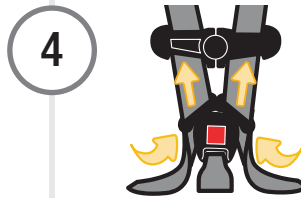

### 4 Thread Buckle and Chest Clip

The harness strap ends go through the **back** of the buckle tongues. Then they go through the chest clip **front to back** as shown.

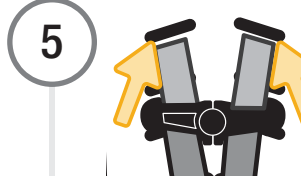

5 Rethread Harness Strap Into Correct Shoulder Harness Slots For Your Child

76

*continued on next page*

6

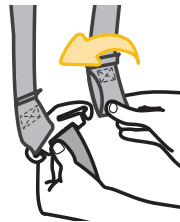

### Attach Harness Strap Loops to Splitter Plate

- The sewn ends of the harness strap loops **must face** towards you.
- **Do not** twist the harness strap or the harness adjustment strap.
- Make sure the harness strap loops are fitted completely on both sides of the splitter plate.

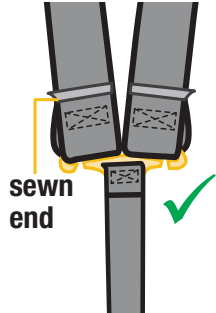

Check your child's fit often.  
Check the harness straps often for any wear or damage.

77

 The harness system must be installed correctly. Do not use a child restraint with damaged harness straps.

## Aircraft

This restraint is certified for aircraft use.

Install the car seat in a window seat to avoid blocking the aisle. If the aircraft lap belt is too short, ask the flight attendant for a belt extender.

Use only on forward-facing aircraft seats.

Contact the airline for their specific policies.

Some airlines may ask to see a label stating that this car seat is certified for aircraft use.

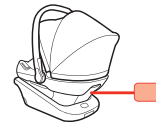

There is an airplane certification label located on the back of the outer carrier as shown.



### Rear-Facing Aircraft Installation without Base

Follow pages 58-62.

**You can only install this car seat in the aircraft without the base.**

78

## Replacement & Expiration of Car Seat

### Do not risk your child's safety.

To keep your child as safe as possible, Dorel Juvenile Group strongly recommends replacing the car seat even after a minor crash; even if it was not occupied at the time.

### Replacement After a Minor Crash

The National Highway Traffic Safety Administration states that for a crash to be considered minor

#### **ALL of the following must be true:**

- Vehicle able to drive away from the crash site; **AND**
- Vehicle door nearest the car seat was not damaged; **AND**
- No passengers were injured; **AND**
- Airbags did not deploy; **AND**
- There is no visible damage to the car seat.

If the crash your car seat was involved in meets **ALL** the criteria, you may not need to replace the car seat.

If one or more of these criteria are not true or if you are uncertain of any of your answers, replace the car seat immediately.

79

## Replacement After a Moderate to Severe Crash

You **must** replace this car seat if it has been in a moderate to severe car crash.

This car seat is intended to protect a child in a single crash.

During a crash, the car seat and all of its parts absorb crash energy which can deform or weaken it. Damage is not always visible. A damaged car seat must be replaced immediately.

### Expiration

On the back of the outer carrier there is a date of manufacture label as shown.

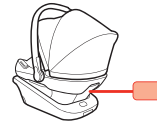

Do not use this car seat more than 8 years after the date of manufacture.

80

## Child Restraint Use

Never take your child out of the child restraint while the vehicle is moving.

Never leave child unattended.

Placing your child in a hot child restraint may result in burns.

Do not use a child restraint with damaged or missing parts.

Do not use a child restraint with cut, frayed, or damaged harnesses.

Do not substitute parts or try to modify the child restraint in any way.

Do not lubricate buckles and fasteners.

Do not use any child restraint accessory except those approved by Dorel Juvenile Group.

Never allow any child to play with this child restraint; it is not a toy.

Do not remove or cover up any of the warning labels or other labels on the child restraint.

This child restraint has been certified for use in passenger vehicles. Do not use in a boat, on a motorcycle or in a cargo van or bus where there are no seat belts.

Read all instructions for additional warnings.

## Installation in Vehicle

Check the vehicle belt or LATCH: lower anchor belt before each use. Use only if the belt can be tightened properly and locked securely in place.

Even when unoccupied, this child restraint must be firmly secured to the vehicle with a lower anchor belt or with the vehicle seat belt.

In a crash or sudden stop, an unsecured child restraint could injure occupants.

## Vehicle Seating Position



Never place a child rear-facing in a seating position with an active frontal air bag.

Check the vehicle owner's manual for more information about air bag/child restraint use.



Use the child restraint only on vehicle seats that face forward.



Do not use on seats that face the sides or rear of the vehicle.

For vehicles without a back seat, refer to your vehicle owner's manual.





Children are safer when properly restrained in rear seating positions than in the front seating positions.

According to accident statistics, children in rear seating positions are statistically safer, whether you have air bags, advanced air bags, or no air bags at all.

If you are not sure where to place the car seat in your vehicle:

- Consult your vehicle owner's manual, **OR**;
- Contact Dorel Juvenile Group Consumer Care Department, **OR**;
- Visit your local Child Passenger Inspection Station. Go to <http://www.safercar.gov/cpsApp/cps/index.htm> to find your closest station.

**To avoid your child being seriously burned, take the following precautions:**

- Park in the shade or where sun does not directly hit the car seat.
- Cover the car seat with a sheet or blanket when not in use.
- Check for hot seat and buckles before placing child in car seat.

To help protect your vehicle seat's upholstery from damage, use a single layer towel underneath and behind car seat.

## Registration and Safety Notices

Please complete the postage-paid registration card that came with your child restraint, and send it to us.

Child restraints could be recalled for safety reasons. You must register this restraint to be reached in a recall. Send your name, address, e-mail address if available and the restraint's model number and manufacturing date to:

**Dorel Juvenile Group, Inc.**

2525 State Street  
Columbus, IN 47201

or call 1-800-951-4113 or register online at:  
[www.djgusa.com/registration/carseat/us](http://www.djgusa.com/registration/carseat/us).

For recall information, call the U.S. Government's Vehicle Safety Hotline at 1-888-327-4236 (TTY: 1-800-424-9153), or go to <http://www.NHTSA.gov>.

### Example of model number, line code, and manufacture date.

**Consumer:** Just fill in your name, address and email. Please print (use dark ink).

Your Name \_\_\_\_\_

Your Street Address \_\_\_\_\_

City \_\_\_\_\_ State \_\_\_\_\_ Zip Code \_\_\_\_\_

Email Address (optional) \_\_\_\_\_

Model Number ABC123CDE	Model Name BRAND & CAR SEAT NAME	Manufacture Date 05/16/2020
---------------------------	-------------------------------------	--------------------------------

Barcode: [Barcode]

L#11 B265035

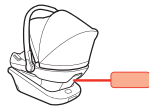

If you don't have the card or if your address changes, you will find the model number, manufacture date, and line code on the label located on the back of the outer carrier.

## Troubleshooting

### 1. If the car seat's buckle or harness release lever sticks or you cannot get the straps tight enough around your child:

**Do not lubricate.** Check around the harness release lever for dropped food, sticky spilled drinks, dirt, leaves, etc. Clean with warm water and/or remove the object with tweezers. If you cannot get the harness to adjust and remain snugly tight while the buckle is securely locked, **do not** use this car seat.

### 2. If your harness twists:

Straighten the harness each time you put your child in the car seat to help prevent twisting. Lock the buckle and tighten the harness so it will be ready for next use.

## Warranty

Dorel Juvenile Group, Inc. (DJG) warrants this product to the original retail purchaser as follows: This product is warranted against defective materials or workmanship for one year from the date of original purchase. **An original receipt is required to validate your warranty.** DJG will, at its option, provide replacement parts or replace this product. DJG reserves the right to substitute if the part or model has been discontinued.

To make a claim under this warranty contact our Consumer Care Department by phone at 1-800-951-4113; or text us at 1-812-652-2525. Our hours of operation are from 8:00 a.m. to 6:00 p.m. EST Monday through Thursday and from 8:00 a.m. to 4:30 p.m. on Friday.

**Proof of purchase is required and shipping charges are the responsibility of the consumer.**

**Warranty Limitations:** This warranty does not include damages which arise from misuse or abuse of this product.

**Limitation of Damages:** The warranty and remedies as set forth are exclusive and in lieu of all others, oral or written, expressed or implied. In no event will DJG or the dealer selling this product be liable to you for any damages, including incidental or consequential damages, arising out of the use or inability to use this product.

**Limitation of warranties and other warranty terms and state law rights:** Any implied warranties, including implied warranties of the merchantability and fitness for a particular purpose, shall be limited to the duration and

terms of the express written warranty. Some states do not allow limitations as to how long an implied warranty lasts or the exclusion or limitation of incidental or consequential damages, so the above limitations may not apply to you.

This warranty gives you specific legal rights, and you may have other rights, which vary from state to state. Neither DJG nor the dealer selling this product authorized any person to create for it any other warranty, obligation, or liability in connection with this product.

**Please note:** Our product warranty only applies when purchased from an authorized Maxi-Cosi retailer. The origin of products not purchased through these authorized retailers is unknown and could be counterfeit.

We cannot support products from an unknown origin as we cannot verify the handling or condition of such merchandise. We maintain a strong network of authorized retailers to ensure you are purchasing safe and complete products.

Fulfillment by a third party does not guarantee you are purchasing from one of these authorized retailers. Pricing which is inconsistent with the majority of retailers is a strong indication that the retailer is not authorized, as we have a consistent price offering across all authorized retailers.

If you are unsure of the authorization status of a retailer you are considering purchasing from, or have purchased from, you can check [www.maxicosi.com/us-en/shops.aspx](http://www.maxicosi.com/us-en/shops.aspx); or call our Consumer Care Department at 1-800-951-4113; or text us at 1-812-652-2525.

## Replacement Parts List

Chest Clip	Base
Seat Pad Set	Instructions
Crossbody Strap	Locking Clip
Harness Strap	

**If requested color is not available,  
similar color will be substituted.**

**Applicable tax and shipping &  
handling will also be added.**

**For parts availability and questions,**  
please call: 1-800-951-4113 or text: 1-812-652-2525.

**If you already know which parts you need,**  
you may complete your order with a credit card  
by calling us at 1-800-951-4113.

**We accept Visa or MasterCard.**

### **Hours of Operation:**

M-TH: 8:00 AM - 6:00 PM EST  
FRI: 8:00 AM - 4:30 PM EST

## Dorel Juvenile Group Information

Thank you for choosing this car seat, also known as a child restraint. The DJG family is committed to creating car seats with the most comfort and convenience available today.

Remember, parents are a child's first teachers and examples. If you always buckle your seat belt, your child will think it is the natural thing to do. Make it a firm rule that the vehicle does not go until everyone is buckled up. Make no exceptions.

No one can predict if use of a car seat will prevent injury or death in a particular crash. However, when combined with careful driving, proper use of a car seat can lower a child's risk of injury or death in most crashes.

If you have questions or any concerns with this car seat, please contact our Consumer Care Department:

**Call:** 1-800-951-4113

**Text:** 1-812-652-2525

**Website:** maxicosi.com

### **Hours of Operation:**

M-TH: 8:00 AM - 6:00 PM EST  
FRI: 8:00 AM - 4:30 PM EST