

# Mico 30

## Infant Car Seat

**KEEP INSTRUCTIONS  
FOR FUTURE USE.  
Read all instructions  
before using this  
child restraint.**



**MAXI-COSI®**  
We carry the future



4358-8071A  
9.12.22



**WARNING**  Failure to follow the warnings on the labels and in the instruction manual can result in serious injury or death to your child.

## Overview

Welcome to the Maxi-Cosi family and thank you for choosing this car seat, also known as a child restraint!

To help you get started using your child's new car seat, here are the 4 main tasks you'll need to complete.



**Measure Your Child**



**Adjust the Car Seat to Fit Your Child**



**Install the Car Seat into Your Vehicle**



**Secure Your Child in the Car Seat**

Your child's safety is worth the time it will take to read and follow these instructions.

**Ready? Let's go!**

**Pages 1-5** will introduce you to the parts of the car seat.

**Page 82** has our contact information. If at any point you would like assistance, please feel free to reach out to us.

## Quick Navigation



**REAR-FACING**

**5-30 lb (2.3-13.6 kg) and  
32 in. (81.3 cm) or less in height  
PAGE 6**



Rear-Facing Child Fit **PAGE 10**



Adjusting Car Seat **PAGES 11-25**



Securing Child **PAGES 26-28**



Install  
with  
Base



Install  
without  
Base



Vehicle  
Belt  
**PAGE 39**



Lower  
Anchor Belt  
**PAGE 45**



Vehicle  
Belt  
**PAGE 52**

# Contents

## Getting Started

Parts of Car Seat .....	1
Accessory Use .....	4
<b>Rear-Facing</b> Use Requirements .....	6
Preparing Car Seat for Child Fit .....	8
<b>Rear-Facing</b> Child Fit .....	10

## Making Adjustments to Car Seat

Changing <b>Harness Strap Position</b> .....	11
Changing <b>Buckle Position</b> .....	13
Harness System Adjustments <b>for Smaller Infants</b> ....	16
Removing and Installing Car Seat to Base.....	20
Base Use .....	21
Canopy Use .....	22
Carrier Use .....	24

## Securing Child in Car Seat .....26

## Choosing LATCH or Vehicle Belt

LATCH: <b>Lower Anchor</b> Use .....	29
<b>Vehicle Belts</b> .....	31

## Installation in Vehicle

<b>Rear-Facing Use With Base</b> .....	37
<b>Vehicle Belt</b> Install With Base.....	39
<b>LATCH: Lower Anchor</b> Install with Base.....	45
<b>Rear-Facing Use Without Base</b> .....	51
<b>Vehicle Belt</b> Install Without Base.....	52

## Wash & Care of Car Seat Parts

Removing Seat Pad Set for Cleaning .....	57
Removing Harness System .....	59

## Cleaning Parts of Car Seat and Installing Seat Pad Set .....

Installing Harness System.....	64
--------------------------------	----

## Safety Information

<b>Aircraft Information</b> .....	68
<b>Replacement and Expiration</b> of Car Seat .....	69
Child Restraint Use .....	71
Installation in Vehicle .....	72
Vehicle Seating Position .....	72
Troubleshooting .....	74
Registration and Safety Notices .....	75

## Additional Information

Warranty .....	77
Replacement Parts List .....	81
Dorel Juvenile Group Information.....	82

# Parts of Car Seat

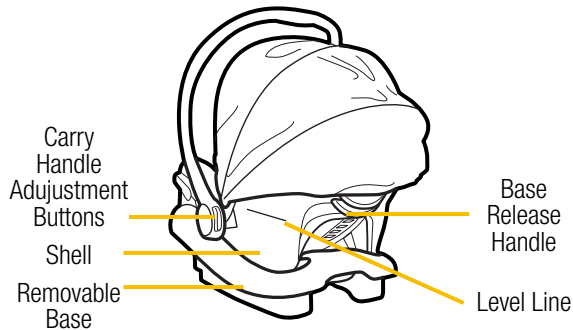
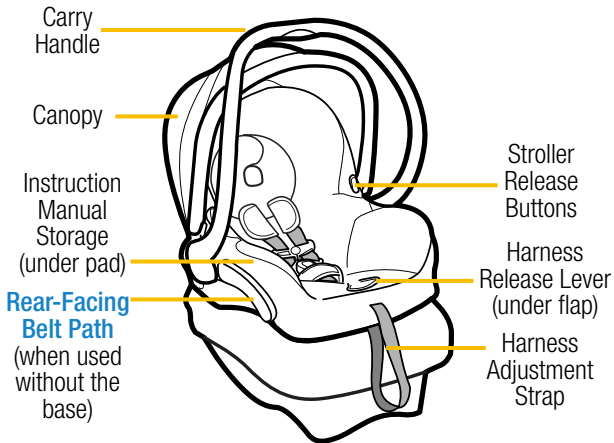

## Harness System Detail

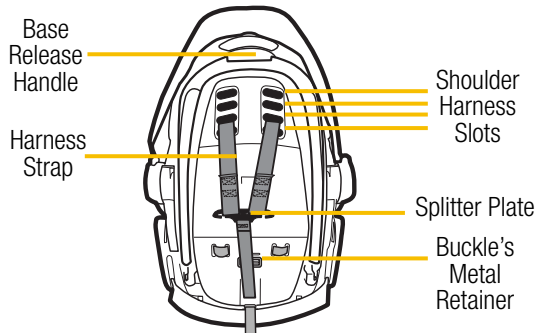
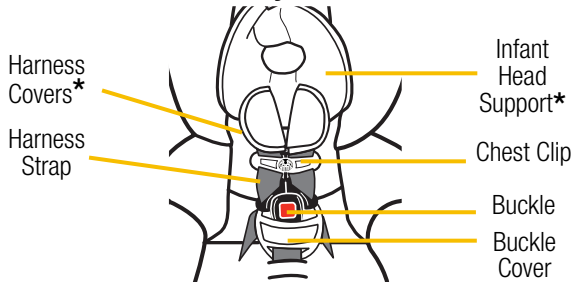

\*See pages 4 & 5 for Accessory Use.

*continued on next page*



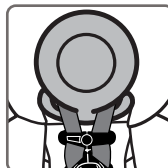
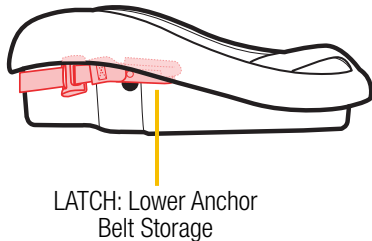
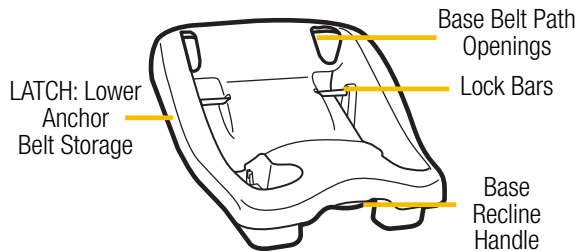

### Infant Head Support

When using the infant head support, make sure it does not cover your child's face in any way.

You may remove it for bigger infants.

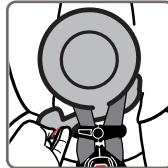

**To remove**, pull it off of the harness straps.

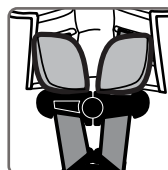

### Harness Covers

The harness covers help provide comfort to your child's neck. If the harness covers will not allow proper positioning of the chest clip or interfere with getting a tight enough harness fit for a smaller infant, remove and **do not** use.



Store until your child is large enough to use the harness covers while maintaining a properly fitting harness.

**To remove**, pull the fastening strips apart and pull the harness covers off of the harness strap.

*continued on next page*

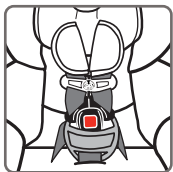

### Buckle Cover

**To remove**, unbuckle the harness system and slide the buckle cover off of the buckle.



**Measure your child's weight and height (do not guess) before using this car seat.**

Your child's height, weight, and age determine how the car seat should be placed in the vehicle.

Children vary widely in body size, shape, and temperament—**please consult your doctor before switching between any types or modes of a car seat within the limits and fit requirements of the seat.**

### State Laws

Please be certain to follow your state laws regarding car seat use.

### American Academy of Pediatrics Recommendations

#### Infants and Toddlers

Should ride in a rear-facing car seat as long as possible, until they reach the highest weight or height allowed by their seat.

#### Toddlers and Preschoolers

Once they are facing forward, children should use a forward-facing car seat with a harness for as long as possible, until they reach the height and weight limits for their seats.

*continued on next page*

### School-Aged Children

Once they have outgrown their forward-facing car seat, children should use a belt-positioning booster seat until the vehicle's lap and shoulder seat belt fits properly. This is often when they have reached at least 4 feet 9 inches in height and are 8 to 12 years old.

### Older Children

All children younger than 13 years should be restrained in the rear seats of vehicles for optimal protection.



### REAR-FACING

**5-30 lb (2.3-13.6 kg) and 32 in. (81.3 cm) or less in height**

Children under 1 year of age must ride **Rear-Facing**.

This car seat can only be used **Rear-Facing**.

Your child can remain in this car seat until they outgrow any one of the following:

- **Weight Limit: 30 lb (13.6 kg); OR**
- **Height Limit: 32 in. (81.3 cm); OR**
- **Rear-Facing Child Fit** requirements, see page 10

## Preparing Car Seat for Child Fit

1

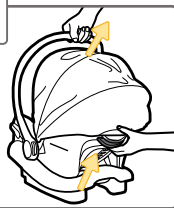

### Remove Car Seat From Base

From the back of the car seat, slide the base release handle up and lift the car seat out of the base.

2

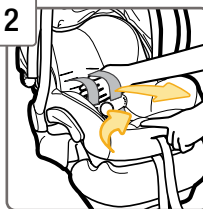

### Fully Loosen Harness Straps

Push down on the harness release lever (through the opening in the pad) while pulling out on the harness straps as shown.

3

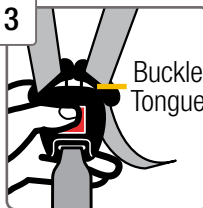

### Unbuckle Harness

Press in on the red button and pull out the buckle tongues.

*continued on next page*

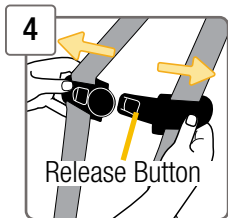

### 4 Release Chest Clip

Hold each side of the chest clip and press on the release button with your thumb and pull apart.

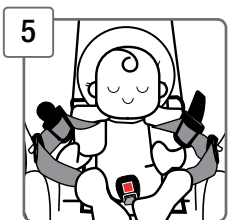

### 5 Place Child in Car Seat to Determine Proper Harness Fit

The child's bottom and back should be flat against the car seat.

For **Rear-Facing** child fit, see page 10.

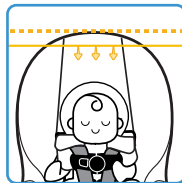

### Head Position

The top of your child's head **must be at least 1 in. (2.5 cm) below** the top of the car seat.

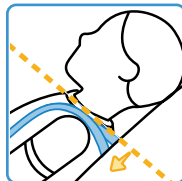

### Harness Strap Position

The harness strap **must be at or slightly below** the shoulders; **never above**.

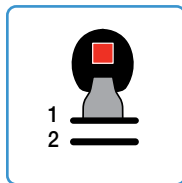

### Buckle Position

Choose the slot closest to your child.

The buckle **should not be underneath or behind** your child.

**Need to make adjustments?**

**To change harness height**, see pages 11-12.

**To change buckle position**, see pages 13-15.

1



### Fully Loosen Harness Straps

Push down on the harness release lever (through the opening in the pad) while pulling out on the harness straps as shown.

2

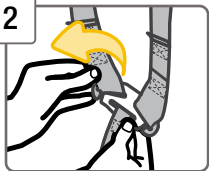

### From Back of Car Seat, Remove Harness Strap Loops From Splitter Plate

3

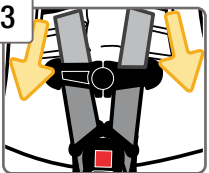

### Pull Harness Strap Out of Shoulder Harness Slots

4

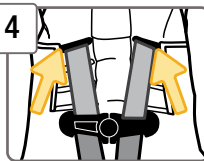

### Rethread Harness Strap Into Correct Shoulder Harness Slots For Your Child

Make sure the shoulder harness slots in the pad are correctly lined up with the same shoulder harness slots in the shell. For **Rear-Facing** child fit, see page 10.

5

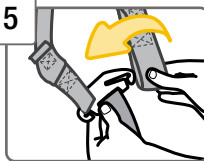

### Attach 1st Harness Strap Loops to Splitter Plate

The sewn ends of the harness strap loops **must** face towards you.

**Do not** twist the harness strap or the harness adjustment strap.

Make sure the **same** harness strap loops are fitted **completely** on both sides of the splitter plate.

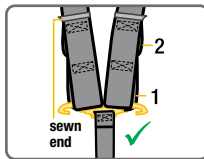

**Check your child's fit often. If you cannot achieve a snug harness fit for your child, see pages 16-19.**

**To learn how to check harness tightness, see pages 26-28.**

**Check the harness straps often for any wear or damage.**

## Changing Buckle Position

1

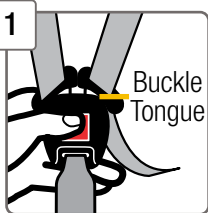

### Unbuckle Harness

Press in on the red button and pull out the buckle tongues.

2

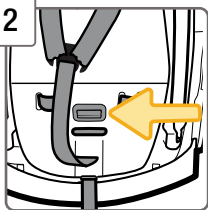

### Turn Car Seat Over

Locate the buckle's metal retainer on the bottom of the shell.

3

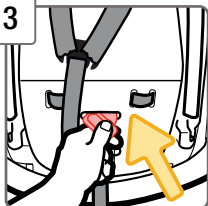

Rotate Metal Retainer and Push It Up Through Shell and Pad

4

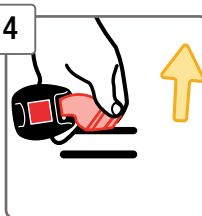

From Top of Car Seat, Pull Buckle Out of Shell and Pad

5

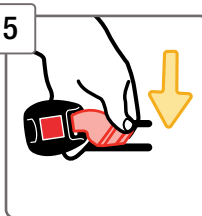

Insert Buckle's Metal Retainer into Buckle Slot Closest to Your Child

The buckle **must** face out.

6

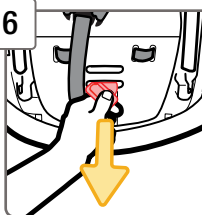

From Bottom of Car Seat, Pull Buckle's Metal Retainer Completely Through Pad and Shell

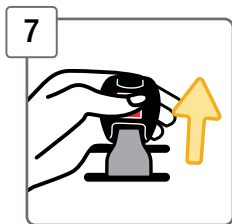

### 7 Check Buckle

Pull up on the buckle to make sure it is secured.

The buckle **must not** pull out.

Check your child's fit often. If you cannot achieve a snug harness fit for your child, see pages 16-19.

To learn how to check harness tightness, see pages 26-28.

**⚠** Failure to place buckle's metal retainer completely through pad and shell can result in serious injury or death.

## Harness System Adjustments for Smaller Infants

If you cannot achieve a snug harness fit for your child, make these adjustments.

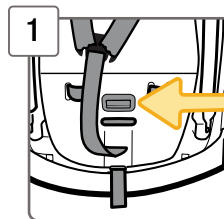

**1 With Buckle in the 1st Slot As Shown, Turn Car Seat Over**

If you need to move the buckle to the 1st slot, see pages 13-15.

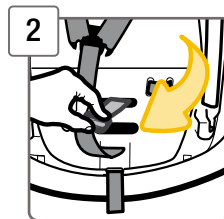

**2 From Bottom of Car Seat, Pull Metal Retainer Towards You and Push It Up into 2nd Slot As Shown**

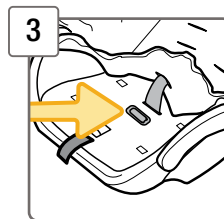

**3 From Top of Car Seat, Lift Pad Up and Lay the Metal Retainer Flat Against Shell As Shown**

*continued on next page*

4



### Replace Pad and Check Buckle

Pull up on the buckle to make sure it is secured.

The buckle **must not** pull out.

5

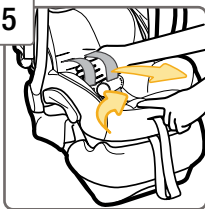

### Fully Loosen Harness Straps

Push down on the harness release lever (through the opening in the pad) while pulling out on the harness straps as shown.

6

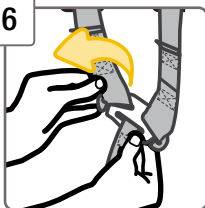

### From Back of Car Seat, Remove Harness Strap Loops From Splitter Plate

7

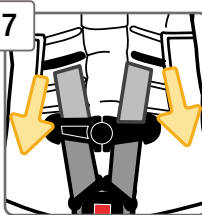

### Pull Harness Strap Out of Shoulder Harness Slots

8

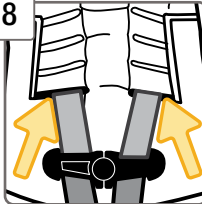

### Rethread Harness Strap Into Correct Shoulder Harness Slots For Your Child

Make sure the shoulder harness slots in the pad are correctly lined up with the same shoulder harness slots in the shell.

For **Rear-Facing** child fit, see page 10.



9

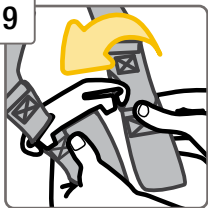

### Attach 2nd Harness Strap Loops to Splitter Plate As Shown

The sewn ends of the harness strap loops **must** face towards you.

**Do not** twist the harness strap or the harness adjustment strap.

Make sure the **same** harness strap loops are fitted **completely** on both sides of the splitter plate.

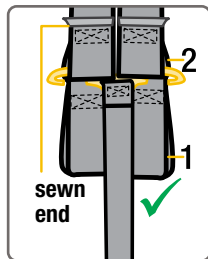

Check your child's fit often.

To learn how to check harness tightness, see pages 26-28.

Check the harness straps often for any wear or damage.

 The harness system must be installed correctly. Do not use a child restraint with damaged harness straps.

## Removing and Installing Car Seat to Base

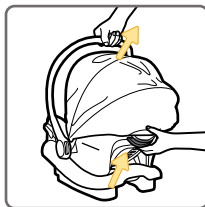

### To Remove Car Seat from Base

From the back of the car seat, slide the base release handle up and lift the car seat out of the base.

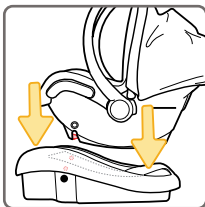

### To Attach Car Seat to Base

Align the slots on the sides of the car seat with the lock bars in the base.

Push down firmly on the carry handle and the front of the car seat to lock it to the base. You will hear a "click" when it is locked.

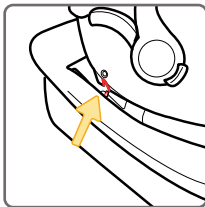

Pull up on the front two corners of car seat by your child's feet to make sure it is locked to the base.

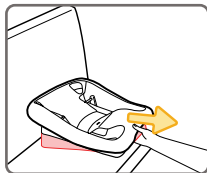

### Adjusting Base

The base has multiple positions.

From the front of the base, squeeze the base recline handle and lift or lower the front of base.

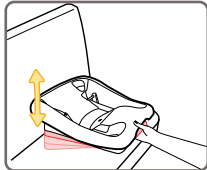

When installing with the base, you may have to adjust the base to get the right recline angle.

### Cleaning Canopy

Hand wash using warm sudsy water. Line dry.

### Canopy Parts

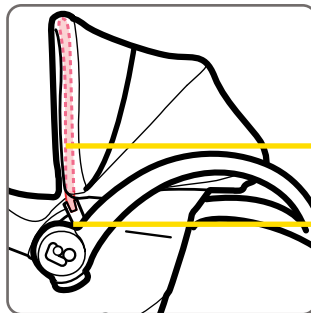

**Canopy Hoop**  
(plastic strip)

**Canopy Post**

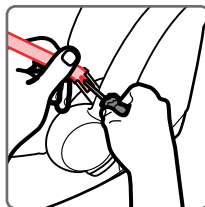

### To Remove Canopy

Using a screwdriver, press in on the canopy tab locks on the canopy post and pull the canopy hoop off of the posts. Pull the canopy hoop out of the canopy.

*continued on next page*

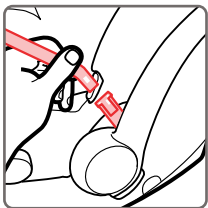

### To Install Canopy

The canopy hoop has an angle that will make the canopy lean forward when installed. Make sure the angle is correct when you thread the canopy hoop into canopy.

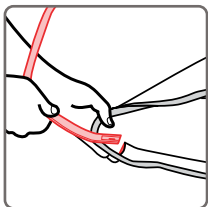

### Thread Canopy Hoop Completely Through Channel on the Front Edge of Canopy

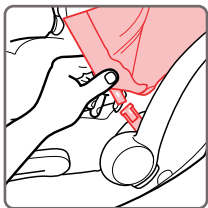

### Attach Canopy

Fit the back of the canopy over the back of the shell.

Snap each plastic strip end to each canopy post.

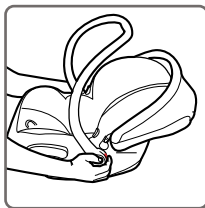

### To Adjust Carry Handle

Squeeze both of the adjustment buttons on each side of the carry handle.

Rotate the carry handle up or down to the desired location. Release the buttons.

Make sure both carry handle adjustment buttons are in the locked position.

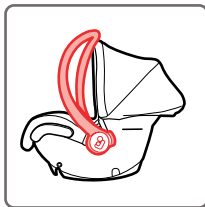

**The carry handle must be upright AND locked when carrying and when installed in the vehicle.**

## WARNINGS

Read ALL instructions before using child restraint as a carrier.

**NEVER** use carrier unless child is properly secured.

Use only as a carrier by children weighing 5-30 pounds (2.3-13.6 kg) and 32 inches (81.3 cm) or less in height.

**NEVER** leave child unattended. Always keep child within arm's reach.

**Suffocation Hazard:** Infant carrier can roll over on soft surfaces and suffocate child. **NEVER** place carrier on beds, sofas or other soft surfaces.

**Strangulation Hazard:** Children have **STRANGL**ED in loose or partially buckled harness straps. Fully restrain the child even when carrier is used outside the vehicle.

**Fall Hazard:** Child's activity can move carrier. **NEVER** place carrier on counter tops, tables, or any other elevated surface.

The carrier can fall from the shopping cart. Do not use on shopping cart.

Do not use the carrier if it is damaged or broken, or if any parts are missing.



### 1 Place Child in Car Seat

The child's bottom and back should be flat against the car seat.

Position the harness straps over your child's shoulders and upper thighs.



### 2 Buckle Harness

Push the buckle tongues into the buckle until you hear them "click".

Pull up on the harness straps to make sure the buckle is locked.

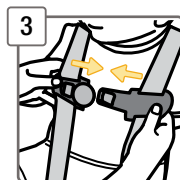

### 3 Fasten Chest Clip

Insert the right half of chest clip into the left half and snap together.

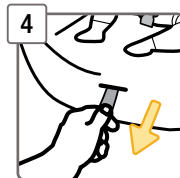

### 4 Tighten Harness

Pull straight out on the harness adjustment strap to tighten the harness snugly.

*continued on next page*



5

### Position Chest Clip

Slide the chest clip up the harness straps and position it at mid-chest (even with armpits) and away from your child's neck.



6

### Check Harness Tightness

Try to pinch the harness at the shoulders vertically between index finger and thumb as shown.

**If your fingers slip off**, the harness is tight enough.

**If you can pinch the harness strap**, tighten more.

A snug strap should not allow any slack. It lies in a relatively straight line without sagging. It does not press on the child's flesh or push the child's body into an unnatural position.

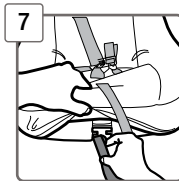

7

### Attach Harness Adjustment Strap Loop to Shell

Pull the pad up at the front of the shell. The end of the harness adjustment strap has a loop. Slide one side of the loop onto one tab and the other side on the other tab. Replace the pad over the front of the shell.

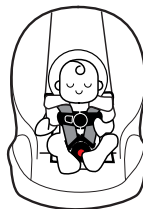

## Finished!

The child is now secured in the car seat.

Check your child's fit often and make any needed adjustments to the car seat as they grow.

### To Remove Child From Car Seat:

1. Loosen Harness Strap
2. Unbuckle Harness
3. Release Chest Clip
4. Remove Child

**⚠ Failure to fasten and tighten the harness system correctly may allow the child to be ejected from the child restraint in a crash or sudden stop causing serious injury or death.**



**Do not mistake comfort for safety. Harness system must be snugly adjusted.**

**Do not put snowsuits or bulky garments on your child when placing them in the child restraint. Bulky clothing can prevent the harness straps from being tightened properly.**



## LATCH: Lower Anchor Use

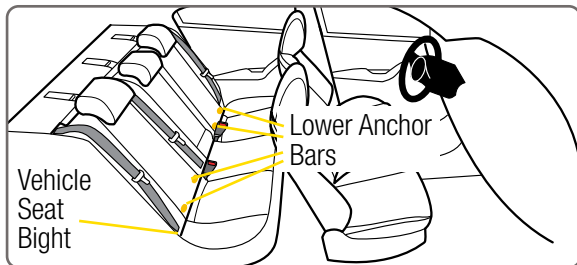

Your vehicle's features may be considerably different than those pictured here.

The lower anchors of LATCH (Lower Anchors and Tethers for Children) is a universal system for installing car seats without using vehicle seat belts.

The lower anchor can ONLY be used in vehicles that have the lower anchor bars installed in designated seating positions. Most vehicles manufactured after September 2002 are equipped with lower anchor bars.

Check your vehicle owner's manual to see which seating positions may be equipped with LATCH: lower anchor bars.

**⚠ Do not use both the lower anchor belt and vehicle belt at the same time.**

**When used correctly the lower anchor belt or vehicle belts are equally safe.**

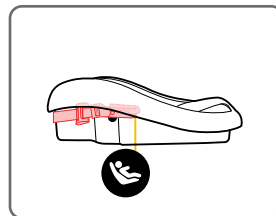

**Lower Anchor Belt Storage Attachment**

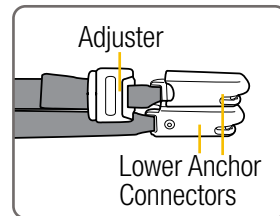

**Lower Anchor Belt Parts**

### To Remove Lower Anchor Belt from Storage Location on Base:

Press the red release button on each connector, then pull the connectors off of the storage attachments.

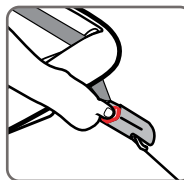

### To Remove Lower Anchor Belt from Vehicle Lower Anchor Bars:

Press the red release button on each connector, then pull the connectors out of the vehicle seat bight.

### To Store Lower Anchor Belt:

When using the vehicle belts or when the base is not installed in a vehicle, attach the connectors to the attachments on the base. Gently tighten to remove slack.



## Vehicle Belts

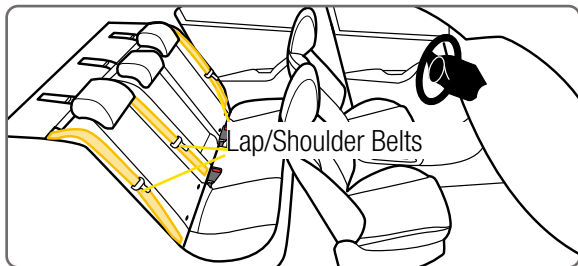

Your vehicle's features may be considerably different than those pictured here.

If lower anchors are not an option, you must use the vehicle seat belt system to install the car seat.

**Not all vehicle belts and seating positions will work with car seats.**

**Please go through the following steps to understand how to lock a car seat with a vehicle belt.**



1



### You Must Review Your Vehicle Owner's Manual

Your vehicle owner's manual will let you know which vehicle belts and seating positions car seats can be installed in.

2



### Determine How This Car Seat Will Be Locked Into Place

The vehicle belt **must not** loosen after tightening. This means there needs to be a way to lock the vehicle belt.

The ways this can be done are:

- By using the seat belt's retractor (see step 3); **OR**
- By using the seat belt's latch plate (see step 4).



3

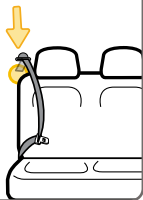

### Check Retractor

Retractors pull seat belts into stored positions and lock the belt to hold passengers in place.

See the next page for some common types of vehicle belt retractors that will work with this car seat.

### Types of Retractors

#### Switchable Retractor

(most vehicles have this type)



This retractor can be switched to a locking mode.

You **must have the retractor in the locking mode** to use the seat belt with this car seat.

**Switching to locking mode:** Slowly pull the shoulder belt all the way out, then let it go back in 1-2 in. (2.5-5 cm).

As it goes back in, you will most likely hear a ratcheting sound.

Gently pull the belt to see if it has locked. You will not be able to pull any more belt out if the lock has engaged.



#### Automatic Locking Retractor



This retractor always locks.

It will automatically lock after slowly pulling the seat belt out at least halfway and letting the belt go back into the retractor 1-2 in. (2.5-5 cm).

#### Emergency Locking Retractor

See Step 4, "Check Latch Plates".

If the retractor does not lock, it is most likely an Emergency Locking Retractor. These retractors only lock during a sudden stop or collision.

You will need to determine if your seat belt's latch plate can lock the belt. See step 4, "Check Latch Plates".

*continued on next page*



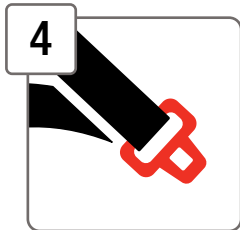

### Check Latch Plates

Latch plates are the part of the seat belt that goes into the buckle.

To see if the latch plate locks:

1. Buckle Vehicle Belt
2. Firmly Tug Lap Portion of Seat Belt While Pulling It Up

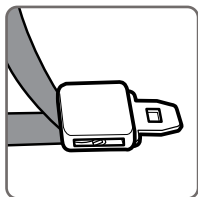

Locking Latch Plate

If the vehicle belt does not slide through the latch plate, it's locked.

If the latch plate slides up and down the vehicle belt, it is a **sliding latch plate**.

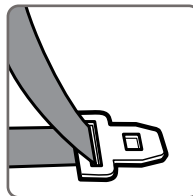

Emergency Locking Retractor with a Sliding Latch Plate

Sliding latch plates easily slip between the lap and shoulder portions of the belt.

**If you have an Emergency Locking Retractor with a Sliding Latch Plate, you must use a locking clip.**

Please contact us for one. See page 81.

### Never Use With This Car Seat

Emergency Locking Retractor Lap Only Belt	✗
Inflatable Seat Belts	✗



## Rear-Facing Use with Base

**5-30 lb (2.3-13.6 kg) and  
32 in. (81.3 cm) or less in height**

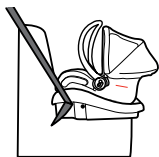

Lap/  
Shoulder Belt

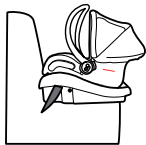

Lap  
Belt

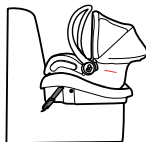

LATCH: Lower  
Anchor Belt



Never install a rear-facing child restraint in the front seat of a vehicle equipped with an active frontal airbag.

Check the vehicle belt or the lower anchor belt before each use. Use only if the belt can be tightened properly and locked securely in place.

Do not fasten multiple lower anchor connectors on the same lower anchor bar in the vehicle.

Child restraint must be securely attached to base.

Even when unoccupied, this child restraint must be firmly secured to the vehicle with a lower anchor belt or with the vehicle seat belt.

This child restraint must always face the rear of the vehicle.



Before you begin installing the seat into your vehicle, did you check:

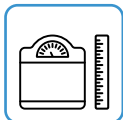

**Your child's weight and height?**  
See page 7.



**Your child's fit? See page 10.**

Do you need to make adjustments to the harness height or the buckle position?

1

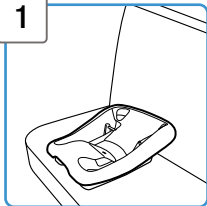

### Place Base in Vehicle

Center the base in the chosen seating position as shown.



2

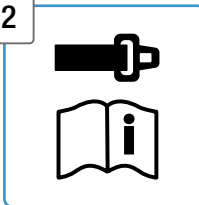

### Check if Your Vehicle Belts Will Work With This Car Seat

This is very important because **not all vehicle belts will work with car seats.**

Review pages 31-36 and your vehicle owner's manual to find out what kind of vehicle belts you have and how to lock a car seat in place.

3

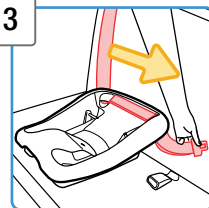

### Route Vehicle Belt Through Base Belt Path



4

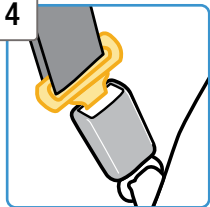

### Buckle Vehicle Belt

If your car's vehicle belt has a switchable retractor, use it to lock the vehicle belt.

For information about switchable retractors, see page 33 or review your vehicle owner's manual

5



### Tighten Belt

Place your hand on the base. Firmly push the base down and towards the vehicle seat back while pulling the shoulder belt or the free end of the lap belt parallel with the base belt path.

6

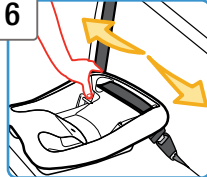

### Check Belt Tightness

Hold the base at the belt path with your weaker hand.

Push and pull from side to side.

It should not move more than **1 in. (2.5 cm)**.

#### If it moves more than 1 in. (2.5 cm), you can try:

- Reinstalling the base; **OR**
- Changing to a different seating location; **OR**
- Switching to lower anchor belt installation if lower anchors are available in your vehicle



7

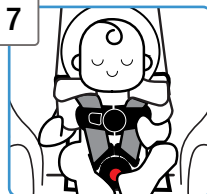

### Secure Child in Car Seat

To properly secure your child in the car seat, see pages 26-28.

Check your child's fit often and make any needed adjustments to the car seat as they grow.



8

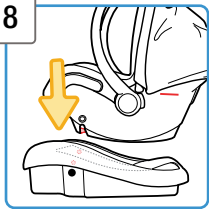

### Attach Car Seat to Base

Pull up on the front two corners of the car seat by your child's feet to make sure it is locked to the base.

**The carry handle must be upright AND locked when carrying and when installed in the vehicle.**

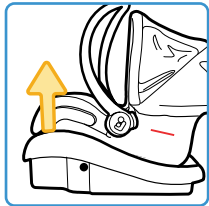

9

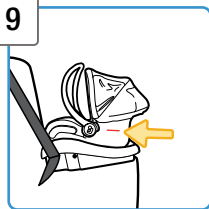

### Recheck Level Line

Redo the installation if level line is not parallel with the ground.

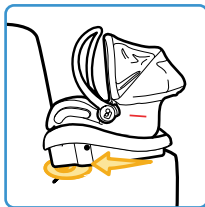

Only if necessary, you may need to place a tightly rolled towel(s) or foam pool noodle(s) under the front of the base to help make the level line parallel with the ground.

Check often to be sure padding is still in place and the belt is tight.

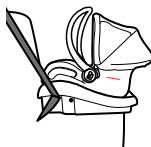

## Finished!

Check the tightness of the install often to make sure it has not loosened.



## LATCH: Lower Anchor Install with Base

Before you begin installing the seat into your vehicle, did you check:



Your child's weight and height? See page 7.

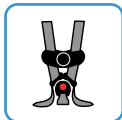

Your child's fit? See page 10.

Do you need to make adjustments to the harness height or the buckle position?

1



### Remove Lower Anchor Belt from Storage Location

Unhook the lower anchor connectors from the base by pressing the red release button on each connector.

2

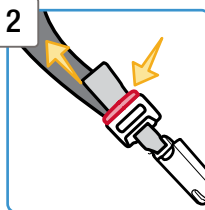

### Loosen Lower Anchor Belt

Only 1 connector has an adjuster. Push the adjuster's button and pull the belt to loosen.

3

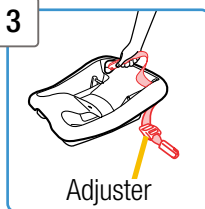

### Route Lower Anchor Belt Through Base Belt Path

The LATCH: Lower Anchor belt adjuster **must be** on the right side of the base as shown.

**Do not twist belt.**

4

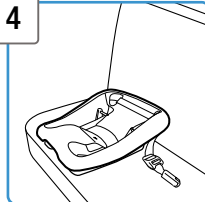

### Place Base in Vehicle

Center the base in the chosen seating position as shown.





5

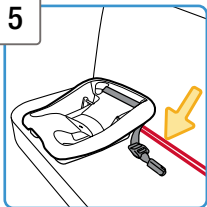

### Locate Vehicle's Lower Anchor Bars

Review your vehicle owner's manual for lower anchor locations and lower anchor belt use.

6

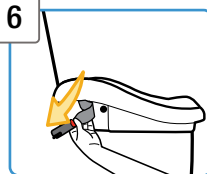

### Attach Lower Anchor Connectors to Vehicle's Lower Anchors

Make sure the arrows on connectors are facing up.



Fasten one lower anchor belt connector to the anchor located in the vehicle seat bight.

Repeat for the other side of base.

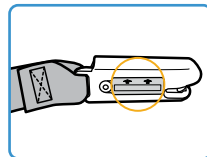

7

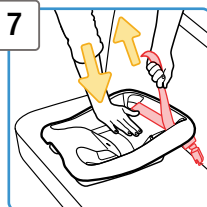

### Tighten Belt

Place your hand on the base.

Firmly push the base down and towards the vehicle seat back while pulling the free end of the belt parallel with the base belt path.

8

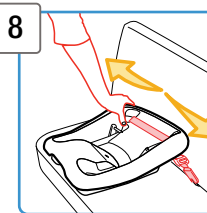

### Check Belt Tightness

Hold the base at the belt path with your weaker hand.

Push and pull from side to side. It should not move more than **1 in. (2.5 cm)**.

**If it moves more than 1 in. (2.5 cm), you can try:**

- Pulling the belt tighter; **OR**
- Reinstalling the car seat; **OR**
- Changing to a different seating location; **OR**
- Switching to vehicle belt installation

*continued on next page*



9

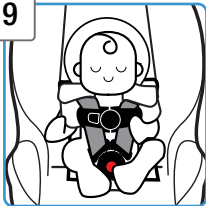

### Secure Child in Car Seat

To properly secure your child in the car seat, see pages 26-28.

Check your child's fit often and make any needed adjustments to the car seat as they grow.

10

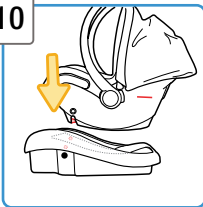

### Attach Car Seat to Base

Pull up on the front two corners of the car seat by your child's feet to make sure it is locked to the base.

**The carry handle must be upright and locked when carrying and when installed in the vehicle.**

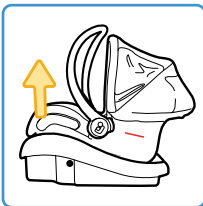

11

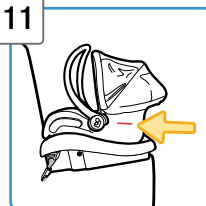

### Recheck Level Line

**Redo the installation if level line is not parallel with the ground.**

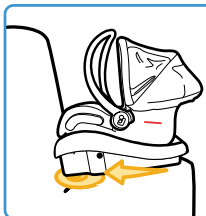

Only if necessary, you may need to place a tightly rolled towel(s) or foam pool noodle(s) under the front of the base to help get the correct recline. Check often to be sure padding is still in place and the belt is tight.

### Finished!

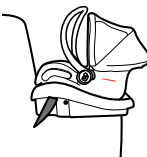

Check the tightness of the install often to make sure it has not loosened.





## Rear-Facing Use Without Base

**5-30 lb (2.3-13.6 kg) and  
32 in. (81.3 cm) or less in height**

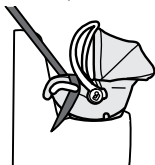

Lap/Shoulder Belt

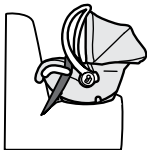

Lap Belt



**Never install a rear-facing child restraint in the front seat of a vehicle equipped with an active frontal airbag.**

Check the vehicle belt before each use. Use only if the belt can be tightened properly and locked securely in place.

Even when unoccupied, this child restraint must be firmly secured to the vehicle with the vehicle seat belt.

This child restraint must always face the rear of the vehicle.



## Vehicle Belt Install Without Base

**Before you begin installing the seat into your vehicle, did you check:**

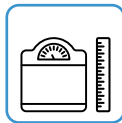

**Your child's weight and height?**  
See page 7.



**Your child's fit? See page 10.**

Do you need to make adjustments to the harness height or the buckle position?

1

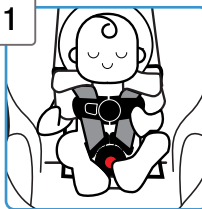

### Secure Child in Car Seat

To properly secure your child in the car seat, see pages 26-28.

Check your child's fit often and make any needed adjustments to the car seat as they grow.

*continued on next page*



2

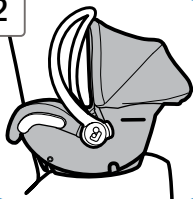

### Place Car Seat in Vehicle Rear-Facing

Center the car seat in the chosen seating position.

**The carry handle must be upright and locked when carrying and when installed in the vehicle.**

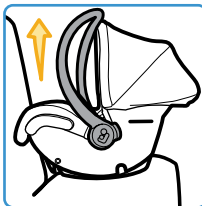

3

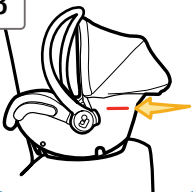

### Check Level Line

Check the level line on the side of shell to see if it is parallel with the ground.

Adjust if needed.



4



### Check if Your Vehicle Belts Will Work With This Car Seat

This is very important because **not all vehicle belts will work with car seats.**

Review pages 31-36 and your vehicle owner's manual to find out what kind of vehicle belts you have and how to lock a car seat in place.

5

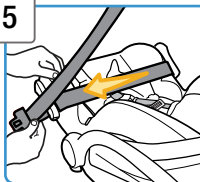

### Route Vehicle Lap or Lap Portion of the Lap/Shoulder Belt Through Shell Belt Path on Both Sides of Shell As Shown

6

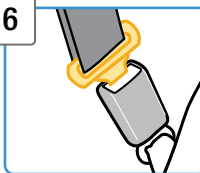

### Buckle Vehicle Belt

If your car's vehicle belt has a switchable retractor, use it to lock the vehicle belt.

For information about switchable retractors, see page 33 or review your vehicle owner's manual

*continued on next page*



7

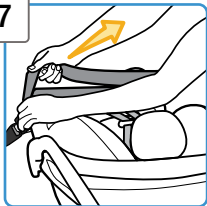

### Tighten Belt

Lay your forearm across the car seat at the belt path while pulling the shoulder belt or the free end of the lap belt to tighten.

8

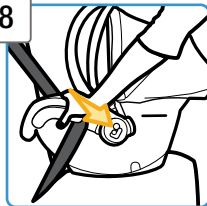

### Check Belt Tightness

Hold the car seat at the belt path with your weaker hand.

Push and pull from side to side.

It should not move more than **1 in.** (2.5 cm).

**If it moves more than 1 in. (2.5 cm), you can try:**

- Pulling the belt tighter; **OR**
- Reinstalling the car seat; **OR**
- Changing to a different seating location



9

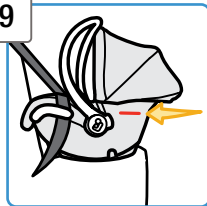

### Recheck Level Line

**Redo the installation if level line is not parallel with the ground.**

Only if necessary, you may need to place a tightly rolled towel(s) or foam pool noodle(s) under the front of the car seat to help make the level line parallel with the ground.

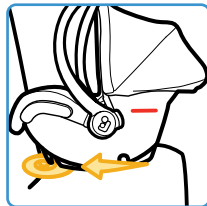

Check often to be sure the padding is still in place and the belt is tight.

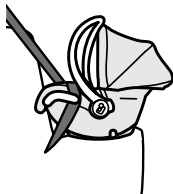

## Finished!

Check the tightness of the install often to make sure it has not loosened.

## Removing Seat Pad Set for Cleaning

You do not need to remove the harness system to remove the pad.

To remove accessories, see pages 4-5.

1

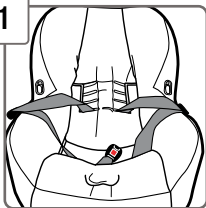

**Release Chest Clip and Buckle**

2

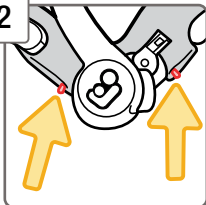

**Pull Pad off Pad Tabs**

To release the pad from the tab, pull down on the pad and pull the pad off the tab.

Repeat for the other side.

3

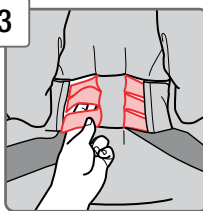

**Pull Shoulder Harness Pad Slots Out From Behind Plastic Strip in Pad As Shown**

4

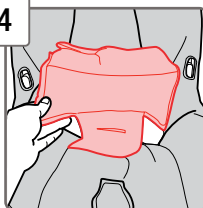

**Pull Back Panel of Pad Forward As Shown**

Pull the buckle down through the slot in the pad.

Push the harness strap behind the panel.

5

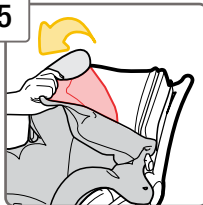

**From Top Of Car Seat, Pull Pad Off of Shell**

Pull the buckle and the harness adjustment strap through the pad.

## Removing Harness System

1

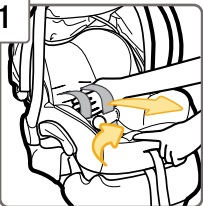

### Fully Loosen Harness Strap

Push down on the harness release lever (through the opening in the pad) while pulling out on the harness strap as shown.

2

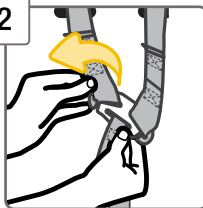

### From Back of Car Seat, Remove Harness Strap Loops From Splitter Plate

3

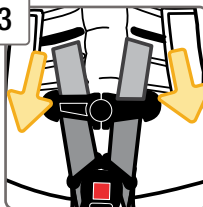

### Pull Harness Strap Out of Shoulder Harness Slots

4

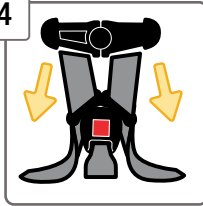

### Unthread Chest Clip

5

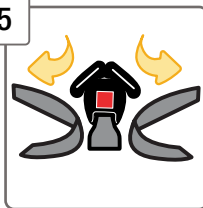

### Unthread Buckle

Do not unbuckle.

6

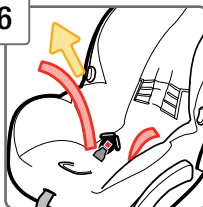

### Pull Harness Strap Out of Hip Harness Slots

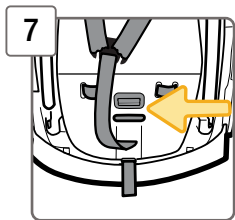

### 7 Turn Car Seat Over

Locate the buckle's metal retainer on the bottom of the shell.

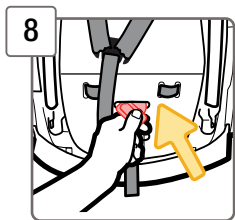

### 8 Rotate Metal Retainer and Push It Up Through Shell and Pad

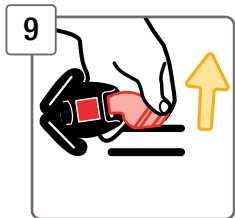

### 9 From Top of Car Seat, Pull Buckle Out of Shell And Pad

## Cleaning Parts of Car Seat and Installing Seat Pad Set

### Cleaning Pad and Accessories

Machine wash separately with cold water on a gentle cycle. Do not use bleach. Tumble dry separately for 10-12 minutes on low heat. Remove immediately.

### Cleaning Harness Strap

**Check the harness straps often for any wear or damage.**

Spot clean using warm sudsy water and damp cloth. Spilled food and liquids on the car seat may result in mold or bacterial growth over time. These spills could also attract insects or rodents.

### Cleaning Buckle & Car Seat Shell

Spot clean using warm sudsy water and damp cloth. Do not submerge into water.

**⚠ Do not use the child restraint without the seat pad or with damaged harness straps.**

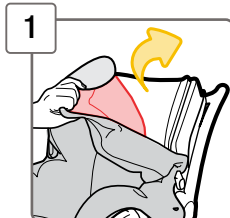

### 1 Starting From Bottom of Car Seat, Slip Pad on Shell and Wrap Around Top of Shell

*continued on next page*

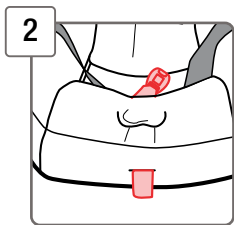

**2** Pull Harness Adjustment Strap and Buckle Through Slots in Pad

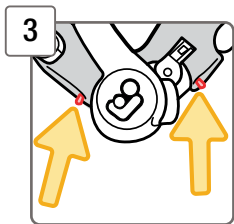

**3** Attach Pad to Tabs on Both Sides of Shell

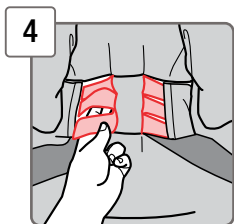

**4** Tuck Pad Behind Harness Strap

Thread the harness strap into the shoulder harness slots in the pad and push the slits behind the plastic strip in the pad.

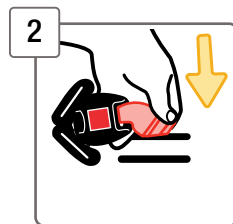

**2** Insert Buckle's Metal Retainer into Buckle Slot Closest to Your Child

The buckle **must** face out.

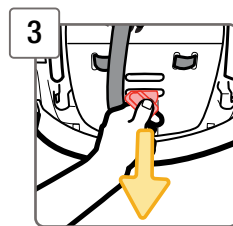

**3** Pull Buckle's Metal Retainer Completely Through Pad and Shell

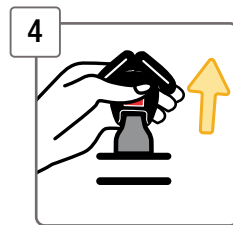

**4** Check Buckle

Pull up on the buckle to make sure it is secured.

The buckle **must not** pull out.

5

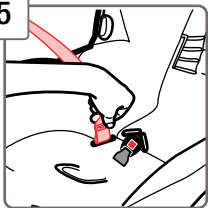

### Thread Harness Strap

With the sewn end of the harness strap loop facing the buckle, thread the harness strap down through the hip harness slot.

6

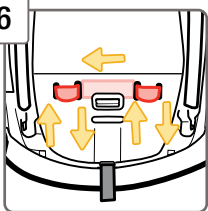

### Lift Up Front of Pad and Weave Harness Strap In and Out of Shell As Shown

7

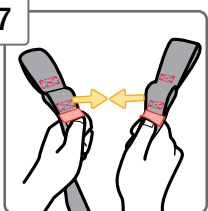

### Make Harness Strap Even

The sewn ends of the harness strap loops **must** face each other.

8

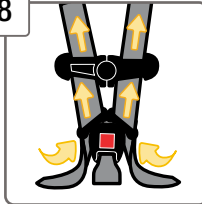

### Thread Buckle and Chest Clip

The harness strap ends go through the back of the buckle tongues and through the chest clip, front to back as shown.

9

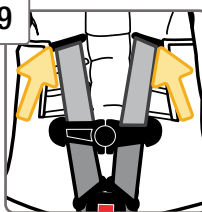

### Rethread Harness Strap Into Correct Shoulder Harness Slots For Your Child

Make sure the shoulder harness slots in pad are correctly lined up with the same shoulder harness slots in shell.

For **Rear-Facing** child fit, see page 10.



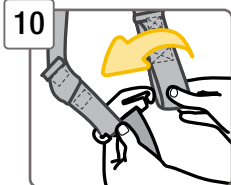

### 10 Attach 1st Harness Strap Loops to Splitter Plate

The sewn ends of the harness strap loops **must** face towards you.

**Do not** twist the harness strap or the harness adjustment strap.

Make sure the **same** harness strap loops are fitted **completely on** both sides of the splitter plate.

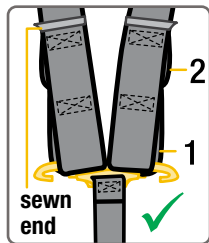

Check your child's fit often.

If you cannot achieve a snug harness fit for your child, see pages 16-19.

To learn how to check harness tightness, see pages 26-28.

Check the harness straps often for any wear or damage.

**⚠** The harness system must be installed correctly. Do not use a child restraint with damaged harness straps.



This restraint is certified for aircraft use.

Install the car seat in a window seat to avoid blocking the aisle. If the aircraft lap belt is too short, ask the flight attendant for a belt extender.

Use only on forward-facing aircraft seats.

Contact the airline for their specific policies.

Some airlines may ask to see a label stating that this car seat is certified for aircraft use.



There is an airplane certification label located on the side of this car seat as shown.

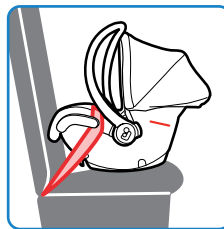

### Rear-Facing Aircraft Installation without Base

Follow pages 52-56.

You can only install this child restraint in the aircraft without the base.

## Replacement and Expiration of Car Seat

### Do not risk your child's safety.

To keep your child as safe as possible, Dorel Juvenile Group strongly recommends replacing the car seat even after a minor crash; even if it was not occupied at the time.

### Replacement After a Minor Crash

The National Highway Traffic Safety Administration states that for a crash to be considered minor **ALL of the following must be true:**

- Vehicle able to drive away from the crash site; **AND**
- Vehicle door nearest the car seat was not damaged; **AND**
- No passengers were injured; **AND**
- Airbags did not deploy; **AND**
- There is no visible damage to the car seat.

If the crash your car seat was involved in meets **ALL** the criteria, you may not need to replace the car seat.

If one or more of these criteria are not true or if you are uncertain of any of your answers, replace the car seat immediately.

### Replacement After a Moderate to Severe Crash

You **must** replace this car seat if it has been in a moderate to severe car crash.

This car seat is intended to protect a child in a single crash.

During a crash, the car seat and all of its parts absorb crash energy which can deform or weaken it. Damage is not always visible. A damaged car seat must be replaced immediately.

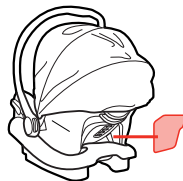

### Expiration

On the back of the car seat there is a date of manufacture label as shown.

Do not use this car seat more than 8 years after the date of manufacture.



## Child Restraint Use

Never take your child out of the child restraint while the vehicle is moving.

Never leave child unattended.

Placing your child in a hot child restraint may result in burns.

Do not use a child restraint with damaged or missing parts.

Do not use a child restraint with cut, frayed, or damaged harnesses.

Do not substitute parts or try to modify the child restraint in any way.

Do not lubricate buckles and fasteners.

Do not use any child restraint accessory except those approved by Dorel Juvenile Group.

Never allow any child to play with this child restraint; it is not a toy.

Do not remove or cover up any of the warning labels or other labels on the child restraint.

This child restraint has been certified for use in passenger vehicles. Do not use in a boat, on a motorcycle or in a cargo van or bus where there are no seat belts.

Read all instructions for additional warnings.



## Installation in Vehicle

Check the vehicle belt or LATCH: lower anchor belt before each use. Use only if the belt can be tightened properly and locked securely in place.

Even when unoccupied, this child restraint must be firmly secured to the vehicle with a lower anchor belt or with the vehicle seat belt. In a crash or sudden stop, an unsecured child restraint could injure occupants.

## Vehicle Seating Position



Never place a child rear-facing in a seating position with an active frontal air bag.



Check the vehicle owner's manual for more information about air bag/child restraint use.



Use the child restraint only on vehicle seats that face forward.

Do not use on seats that face the sides or rear of the vehicle.

For vehicles without a back seat, refer to your vehicle owner's manual.

*continued on next page*



Children are safer when properly restrained in rear seating positions than in the front seating positions.

According to accident statistics, children in rear seating positions are statistically safer, whether you have air bags, advanced air bags, or no air bags at all.

**If you are not sure where to place the child restraint in your vehicle:** consult your vehicle owner's manual; contact Dorel Juvenile Group Consumer Care Department; or visit your local Child Passenger Inspection Station. Go to <http://www.safercar.gov/cpsApp/cps/index.htm> to find your closest station.

**To avoid your child being seriously burned, take the following precautions:**

1. Park in the shade or where sun does not directly hit the child restraint.
2. Cover the child restraint with a sheet or blanket when not in use.
3. Check for hot seat and buckles before placing child in child restraint.

To help protect your vehicle seat's upholstery from damage, use a single layer towel underneath and behind child restraint.

**1. If the child restraint buckle or harness release lever sticks or you cannot get the straps tight enough around child:**

**DO NOT LUBRICATE.** Check around lever and retractor for dropped food, sticky spilled drinks, dirt, leaves, etc. Clean with warm water and/or remove object with tweezers. If you cannot get the harness to adjust and remain tight with the buckle securely locked, do not use the child restraint.

**2. If your harness twists:**

Straighten the harness each time you put your child in the child restraint to help prevent twisting. Lock the buckle and tighten harness so it will be ready for next use.



Please complete the postage-paid registration card that came with your child restraint, and send it to us.

Child restraints could be recalled for safety reasons. You must register this restraint to be reached in a recall. Send your name, address, e-mail address if available and the restraint's model number and manufacturing date to:

### Dorel Juvenile Group

2525 State Street  
Columbus, IN 47201

or call 1-800-951-4113 or register online at:  
[www.djgusa.com/registration/carseat/us](http://www.djgusa.com/registration/carseat/us).

For recall information, call the U.S. Government's Vehicle Safety Hotline at 1-888-327-4236 (TTY: 1-800-424-9153), or go to <http://www.NHTSA.gov>.

Your Name		
Your Street Address		
City	State	Zip Code
Email Address (optional)		
Model Number	Model Name	Manufacture Date
AB123CDE	MAXI-COSI CAR SEAT	01/22/2015
		
L#11 B265035		

**Example of model number, line code, and manufacture date.**

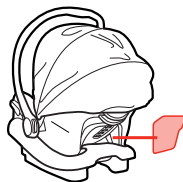

If you don't have the card or if your address changes, you will find the model number, manufacture date, and line code on the label located on the back of the shell.

Dorel Juvenile Group, Inc. (DJG) warrants this product to the original retail purchaser as follows: This product is warranted against defective materials or workmanship for one year from the date of original purchase. **An original receipt is required to validate your warranty.** DJG will, at its option, provide replacement parts or replace this product. DJG reserves the right to substitute if the part or model has been discontinued.

To make a claim under this warranty contact our Consumer Care Department by phone at 1-800-951-4113; or text us at 1-812-652-2525. Our hours of operation are from 8:00 a.m. to 6:00 p.m. EST Monday through Thursday and from 8:00 a.m. to 4:30 p.m. on Friday.

**Proof of purchase is required and shipping charges are the responsibility of the consumer.**

**Warranty Limitations:** This warranty does not include damages which arise from misuse or abuse of this product.

**Limitation of Damages:** The warranty and remedies as set forth are exclusive and in lieu of all others, oral or written, expressed or implied. In no event will DJG or the dealer selling this product be liable to you for any damages, including incidental or consequential damages, arising out of the use or inability to use this product.

**Limitation of warranties and other warranty terms and state law rights:** Any implied warranties, including implied warranties of the merchantability and fitness for a particular purpose, shall be limited to the duration and terms of the express written warranty. Some states do not allow limitations as to how long an implied warranty lasts or the exclusion or limitation of incidental or consequential damages, so the above limitations may not apply to you.

This warranty gives you specific legal rights, and you may have other rights, which vary from state to state. Neither DJG nor the dealer selling this product authorized any person to create for it any other warranty, obligation, or liability in connection with this product.

**Please note:** Our product warranty only applies when purchased from an authorized Maxi-Cosi retailer. The origin of products not purchased through these authorized retailers is unknown and could be counterfeit.

We cannot support products from an unknown origin as we cannot verify the handling or condition of such merchandise. We maintain a strong network of authorized retailers to ensure you are purchasing safe and complete products.

Fulfillment by a third party does not guarantee you are purchasing from one of these authorized retailers.

Pricing which is inconsistent with the majority of retailers is a strong indication that the retailer is not authorized, as we have a consistent price offering across all authorized retailers.

If you are unsure of the authorization status of a retailer you are considering purchasing from, or have purchased from, you can check [www.maxicosi.com/us-en/shops.aspx](http://www.maxicosi.com/us-en/shops.aspx); or call our Consumer Care Department at 1-800-951-4113; or text us at 1-812-652-2525.

## Replacement Parts List

Chest Clip	Lower Anchor Belt
Buckle Assembly	Harness Straps
Seat Pad Set	Instructions
Base	Locking Clip

**If requested color is not available, similar color will be substituted.**

**Applicable tax and shipping & handling will also be added.**

**For parts availability and questions,**

**Call:** 1-800-951-4113

**Text:** 1-812-652-2525

**Chat:** [www.maxicosi.com](http://www.maxicosi.com)

**If you already know which parts you need,** you may complete your order with a credit card by calling us at 1-800-544-1108.

**We accept Visa or MasterCard.**

**Hours of Operation:**

M-TH: 8:00 AM - 6:00 PM EST

FRI: 8:00 AM - 4:30 PM EST

## Dorel Juvenile Group Information

Thank you for choosing this car seat, also known as a child restraint. The DJG family is committed to creating car seats with the most comfort and convenience available today.

Remember, parents are a child's first teachers and examples. If you always buckle your seat belt, your child will think it is the natural thing to do. Make it a firm rule that the vehicle does not go until everyone is buckled up. Make no exceptions.

No one can predict if use of a car seat will prevent injury or death in a particular crash. However, when combined with careful driving, proper use of a car seat can lower a child's risk of injury or death in most crashes.

If you have questions or any concerns with this car seat, please contact our Consumer Care Department:

**Call:** 1-800-951-4113

**Text:** 1-812-652-2525

**Website:** [www.maxicosi.com](http://www.maxicosi.com)

**Hours of Operation:**

M-TH from 8:00 AM to 6:00 PM EST

FRI from 8:00 AM to 4:30 PM EST