

Replacement Parts List

(on select models)

- Buckle Assembly
 - ClipQuick™ Chest Clip
 - Seat Pad Set
 - Removable Cup Holder (1)
 - Lower Anchor Belt
 - Top Tether
 - Locking Clip
 - Instructions
- For parts availability and questions, call, text, or chat. If requested color is not available, similar color will be substituted.
- Applicable tax and shipping & handling will also be added.



Send Us a Text: 1-812-652-2525
(US and Canada Only. Carrier Fees May Apply)



Find Us Online: www.maxicosi.com
Email Us: support@djgusa.com



Give Us a Call: 1-800-951-4113
(Toll Free, US and Canada Only)





Pria Max All-in-One

Convertible Car Seat

Your model may look different than one shown on cover.

Read all instructions BEFORE USING this car seat.

KEEP INSTRUCTIONS FOR FUTURE USE.

 Failure to follow the warnings on the labels and in the instruction manual can result in serious injury or death to your child.

4358-8198 4.27.22

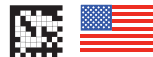

Welcome to the Maxi-Cosi Family!

Thank you for choosing this car seat, also known as a child restraint!

To help you get started using your child's new car seat, here are the 4 main tasks you'll need to complete.

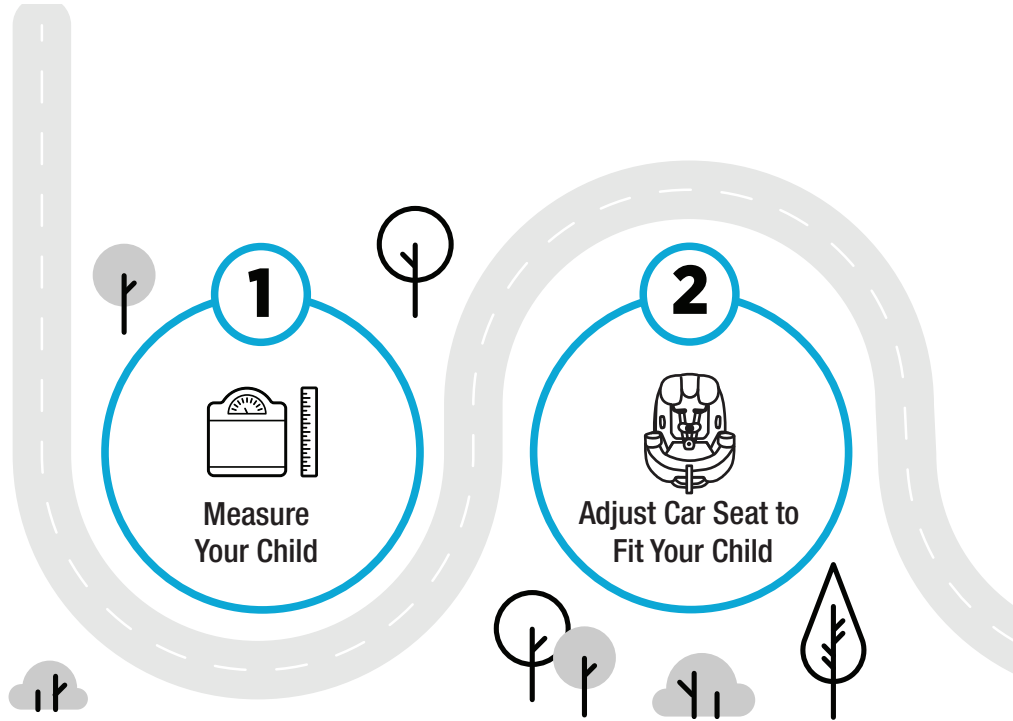

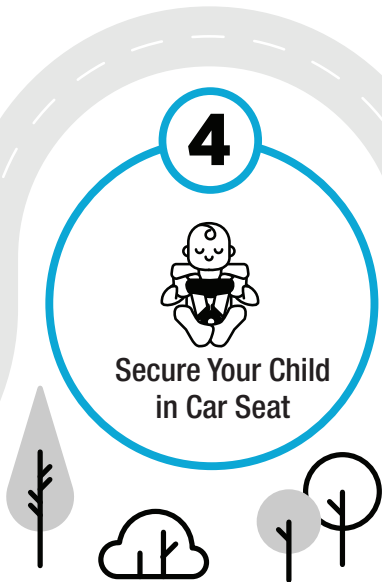
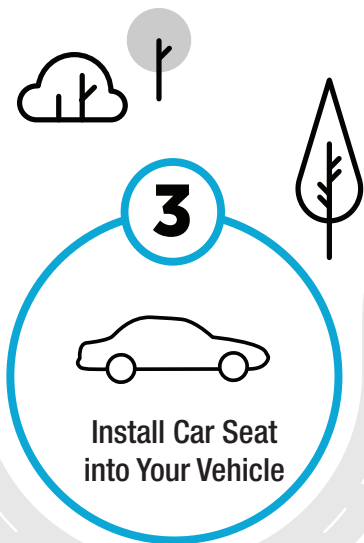

Your child's safety is worth the time it will take to read and follow these instructions.

Ready? Let's go!

Pages 1-4 will introduce you to the parts of the car seat.

The back cover of this manual and page 65 has our contact information.

If at any point you would like assistance, please feel free to reach out to us.

Contents

1 Getting Started

- 1 Parts of Car Seat
- 3 Accessory Use
- 5 Choosing Car Seat Mode

7 Rear-Facing Section

- 9 Rear-Facing Child Fit
- 12 Rear-Facing Vehicle Install

19 Forward-Facing Section

- 21 Forward-Facing Child Fit
- 23 Forward-Facing Vehicle Install

29 Securing Child in Car Seat

33 Booster Seat Section

- 35 Storing Harness System
- 39 Booster Seat Use in Vehicle
- 41 Booster Seat Child Fit

42 Making Adjustments to Car Seat

- 42 Changing Headrest/Harness Height
- 43 Changing Buckle Position
- 45 Buckle Adjustments for Smaller Infants
- 46 Reclining Car Seat

47 Wash & Care

47 Removing Seat Pad Set

51 Cleaning Parts of Car Seat & Installing Seat Pad Set

52 LATCH & Vehicle Belt Information

52 LATCH: Lower Anchor Belt

54 Vehicle Belts

58 Top Tether

59 Safety Information

59 Child Restraint Use

60 Vehicle Seating Position

61 Installation in Vehicle

62 Replacement & Expiration

63 Registration & Safety Notices

64 Aircraft Information

65 Warranty

©2022 Dorel Juvenile Group, Inc. (800) 951-4113 www.maxicosi.com. Styles and colors may vary. Les styles et les couleurs peuvent varier. Made in USA from American and imported parts (including seat pad). Fabriqué aux ÉTATS-UNIS. Distributed by (distribué par) Dorel Juvenile Group, Inc., 2525 State St., Columbus, IN 47201-7494. Dorel Juvenile Canada, 2233 Argentinia Road, Suite 110, Mississauga, ON L5N 2X7. Importado y Distribuido en Chile por: Comercial e Industrial Silfa S.A. - San Ignacio 0201 / Parque Industrial Portezuelo Quilicura, Santiago Chile. Fono (562) 2339 9000. En Perú por: Comexa S.A. - Los Libertadores 455 - San Isidro, Lima - Perú. Fono (511) 4469014. En Centro América, Caribe y Ecuador por: Best Brands Group S.A. - Av. Balboa, Bay Mall Plaza, Planta Baja, local 9, Panamá. - Fono: (507) 300 2884. En Colombia por: Baby Universe S.A.S. Vía 40 No. 77-29, Barranquilla, Colombia - Fono: (575) 353 1110 Importador: DJGM, S.A. DE C.V. Gabriel Mancera No. 1041 Col. Del Valle, Benito Juárez C.P. 03100 México, Ciudad de México R.F.C. DJG140305GN9 Tel. (55) 67199202



Parts of Car Seat

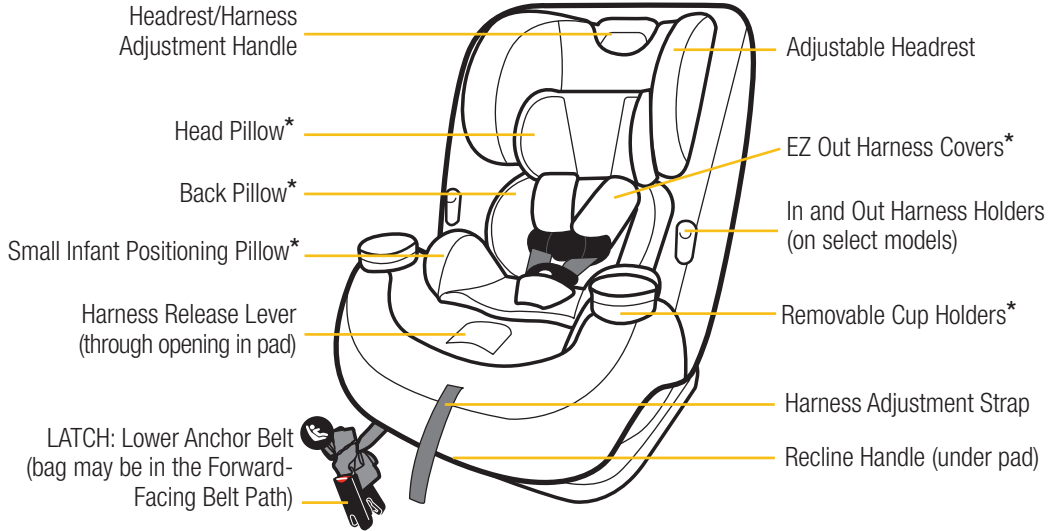

Your model may look different than one shown.

*See pages 3 - 4 for Accessory Use.

Harness System

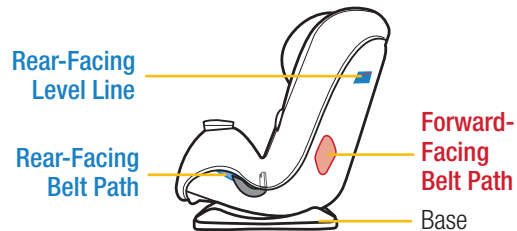
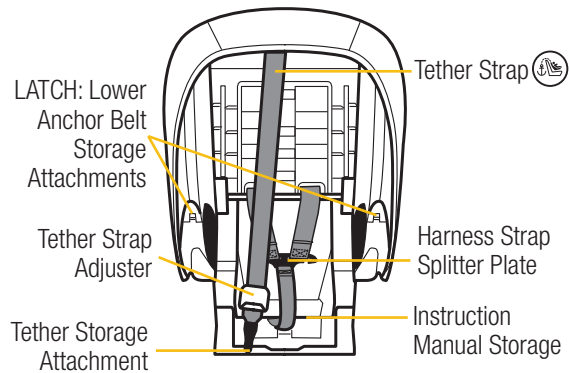
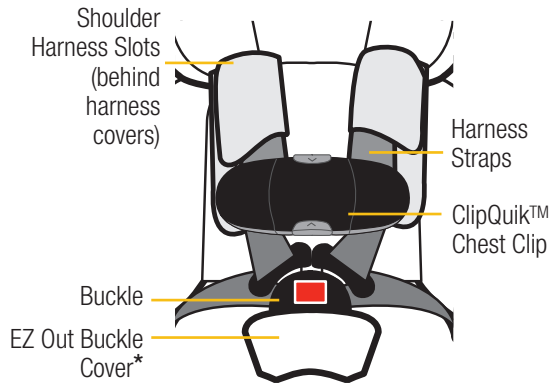

*See pages 3 - 4 for Accessory Use.

Accessory Use

3

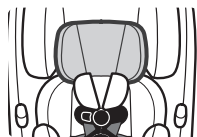

Head Pillow & Back Pillow

(on select models)

Only For Use in Rear-Facing Mode

The head and back pillows **MUST** be used together.



To remove head pillow, pull it out from behind the back pillow.

To remove back pillow, loosen the harness straps and slide pillow out from behind the harness straps.

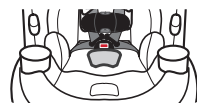

EZ Out Buckle Cover

To install, slide buckle into opening in front of buckle cover.

NOTE: Slide buckle cover only through slot in pad and **not** through buckle slot in shell. It lays flat underneath the pad as shown.



To remove, pull up on buckle cover and slide it off of the buckle and pull it out of the buckle slot in the seat pad.



Front View



Back View

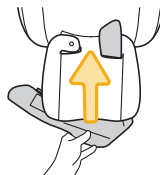

EZ Out Harness Covers

For Use in **Rear-Facing Mode** or **Forward-Facing Mode**

Harness covers help provide comfort to the neck. If the harness covers will not allow proper positioning of the chest clip or interfere with getting a tight enough harness fit for a smaller baby, remove and do not use.

Store until your child is large enough to use these harness covers while maintaining a properly fitting harness.

To remove, undo fasteners on headrest pad. Pull the fastening strips on covers apart. Pull harness straps out of covers.

Slide covers out from behind headrest pad.

To install, undo fasteners on headrest. With the back of the harness covers facing you slide covers behind headrest pad. Place harness straps into covers. Fasten harness covers.

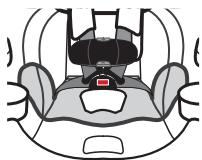

Small Infant Positioning Pillow

Only For Use in **Rear-Facing Mode**

When using the small infant positioning pillow, you must also

use the back and head pillows.

This pillow helps position your infant in the seat in order to achieve proper harness fit.

To determine if the pillow is needed:

1. Place headrest in lowest position.
2. Place infant in car seat without the pillow.
3. Make sure the infant's bottom and back are flat against the car seat.

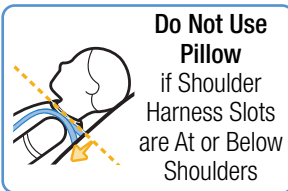
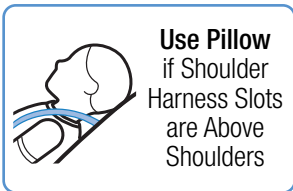

Check often to see how much your infant has grown.

Remove the infant pillow once they can sit in the car seat without the infant pillow and the harness slots are **at or below** their shoulders **AND** you can still achieve a snug harness fit.

To remove, lift the infant pillow up and pull the buckle & buckle cover down out of the buckle slot in the infant pillow.

To install, feed the buckle & buckle cover up into the 1st or 2nd buckle slot in the infant pillow, matching the buckle slot in the car seat.

To learn how to check buckle position, see page 11.

To learn how to check harness tightness, see pages 29-31.



Removable Cup Holder(s)
(on select models)

For Use in All Modes

The cup holder(s) is top-rack dishwasher safe.

To remove cup holder, twist the cup holder counterclockwise. Pull it out of the slot in the car seat.



Choosing Car Seat Mode

5

WARNING:

Measure your child's weight and height (**DO NOT** guess) before choosing this car seat's mode.

Your child's height, weight, and age determine how the car seat should be placed in the vehicle.

Children vary widely in body size, shape, and temperament—**please consult your doctor before switching between any modes within the limits and fit requirements of the car seat.**

State Laws

Please be certain to follow your state's laws regarding car seat use.

American Academy of Pediatrics Recommendations

Infants and Toddlers

Should ride in a rear-facing car seat as long as possible, until they reach the highest weight or height allowed by their car seat.

Toddlers and Preschoolers

Once they are facing forward, children should use a forward-facing car seat with a harness for as long as possible, until they reach the height and weight limits for their car seats.

School-Aged Children

Once they have outgrown their forward-facing car seat, children should use a belt-positioning booster seat until the vehicle's lap and shoulder seat belt fits properly. This is often when they have reached at least 4 feet 9 inches in height and are 8 to 12 years old.

Older Children

All children younger than 13 years should be restrained in the rear seats of vehicles for optimal protection.



Rear-Facing Mode

**4-40 lb (1.8-18 kg) and
19-40 in. (48-101.6 cm)**

**Rear-Facing Section
PAGE 7**

**Rear-Facing Child Fit
PAGE 9**

**Rear-Facing Vehicle Install
PAGE 12**



Forward-Facing Mode

**22-65 lb (10.1-29 kg) and
29-49 in. (73.6-125 cm) and
at least 1 year old**

**Forward-Facing Section
PAGE 19**

**Forward-Facing Child Fit
PAGE 21**

**Forward-Facing Vehicle Install
PAGE 23**



Booster Seat Mode

**40-100 lb (18.1-45.4 kg) and
43-52 in. (110.1-132.1 cm)**

**Booster Seat Section
PAGE 33**

**Storing Harness System
PAGE 35**

**Booster Seat Use in Vehicle
PAGE 39**

**Booster Seat Child Fit
PAGE 41**

Rear-Facing Section

7



4-40 lb (1.8-18 kg) and 19-40 in. (48-101.6 cm)

Children under 1 year of age **MUST** ride **Rear-Facing**.

In this car seat, your child can remain **Rear-Facing** until they outgrow any one of the following:

- **Weight Limit:** 40 lb (18 kg); **OR**
- **Height Limit:** 40 in. (101.6 cm); **OR**
- **Rear-Facing Child Fit** requirements, see page 9.

Before installing the car seat in your vehicle, check your child's fit in the car seat.

This way you won't have to redo the vehicle installation to make adjustments to the car seat.

Rear-Facing Child Fit: Page 9

Rear-Facing Vehicle Install: Page 12

WARNING:



NEVER install a rear-facing child restraint in the front seat of a vehicle equipped with an active frontal airbag.

DO NOT use the tether for rear-facing mode. Secure the tether strap hook to its storage attachment.

DO NOT use the lower anchor belt along with the vehicle lap or lap/shoulder belt.

DO NOT fasten multiple lower anchor hooks on the same lower anchor bar in the vehicle.

Check the vehicle belt or the lower anchor belt before each use. Use **ONLY** if the belt can be tightened properly and locked securely in place.

Even when unoccupied, this child restraint **MUST** be firmly secured to the vehicle with the lower anchor belt or with the vehicle seat belt.

This child restraint **MUST ALWAYS** face the rear of the vehicle until the child is at least 1 year old and weighs 22 lb (10 kg).

1

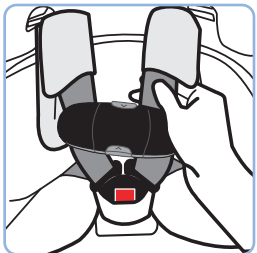

Fully Loosen Harness Straps

Place your hand between the harness cover & harness strap.

You may need to undo the harness cover or move the chest clip down.

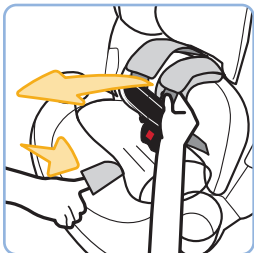

Push down on harness release lever (through opening in pad) while pulling out on harness straps as shown.

2

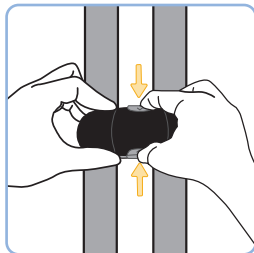

Release Chest Clip

Hold the chest clip with both hands and press in on the top and bottom buttons with your index finger and thumb as shown.



While holding the buttons in, pull the right (top) half of the clip apart from the left (bottom) half to release the magnet and separate the chest clip.

3

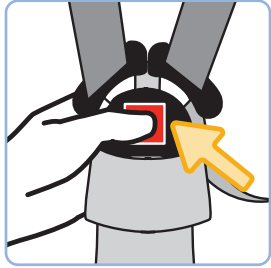

Undo Buckle

On select models: You may use the In and Out Harness Holders to place the harness straps out of the way.

4

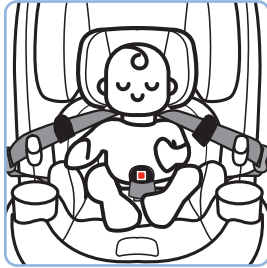

Place Child in Car Seat

Your child's bottom and back should be flat against the car seat.

5

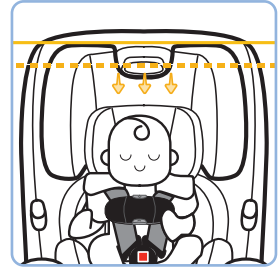

Check Head Position

The top of your child's head **MUST be at least 1 in. (2.5 cm) below** the top of the car seat's headrest.

continued on next page

6

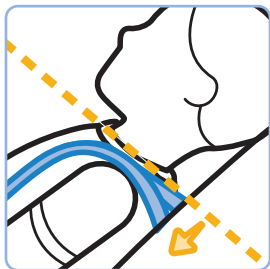

Check Harness Strap Position

The harness strap **MUST** be **at or slightly below** the shoulders; never above.

7

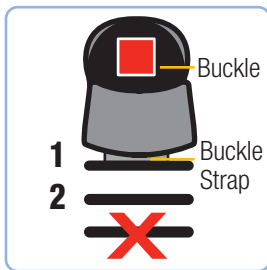

Check Buckle Position

- Use the slot closest to your child.
- The buckle **should not be underneath or behind** your child.

DO NOT use the 3rd buckle slot in **Rear-Facing Mode**.



To change the harness strap height, see page 42.

To change the buckle position, see page 43.

To learn how to check harness tightness, see pages 29-31.

If you cannot achieve a snug harness fit for your child, see page 45.

Rear-Facing Vehicle Install



Before installing the car seat in your vehicle, check to see if you need to adjust the buckle position for your child. **See page 9 for child fit.**

Once the car seat is installed, you will not be able to adjust the buckle position.

Review Vehicle Owner's Manual

Determine what kind of vehicle belts your car has and how to use them to lock a car seat in place **OR** where LATCH: lower anchor seating positions are located in your vehicle.

There are 2 different methods for install.

Use only one:



Vehicle Belt

OR



LATCH: Lower Anchor Belt

⚠ WARNING:

DO NOT use both the LATCH: lower anchor belt and vehicle belt at the same time to install the car seat.

continued on next page

1



Place Car Seat **Rear-Facing** in Back Seat

The car seat base **MUST** be flat on the vehicle seat.

2

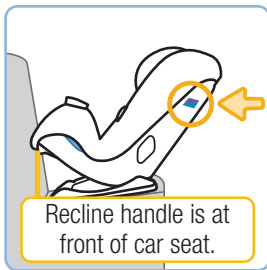

Recline handle is at front of car seat.

Recline Car Seat & Check **Rear-Facing Level Line**

i

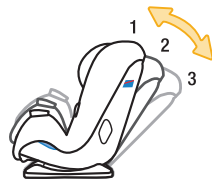

For children **who cannot sit up unassisted**, the **Rear-Facing Level Line** on the car seat **MUST** be parallel with the ground using either **Position 3 or 2**.

For children **who can sit up unassisted**, you may make the car seat more upright in **Position 2**.

3



OR

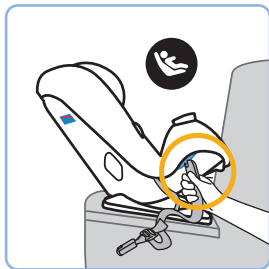

Locate **Rear-Facing Belt Path** & Route Vehicle Belt or Lower Anchor Belt Through It

For the LATCH belt: You may need to fully lengthen the belt before routing it into the belt path. Squeeze the adjuster button and pull the belt out as shown.

Thread the connector without the adjuster closest to it through the **Rear-Facing Belt Path** opening as shown.



4

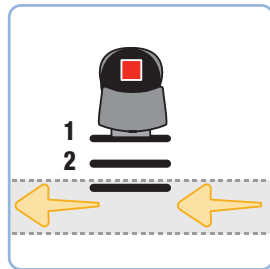

Vehicle Belt or Lower Anchor Belt Goes:

- under the car seat pad; **AND**
- across the car seat; **AND**
- in front of the buckle; **AND**
- out the other **Rear-Facing Belt Path** opening.

DO NOT twist the belt.

continued on next page

i



Adjuster

Finished Lower Anchor Belt Routing

The lower anchor belt adjuster **MUST** be on the child's right.

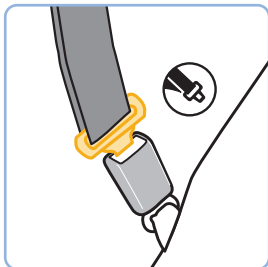

Buckle Vehicle Belt

If your car has a **switchable retractor**, use it to lock the vehicle belt. Review page 56 of this manual or your vehicle owner's manual.

5

OR

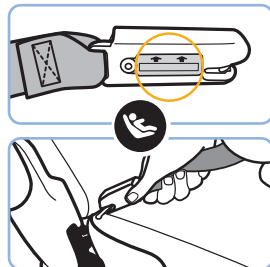

Attach Lower Anchor Belt Connectors to Vehicle's Lower Anchors

On select models: Make sure the arrows on the connectors are facing up.

Fasten one lower anchor belt connector to the anchor located in the vehicle seat.

Repeat for other side of car seat.

6

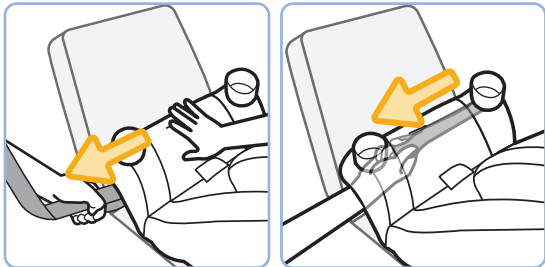

Tighten Belt

Place your hand in the car seat and firmly push the car seat down and back towards the vehicle seat. Pull the belt towards you and parallel (in line) with the belt path as shown.

For the LATCH belt or Lap Only Vehicle Belt: it may be easier to tighten if you route the free end of the belt back into the **Rear-Facing Belt Path**, reach into the **Rear-Facing Belt Path**, and pull the free end of the belt towards you.

7

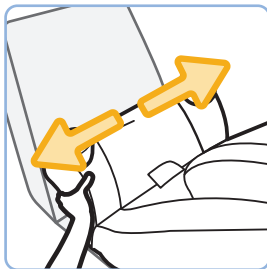

Check Belt Tightness

Hold the **Rear-Facing Belt Path** with your non-dominant hand. Push and pull the car seat from side to side.

The car seat should not move more than **1 in.** (2.5 cm).

i

If the car seat moves more than 1 in. (2.5 cm), you can try:

- Pulling the belt tighter; **OR**
- Reinstalling the car seat; **OR**
- Changing to a different seating location; **OR**
- Switching to a different install method (LATCH or vehicle belt).

continued on next page

8



Secure Child in Car Seat

See pages 29-31.

9

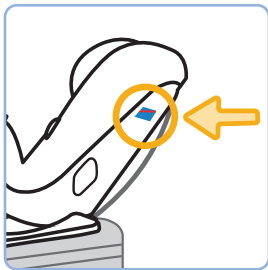

Recheck Rear-Facing Level Line

Redo the installation if the car seat is not reclined correctly for your child. See step 2 and info box on page 13.

i

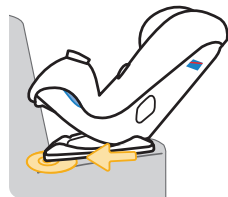

Only if necessary, you may place a tightly rolled towel(s) or foam pool noodle(s) under the front of the car seat base to help make the **Rear-Facing Level Line** parallel with the ground.

Check often to make sure padding is still in place and the belt is tight.

FINISHED!



Lap/Shoulder Belt

- Vehicle Belt Install:** Is the vehicle belt locked?
See step 5.



Lap Belt

- LATCH: Lower Anchor Belt Install:** Are the connectors securely attached to the vehicle's lower anchors?
See step 5.



LATCH: Lower Anchor Belt

- Is the belt tightened enough so that the car seat does not move more than 1 in (2.5 cm) from side to side? Check the tightness of the install often to make sure it has not loosened. See steps 6 and 7.
- If your child cannot sit up unassisted, is the **Rear-Facing Level Line** parallel with the ground? See steps 2, 8, 9, and info box on page 17.



22-65 lb (10.1-29 kg) and 29-49 in. (73.6-125 cm) and at least 1 year old

Children **MUST** be at least 1 year of age to ride **Forward-Facing**.

In this car seat, your child can remain harnessed **Forward-Facing** until they outgrow any one of the following:

- **Weight Limit:** 65 lb (29 kg); **OR**
- **Height Limit:** 49 in. (125 cm); **OR**
- **Forward-Facing Child Fit** requirements, see page 21.

Before installing the car seat in your vehicle, check your child's fit in the car seat.

This way you won't have to redo the vehicle installation to make adjustments to the car seat.

Forward-Facing Child Fit: Page 21

Forward-Facing Vehicle Install: Page 23

WARNING:

DO NOT use the lower anchors of the child restraint anchorage system (LATCH system) to attach this child restraint when restraining a child weighing more than 40 lbs (18 kg).

The vehicle belt **MUST** be used for installation if your child weighs more than 40 lb (18 kg).

When anchors are available, you **MUST ALWAYS** attach, adjust, and secure the tether (top anchorage) strap when installing the car seat in the Forward-Facing Mode with internal harness.

DO NOT use the lower anchor belt along with the vehicle lap or lap/shoulder belt.

Check the vehicle belt or the lower anchor belt before each use.

Use **ONLY** if the belt can be tightened properly and locked securely in place.

DO NOT fasten multiple lower anchor hooks on the same lower anchor bar in the vehicle.

Even when unoccupied, this child restraint **MUST** be firmly secured to the vehicle with the lower anchor belt or with the vehicle seat belt.

In this child restraint your child **MUST** be at least 1 year old and weigh 22 lb (10.1 kg) before they sit forward-facing.

Forward-Facing Child Fit

21

1

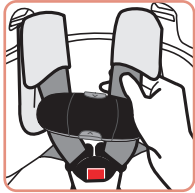

Fully Loosen Harness Straps

Place your hand between the harness cover & harness strap. You may need to undo the harness cover or move the chest clip down.

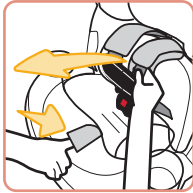

Push down on harness release lever (through opening in pad) while pulling out on harness straps as shown.

2

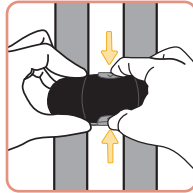

Undo Chest Clip

Hold the chest clip with both hands and press in on the top and bottom buttons with your index finger and thumb as shown. While holding the buttons in, pull the



right (top) half of the clip apart from the left (bottom) half to release the magnet and separate the chest clip.

3



Undo Buckle

4



Place Child in Car Seat

On select models: You may use the In and Out Harness Holders to place the harness straps out of the way.

Your child's bottom and back should be flat against the car seat.

5

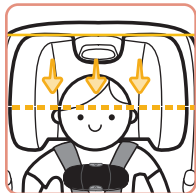

Head Position

The tops of your child's ears **MUST be below** the top of the car seat's headrest.

6

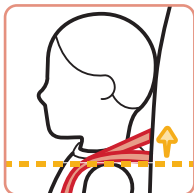

Harness Strap Position

The harness strap **MUST be at or slightly above** the shoulders; never below.

7

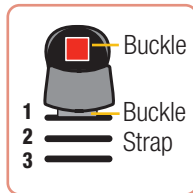

Buckle Position

- Use the slot closest to your child.
- The buckle **should not be underneath or behind** your child.

The buckle can be used in **any** buckle slot.

i

To change the harness strap height, see page 42.

To change the buckle position, see page 43.

To learn how to check harness tightness, see pages 29-31.

If you cannot achieve a snug harness fit for your child, see page 45.

Forward-Facing Vehicle Install

23

i

Before installing the car seat in your vehicle, check to see if you need to adjust the buckle position for your child. **See page 21 for child fit.**

Once the car seat is installed, you will not be able to adjust the buckle position.

Review Vehicle Owner's Manual

Determine what kind of vehicle belts your car has and how to use them to lock a car seat in place **OR** where LATCH: lower anchor seating positions are located in your vehicle.

There are 2 different methods for install.

Use only one:



Vehicle Belt

for children up to 65 lb (29 kg)

OR



LATCH: Lower Anchor Belt

for children up to 40 lb (18 kg)

! WARNING:

DO NOT use both the LATCH: lower anchor belt and vehicle belt at the same time to install the car seat.

When anchors are available, you **MUST ALWAYS** attach, adjust, and secure the tether (top anchorage) strap when installing the car seat in the Forward-Facing Mode with internal harness.

1



Put Car Seat into Position 1 & Place Car Seat Forward-Facing in Back Seat

The vehicle seat back **MUST** be upright.

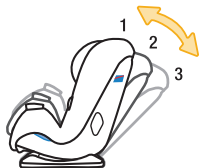

Only use semi-reclined **Position 2** if necessary to install the car seat flush against the vehicle seat back.

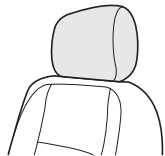

If your vehicle has a headrest that interferes with a flush car seat fit, check your vehicle owner's manual to see if it can be removed, adjusted, or if there are other possible seating locations for you to install.

2



Locate Vehicle Top Tether Anchors

Review your vehicle owner's manual for top tether anchor locations and how to route the tether strap when there are vehicle headrests.

3

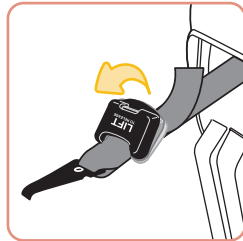

Lift Tether Adjuster to Loosen Tether Strap

continued on next page

4

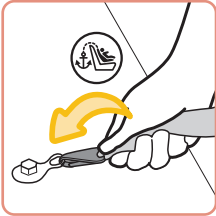

Loosely Attach
Tether Hook to
Vehicle's Top
Tether Anchor

5

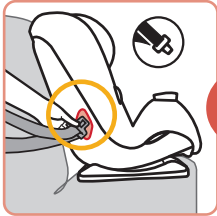

OR



Locate **Forward-Facing Belt Path** & Route
Vehicle Belt or Lower Anchor Belt Through It

For the **LATCH belt**: You may need to fully lengthen the belt before routing it into the belt path. Squeeze the adjuster button and pull the belt out as shown.

Thread the connector with the adjuster closest to it through the **Forward-Facing Belt Path** opening as shown.



6

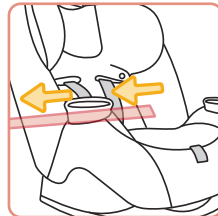

Vehicle Belt or Lower
Anchor Belt Goes:

- under the car seat pad; **AND**
- across the car seat; **AND**
- out the other **Forward-Facing Belt Path** opening. **DO NOT** twist the belt.

i



Adjuster

Finished Lower
Anchor Belt
Routing

The lower anchor belt adjuster **MUST** be on the child's left.

7

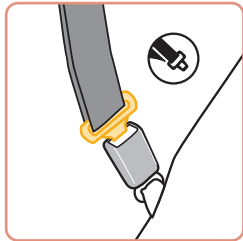

Buckle Vehicle Belt

If your car has a **switchable retractor**, use it to lock the vehicle belt. Review page 56 of this manual or your vehicle owner's manual.

OR

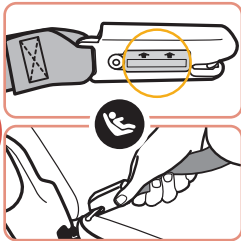

Attach Lower Anchor Belt Connectors to Vehicle's Lower Anchors

On select models: Make sure the arrows on the connectors are facing up.

Fasten one lower anchor belt connector to the anchor located in the vehicle seat bight.

Repeat for other side of car seat.

8

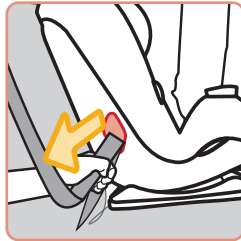

Tighten Belt

Place your hand in the car seat and firmly push the car seat down and back towards the vehicle seat. Pull the belt towards you and parallel (in line) with the belt path as shown.

For the LATCH belt or Lap Only Vehicle Belt: it may be

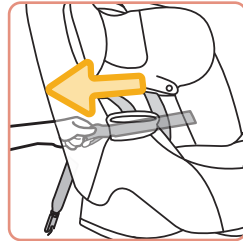

easier to tighten if you route the free end of the belt back into the **Forward-Facing Belt Path**, reach into the **Forward-Facing Belt Path**, and pull the free end of the belt towards you.

continued on next page

9

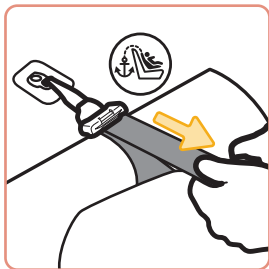

Tighten Tether

Push firmly on the back of the car seat and pull the free end of the tether strap to remove all of the slack.

10

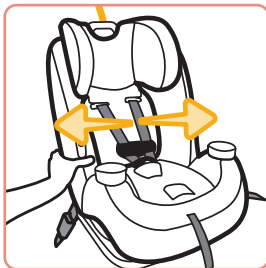

Check Belt Tightness

Hold the **Forward-Facing Belt Path** with your non-dominant hand. Push and pull from side to side.

The car seat should not move more than **1 in.** (2.5 cm).

i

If the car seat moves more than **1 in.** (2.5 cm), you can try:

- Pulling the belt tighter; **OR**
- Reinstalling the car seat; **OR**
- Changing to a different seating location; **OR**
- Switching to a different install method (LATCH or vehicle belt).

FINISHED!



Lap/Shoulder Belt + Tether
for children up to 65 lb (29 kg)



Lap Belt + Tether
for children up to 65 lb (29 kg)



LATCH: Lower Anchor Belt + Tether
for children up to 40 lb (18 kg)



Vehicle Belt Install: Is the vehicle belt locked?
See step 7.



LATCH: Lower Anchor Belt Install: Are the connectors securely attached to the vehicle's lower anchors? See step 7.



Is the belt tightened enough so the car seat does not move more than 1 in (2.5 cm) from side to side? Check the tightness of the install often to make sure it has not loosened. See steps 8 & 10 and info box on page 27.



Has the tether been installed and tightened? See steps 4 and 9.

WARNING:

**IMPLANTED
ELECTRONIC
MEDICAL
DEVICES**

Do not use this chest clip with children who have an implanted electronic medical device.

A magnet is used to help secure the chest clip locking mechanism together which may interfere with the proper function of an implanted electronic medical device.

Parents or caregivers who have an implanted electronic device should keep their device away from the chest clip and consult their doctor and medical device manufacturer for specific information before using this chest clip.

If a parent/caregiver or child has an implanted electronic medical device, please contact Dorel (see back cover) for a replacement (non-magnetic) chest clip free of charge.

1

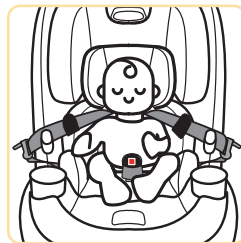

Place Child in Car Seat

Your child's bottom and back should be flat against the car seat.

2

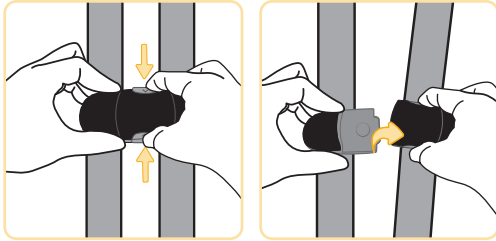

Fasten Chest Clip

Lay the right (top) half of the chest clip over the left (bottom) half and it will automatically snap together and lock.

Pull gently on each half of the chest clip together to make sure it is locked.

3

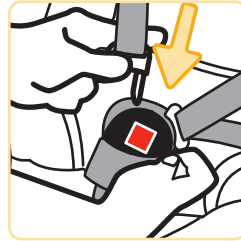

Buckle Harness

Pull the harness straps up to make sure the buckle is locked.

4

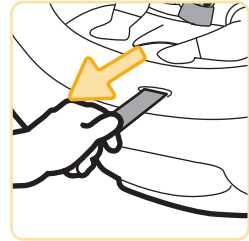

Tighten Harness

Pull the harness adjustment strap straight out to snugly tighten the harness.

continued on next page

5

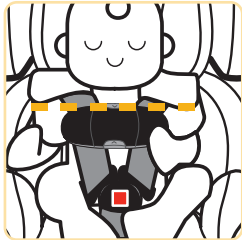

Position Chest Clip

Slide the chest clip up the harness straps and position it at mid-chest (even with armpits) and away from your child's neck.

6

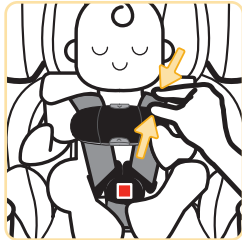

Check Harness Tightness

Unfasten the harness covers.

Try to pinch the harness at the shoulders vertically between index finger and thumb as shown.

If your fingers slip off, the harness is tight enough.

If you can pinch the harness strap, tighten more.

Fasten the harness covers.

i

A snug strap should not allow any slack.

It lies in a relatively straight line without sagging.

It does not press on the child's flesh or push the child's body into an unnatural position.

FINISHED!



Your child is now secured in the car seat.

Check your child's fit often and make any needed adjustments to the car seat as they grow.

To Remove Child from Car Seat:

1. Loosen Harness Strap
2. Unbuckle Harness
3. Release Chest Clip
4. Remove Child

Clean with warm water and/or remove the object with tweezers. If you cannot get the harness to adjust and remain tight with the buckle securely locked, **DO NOT** use this car seat.

Troubleshooting

1. If the buckle or harness release lever sticks: DO NOT lubricate. Check for dropped food, sticky spilled drinks, dirt, leaves, etc.

2. If your harness twists: Straighten the harness each time you put your child in the car seat. Lock the buckle and tighten the harness so it will be ready for next use.

! WARNING:

Failure to fasten and tighten the harness system correctly may allow the child to be ejected from the child restraint in a crash or sudden stop causing serious injury or death.

DO NOT mistake comfort for safety. The harness system **MUST** be snugly adjusted.



DO NOT put snowsuits or bulky garments on your child when placing them in the child restraint.

Bulky clothing can prevent the harness straps from being tightened properly.



40-100 lb (18.1-45.4 kg) and 43-52 in. (110.1-132.1 cm)

In this car seat, your child can remain in a **Booster Seat** until they outgrow any one of the following:

- **Weight Limit:** 100 lb (45.4 kg); **OR**
- **Height Limit:** 52 in. (132.1 cm); **OR**
- **Booster Seat Child Fit** requirements, see page 41.

You **MUST** store the harness system and remove the accessories, except the cup holder(s), when using the **Booster Seat Mode**.

To remove accessories, see pages 3-4.

Storing Harness System: Page 35

Booster Seat Use in Vehicle: Page 39

Booster Seat Child Fit: Page 41

! WARNING:

DO NOT use the harness system when using as a booster seat.

DO NOT use LATCH when using as a booster seat. Secure the lower anchor belt and the tether strap to their storage attachments.

Use **ONLY** the vehicle's lap and shoulder belt system when restraining the child in this booster seat.

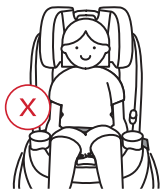

DO NOT use only the lap belt when using this seat as a booster seat. The shoulder belt **MUST** always be adjusted snugly across the child's chest.

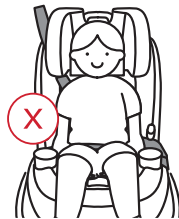

NEVER place shoulder belt under the child's arms or behind their back.

DO NOT use this booster seat if the tops of your child's ears are above the top of the booster seat's headrest.

Storing Harness System

1

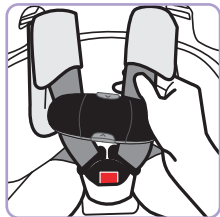

Fully Loosen Harness Straps

Place your hand between the harness cover and harness strap.

You may need to undo the harness cover or move the chest clip down.

2

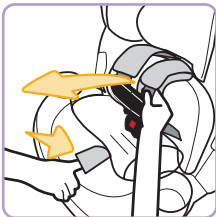

Push down on harness release lever (through opening in pad) while pulling out on harness straps as shown.

3

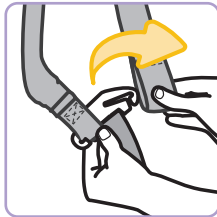

From Back of Seat, Remove Harness Strap Loops From Splitter Plate

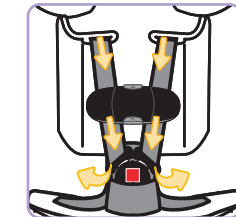

Unthread Harness

Unthread the harness strap from the harness slots, chest clip & buckle.

4

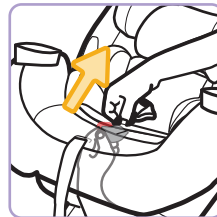

Recline Car Seat

Reach under the car seat. Rotate the buckle's metal retainer and push it up through the car seat.

5

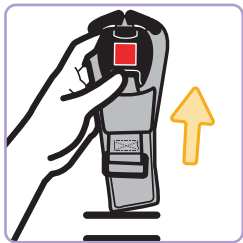

Pull Buckle with Buckle Tongues & Buckle Cover Out of Car Seat

Store the buckle with buckle tongues, buckle cover & chest clip in a safe place for future use.

6

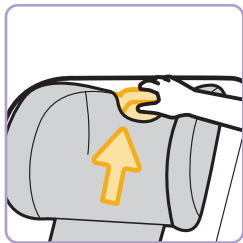

Adjust Headrest to Highest Position

7

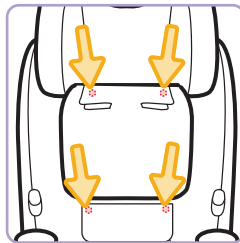

On Select Models: Undo Fasteners on Headrest Pad & Seat Pad

8

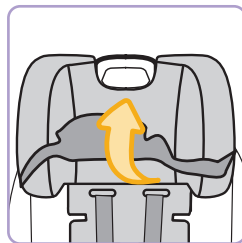

Pull Headrest Pad Off Bottom of Headrest

i

If the harness straps have been removed from the splitter plate, chest clip & buckle, follow steps 9-11 on this page and steps 11-12 to rethread them.

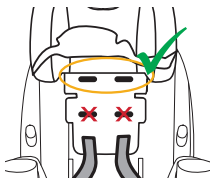

DO NOT use the lower shoulder harness slots.

9

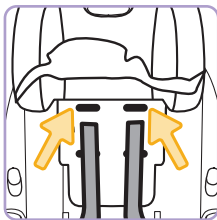

Rethread Harness Straps into the Top Shoulder Harness Slots

DO NOT use the lower shoulder harness slots.

10

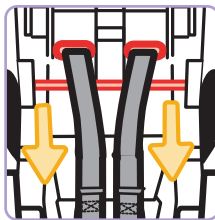

From Back of Seat, Thread Harness Straps Over Metal Bar

DO NOT twist harness straps.

11

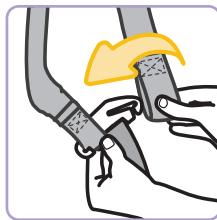

Attach Harness Strap Loops to Splitter Plate

i

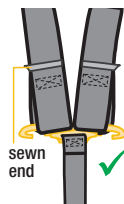

The sewn ends of the harness strap loops **MUST** face towards you.

DO NOT twist the harness strap or the harness adjustment strap.

Make sure the same harness strap loops are fitted completely on both sides of the splitter plate.

12

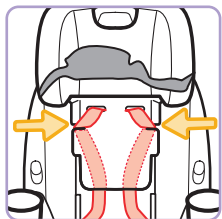

Thread Harness Straps into Slots on Sides of Headrest

13

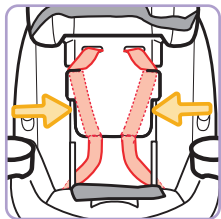

Place Harness Straps Behind Headrest

14

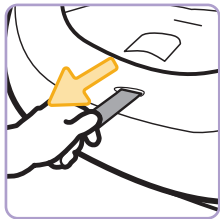

Tighten Harness
Remove any slack from the harness system.

15

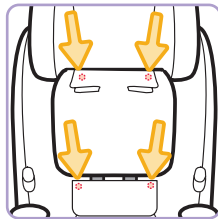

Wrap Headrest Pad Around Bottom of Headrest

On select models:
Attach the fasteners on the headrest pad and the seat pad.

FINISHED!

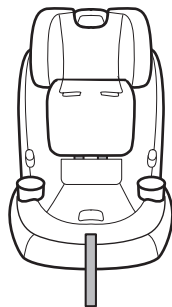

The car seat has been converted to the **Booster Seat Mode**.

See next page for **Booster Seat Use in Vehicle**.

1



Recline handle is at front of car seat.

Put Booster Seat into Position 1

The vehicle seat back **MUST** be upright.

i

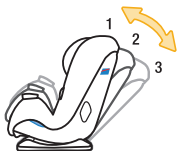

Only use semi-reclined **Position 2** if necessary to install the booster seat flush against the vehicle seat back.



If your vehicle has a headrest that interferes with a flush car seat fit, check your vehicle owner's manual to see if it can be removed, adjusted, or if there are other possible seating locations for you to install.

2

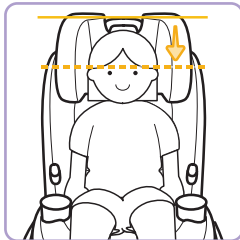

Have Child Sit in Booster Seat

The tops of your child's ears should never be above the top of the booster seat's headrest.

3

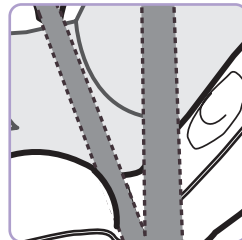

Position Lap Belt on Child

Route the lap belt portion of the vehicle belt through the **Booster Seat Belt Path** as shown. The lap belt should lay snugly across your child's hips; not on their stomach.

4



Buckle Vehicle Belt

Pull the lap belt up to tighten.

5

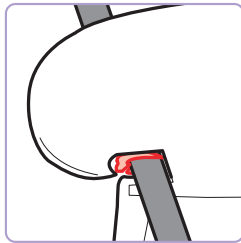

Position Shoulder Belt on Child

Thread the shoulder belt through the belt-positioning guide in the headrest.

Pull the shoulder belt up to tighten so that it lies snugly across the center of your child's shoulder and across their chest.



For models with In and Out Harness Holders:

The shoulder belt should lay under the In and Out Harness Holder.

For models without In and Out Harness Holders:

The shoulder belt will fall naturally into place.

FINISHED!



Check periodically to make sure your child has not moved out of position and loosened the shoulder belt.



Keep the booster seat securely belted even when unoccupied.

To rethread harness strap, see info box & step 10 on page 49 and also steps 11-12 & info box on page 50.

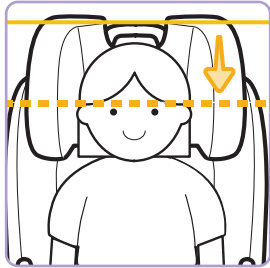

Head Position

The tops of your child's ears should **never be above** the top of the booster seat's headrest.

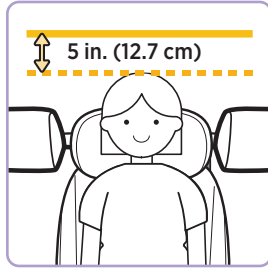

Car Position

DO NOT use the booster seat if your child's head is less than 5 in. (12.7 cm) below the roof of the car. Consult your vehicle manual for proper seatbelt usage.



Shoulder Belt Position

The shoulder belt should lay snugly across the center of your child's shoulder and across their chest.

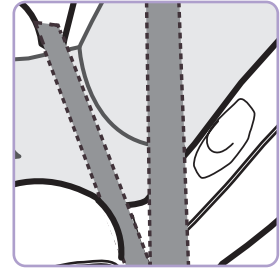

Lap Belt Position

The lap belt should lay snugly across your child's hips; **not on their stomach.**

Changing Headrest/Harness Height

1

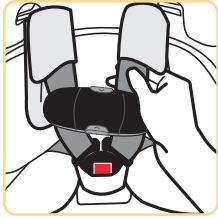

Fully Loosen Harness Straps

Place your hand between the harness cover and harness strap.

You may need to undo the harness cover or move the chest clip down.

1

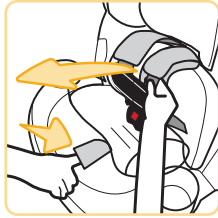

Push down on harness release lever (through opening in pad) while pulling out on harness straps as shown.

2

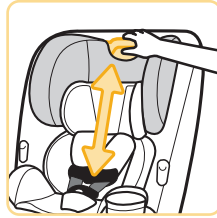

Adjust Headrest/Harness Height

1. Squeeze the adjustment handle up.
2. Move the headrest up or down to the proper height for your child.

3. Release the handle to lock in place.
4. Make sure it is locked securely.

i

For Rear-Facing Child Fit, see page 9.

For Forward-Facing Child Fit, see page 21.

To learn how to check harness tightness, see pages 29-31.

If you cannot achieve a snug harness fit for your child, see page 45.

Check the harness straps often for any wear or damage.

Changing Buckle Position

43

WARNING:

Failure to place buckle's metal retainer completely through pad and child restraint can result in serious injury or death.

1

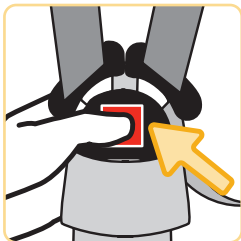

Undo Buckle

It may be easier to undo the buckle by pressing in towards the top of the button.

2

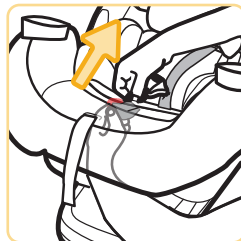

Recline Car Seat

Reach under the car seat. Rotate the buckle's metal retainer and push it up through the car seat.

3



**From Top of Car Seat,
Pull Buckle &
Buckle Cover Out of
Car Seat & Pad**

4

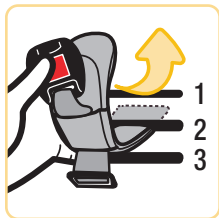

Slide Buckle Cover into Seat Pad Slot Closest to Child

5

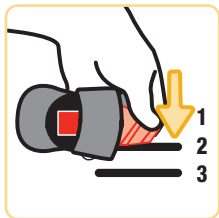

Insert Buckle's Metal Retainer into Buckle Slot Closest to Child

Tuck the ends of the buckle cover into the same pad slot as the buckle.

6

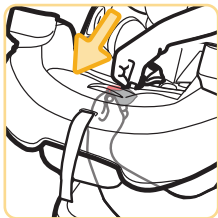

Reach Under Car Seat Between Base & Car Seat

Pull the buckle's metal retainer completely through the seat pad & car seat.

7

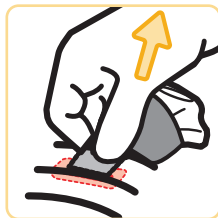

Check Buckle

Pull the buckle up to make sure it is secured.

The buckle **MUST NOT** pull out.

i

For Rear-Facing Child Fit, see page 9.

For Forward-Facing Child Fit, see page 21.

To learn how to check harness tightness, see pages 29-31.

If you cannot achieve a snug harness fit for your child, you may need to adjust the buckle strap length and location as shown on page 45.

Buckle Adjustments for Smaller Infants

1

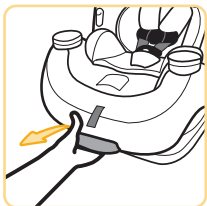

With Buckle in 1st Slot, Fully Recline Car Seat

If you need to move the buckle to the 1st slot, see pages 43-44.

2

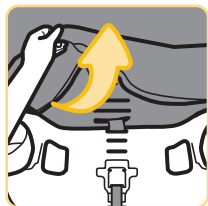

Pull Front of Car Seat Pad Up

3

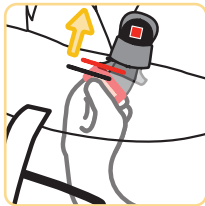

Reach Under Car Seat

Pull the buckle's metal retainer down and then push it up into the middle slot as shown.

4

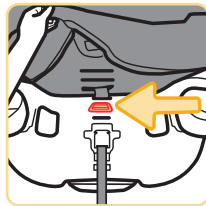

From Top of Car Seat, Lay Metal Retainer Flat Against Car Seat

5

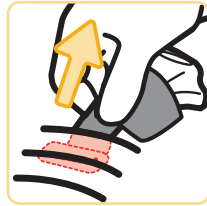

Tuck Car Seat Pad Around Front of Car Seat & Check Buckle

Pull the buckle up to make sure it is secured. The buckle **MUST NOT** pull out.

⚠ WARNING:

The harness system **MUST** be installed correctly. **DO NOT** use a child restraint with damaged harness straps.

Reclining Car Seat

This car seat has 3 positions.

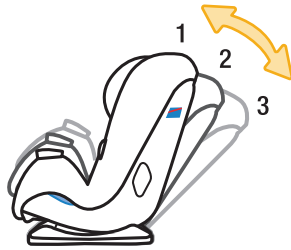

Rear-Facing Mode - 3 Reclined or 2 Semi-reclined

For children **who cannot** sit up unassisted, the **Rear-Facing Level Line** on the car seat **MUST** be parallel with the ground using either **Position 3** or **2**.

For children **who can** sit up unassisted, you may make the car seat more upright in **Position 2**.

Forward-Facing Mode - 1 Upright or 2 Semi-reclined*

Booster Seat Mode - 1 Upright or 2 Semi-reclined*

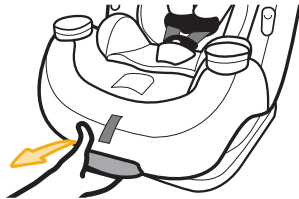

To Recline: Pull the recline handle out and push the top of the car seat back.

For More Upright: Pull the recline handle out and pull the top of the car seat forward.

i

*When used in **Forward-Facing Mode** or **Booster Seat Mode**, semi-reclined **Position 2** is **ONLY** to be used **if necessary** to install the car seat flush against the vehicle seat back.

The vehicle seat back **MUST** be upright.

Removing Seat Pad Set

i

You do not need to remove the harness system to remove the pad from the car seat.

DO NOT fully pull the harness strap out of the car seat. Leave it threaded in the hip harness slots. If removed, you will not be able to rethread it.

To remove accessories, see pages 3-4.

1

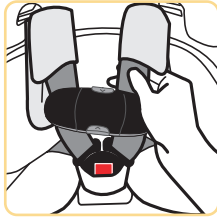

Fully Loosen Harness Straps

Place your hand between the harness cover and harness strap.

You may need to undo the harness cover or move the chest clip down.

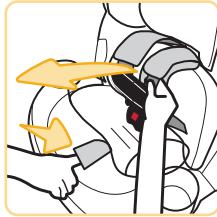

Push down on harness release lever (through opening in pad) while pulling out on harness straps as shown.

2

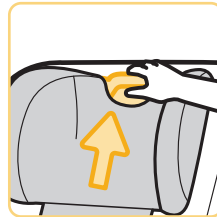

Adjust Headrest to Highest Position

3

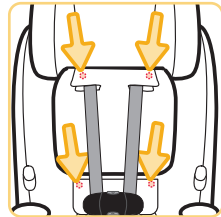

On Select Models: Undo Fasteners on Headrest Pad & Seat Pad

4

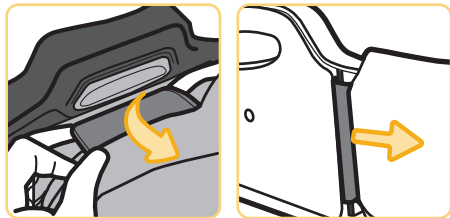

Locate Pad Fabric Tab Slots in Headrest

Pull the fabric tabs out of the slots in the headrest as shown.

5

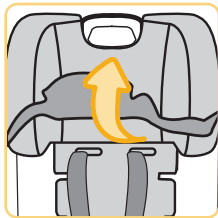

Gently Pull Headrest Pad Off Bottom of Headrest

6

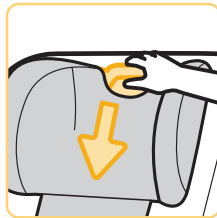

Lower Headrest to Middle of Car Seat

7

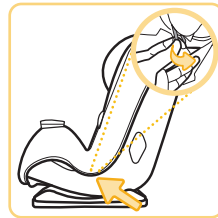

Locate Seat Pad Tabs on Sides of Seat

Release elastic straps
from tabs.

continued on next page

8

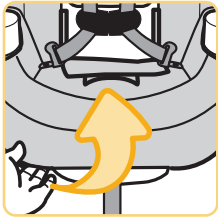

**Pull Seat Pad Off
Sides & Front of
Car Seat**

9

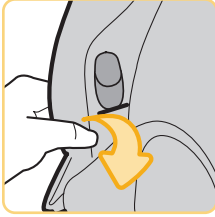

**Pull Pad Down &
Off of In & Out
Harness Holders
(on select models)**

10

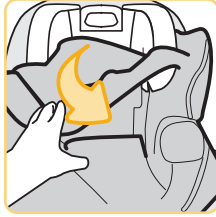

**Pull Seat Pad
Around Headrest
& Off of Car Seat**

i

If the harness straps have been removed from the splitter plate, chest clip & buckle, follow step 11 on this page and steps 12-13 & info box on page 50 to rethread them.

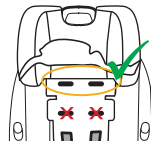

DO NOT use the lower shoulder harness slots.

11

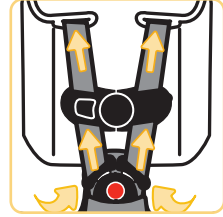

Rethread Harness

Thread the harness strap into the buckle, chest clip, & shoulder harness slots.

The harness strap ends go through the **back** of the buckle tongues & through the chest clip **front to back**.

12

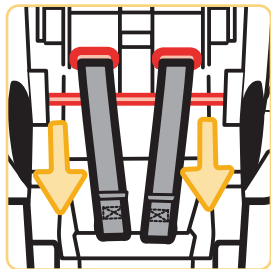

From Back of Car Seat,
Thread Harness Straps
OVER Metal Bar

13

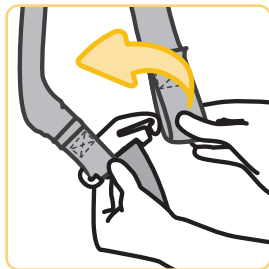

Attach Harness Strap
Loops to Splitter Plate

i

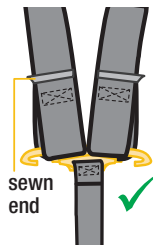

The sewn ends of the harness strap loops **MUST** face towards you.

DO NOT twist the harness strap or the harness adjustment strap.

Make sure the same harness strap loops are fitted completely on both sides of the splitter plate.

Cleaning Pad & Accessories

Machine wash separately with cold water on a gentle cycle. Make sure the harness covers are closed so the fastening strips are not exposed. **DO NOT** use bleach. Tumble dry separately for 10-12 minutes on low heat. Remove immediately.

Cleaning Harness Strap

Check the harness straps often for any wear or damage. Spot clean using warm sudsy water and damp cloth. Spilled food and liquids on the car seat may result in mold or bacterial growth over time. These spills could also attract insects or rodents.

Cleaning Buckle & Car Seat

Spot clean using warm sudsy water and damp cloth. **DO NOT** submerge into water.

Installing Seat Pad Set

1. Lower Headrest to Middle of Car Seat
2. Pull Seat Pad Around Headrest and onto Car Seat
3. On Select Models: Pull Seat Pad Down & Around In & Out Harness Holders
4. Pull Headrest Pad onto Headrest
5. Push Headrest Pad Fabric Tabs into Slots in Headrest
6. On Select Models: Attach All Pad Fasteners

WARNING:

DO NOT fully pull the harness strap out of the car seat. Leave it threaded in the hip harness slots. If removed, you will not be able to rethread it. **DO NOT** use the child restraint without the seat pad or with damaged harness straps.

LATCH: Lower Anchor Belt

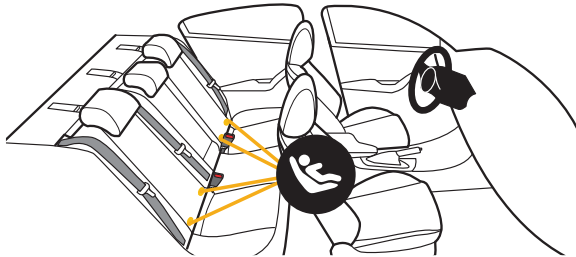

Your vehicle's features may be considerably different than those pictured here.

The lower anchors of **LATCH** (**L**ower **A**nchors and **T**ethers for **C**hildren) is a universal system for installing car seats without using vehicle seat belts. The LATCH: lower anchor belt can **ONLY** be used in vehicles that have the lower anchor bars installed in designated seating positions. Most vehicles manufactured after September 2002 are equipped with LATCH: lower anchor bars. Check your vehicle owner's manual to see which seating positions may be equipped with LATCH: lower anchor bars.



Lower Anchor Belt Storage Location

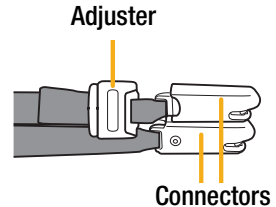

Lower Anchor Belt Parts

To Remove Lower Anchor Belt from Storage Location on Car Seat

Press the release button on each connector, then pull the connectors off of storage attachments.

continued on next page

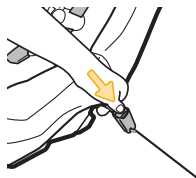
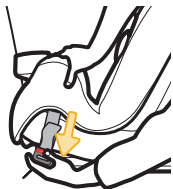

To Remove Lower Anchor Belt from Vehicle's Lower Anchor Bars

1. Remove the tension from the belt by pushing down on the side of the car seat with the adjuster.
2. Then press the adjuster's button to loosen the belt.
3. Press the release button on each connector, then pull the connectors out of the vehicle seat.

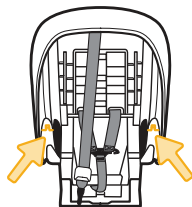

To Store Lower Anchor Belt

The lower anchor belt **MUST** be properly stored in its storage location when:

- using the vehicle belts to install the car seat; **OR**
- using the **Booster Seat Mode**; **OR**
- the car seat is not installed in a vehicle.

Secure the connectors to the attachments in the storage location as shown. Gently tighten the belt to remove slack.

WARNING:

DO NOT use both the lower anchor belt and vehicle belt at the same time.

Vehicle Belts

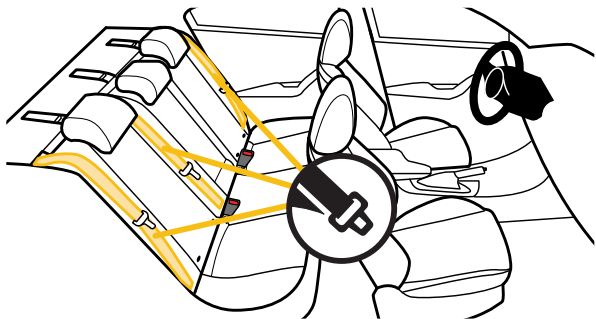

Your vehicle's features may be considerably different than those pictured here.

If LATCH: lower anchors are not an option or if your child weighs more than **40 lb** (18 kg), you **MUST** use the vehicle seat belt system to install the car seat.

Not all vehicle belts and seating positions will work with car seats. Please go through the following steps to understand how to lock a car seat in [Rear-Facing Mode](#) or [Forward-Facing Mode](#) with a vehicle belt.

1



You MUST Review Your Vehicle Owner's Manual

Your vehicle owner's manual will let you know which vehicle belts and seating positions car seats can be installed in.

continued on next page

2



Check How This Car Seat Will Be Locked Into Place

The vehicle belt **MUST NOT** loosen after tightening.

This means there needs to be a way to lock the vehicle belt.

The ways this can be done are:

- By using the seat belt's retractor (see step 3); **OR**
- By using the seat belt's latch plate (see step 4).

3

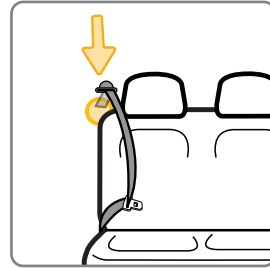

Check Retractor

Retractors pull seat belts into stored positions and lock the belt to hold passengers in place.

See the next page for some common types of vehicle belt retractors that will work with this car seat.

Types of Retractors



Switchable Retractor

(most vehicles have this type)

This retractor can be switched to a locking mode.

You **MUST have the retractor in the locking mode** to use the seat belt with this car seat.

Switching to locking mode: Slowly pull the shoulder belt all the way out, then let it go back in **1-2 in.** (2.5-5 cm).

As it goes back in, you will most likely hear a ratcheting sound.

Gently pull the belt to see if it has locked. You will not be able to pull any more belt out if the lock has engaged.



Automatic Locking Retractor

This retractor always locks.

It will automatically lock after slowly pulling the seat belt out at least halfway and letting the belt go back into the retractor **1-2 in.** (2.5-5 cm).



Emergency Locking Retractor

See Step 4

“Check Latch Plates”

If the retractor does not lock, it is most likely an Emergency Locking Retractor. These retractors only lock during a sudden stop or collision.

You will need to determine if your seat belt's latch plate can lock the belt. See step 4, “Check Latch Plates”.

continued on next page

4

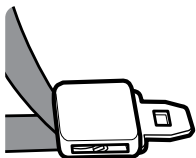

Locking
Latch Plate

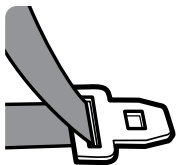

Emergency
Locking
Retractor with
a Sliding
Latch Plate

Check Latch Plates

Latch plates are the part of the seat belt that goes into the buckle.

To see if the latch plate locks:

1. Buckle Vehicle Belt
2. Firmly Tug Lap Portion of Seat Belt While Pulling It Up

If the vehicle belt does not slide through the latch plate, it's locked.

If the latch plate slides up and down the vehicle belt, it is a **sliding latch plate**.

Sliding latch plates easily slip between the lap and shoulder portions of the belt.

i

If you have an Emergency Locking Retractor with a Sliding Latch Plate, you **MUST** use a locking clip.

Please contact us for one, see the back cover of the manual.

Never Use the Following With This Car Seat:

- Emergency Locking Retractor Lap Only Belt
- Inflatable Seat Belts

Top Tether

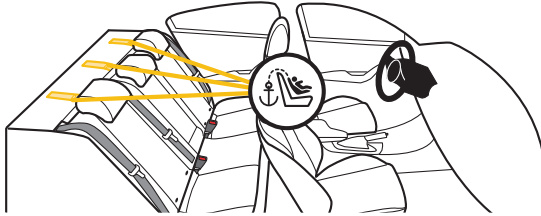

Your vehicle's features may be considerably different than those pictured here.

When anchors are available, you **MUST always attach, adjust, and secure the tether (top anchorage) strap** when installing the car seat in the **Forward-Facing Mode** with internal harness. Tethers improve the installation and stability of car seats and reduce the risk of injury. Attach the tether hook to the tether anchor designated by your vehicle manufacturer for that seating position. Check your vehicle owner's manual for more information. If the seating position does not have a tether anchor, use a different seating position or see your dealer or a qualified mechanic and have one installed.

! WARNING:

Using this child restraint without the tether strap anchored as required by the manufacturer would be a misuse of the child restraint and, in a sudden stop or crash, could result in serious injury or death.

DO NOT fasten multiple tether hooks on the same tether anchor in the vehicle.

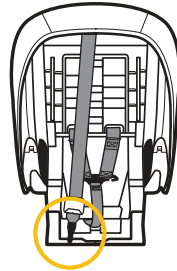

Storing Top Tether Strap

The tether strap **MUST** be properly stored in its storage location when:

- installing in **Rear-Facing Mode**; **OR**
- using the **Booster Seat Mode**; **OR**
- the car seat is not installed in a vehicle.

Attach the tether hook to its storage location as shown. Gently tighten to remove slack.

WARNING:

NEVER take your child out of the child restraint while the vehicle is moving.

NEVER leave your child unattended. Placing your child in a hot child restraint may result in burns.

DO NOT use a child restraint with damaged or missing parts.

DO NOT use a child restraint with cut, frayed, or damaged harnesses.

DO NOT substitute parts or try to modify the child restraint in any way. **DO NOT** lubricate buckles and fasteners.

DO NOT use any child restraint accessory except those approved by Dorel Juvenile Group.

NEVER allow any child to play with this child restraint; it is not a toy.

DO NOT remove or cover up any of the warning labels or other labels on the child restraint.

This child restraint has been certified for use in passenger vehicles. **DO NOT** use in a boat, on a motorcycle or in a cargo van or bus where there are no seat belts or tether anchors.

Read all instructions for additional warnings.

Vehicle Seating Position

WARNING:



NEVER place a child rear-facing in a seating position with an active frontal air bag.

Check the vehicle owner's manual for more information about air bag/child restraint use.



Use the child restraint only on vehicle seats that face forward.



DO NOT use on seats that face the sides or rear of the vehicle.

For vehicles without a back seat, refer to your vehicle owner's manual.



Children are safer when properly restrained in rear seating positions than in the front seating positions.

According to accident statistics, children in rear seating positions are statistically safer, whether you have air bags, advanced air bags, or no air bags at all.

If you are not sure where to place the car seat in your vehicle:

- Consult your vehicle owner's manual; **OR**
- Contact Dorel Juvenile Group Consumer Care Department; **OR**
- Visit your local Child Passenger Inspection Station. Go to <https://www.nhtsa.gov/equipment/car-seats-and-booster-seats> to find your closest station.

To avoid your child being seriously burned, take the following precautions:

- Park in the shade or where the sun does not directly hit the car seat.
- Cover the car seat with a sheet or blanket when not in use.
- Check for hot seat and buckles before placing child in car seat.

To help protect your vehicle seat's upholstery from damage: you may use an accessory approved by Dorel Juvenile Group or a single layer towel underneath and behind car seat.

WARNING:

Check the vehicle belt or lower anchor belt before each use. Use only if the belt can be tightened properly and locked securely in place.

Even when unoccupied, this child restraint **MUST** be firmly secured to the vehicle with the lower anchor belt or with the vehicle seat belt.

Even when unoccupied, this booster seat **MUST** be firmly secured to the vehicle with the vehicle seat belt.

In a crash or sudden stop, an unsecured child restraint or booster seat could injure occupants.

Replacement & Expiration

DO NOT risk your child's safety.

To keep your child as safe as possible, Dorel Juvenile Group strongly recommends replacing the car seat even after a minor crash; even if it was not occupied at the time.

Replacement After a Minor Crash

The National Highway Traffic Safety Administration states that for a crash to be considered minor **ALL of the following MUST be true:**

- Vehicle able to drive away from the crash site; **AND**
- Vehicle door nearest the car seat was not damaged; **AND**
- No passengers were injured; **AND**
- Airbags did not deploy; **AND**
- There is no visible damage to the car seat.

If the crash your car seat was involved in meets **ALL** the criteria, you may not need to replace the car seat.

If one or more of these criteria are not true or if you are uncertain of any of your answers, replace the car seat immediately.

Replacement After a Moderate to Severe Crash

You **MUST** replace this car seat if it has been in a moderate to severe car crash.

This car seat is intended to protect a child in a single crash. During a crash, the car seat and all of its parts absorb crash energy which can deform or weaken it. Damage is not always visible. A damaged car seat **MUST** be replaced immediately.

Expiration

On the side of the car seat there is a date of manufacture label as shown.

DO NOT use this car seat more than 10 years after the date of manufacture.



Registration & Safety Notices

63

Please complete the postage-paid registration card that came with your child restraint, and send it to us.

Child restraints could be recalled for safety reasons.

You must register this restraint to be reached in a recall.

Send your name, address, e-mail address if available and the restraint's model number and manufacturing date to:

Dorel Juvenile Group

2525 State Street
Columbus, IN 47201

or call 1-800-951-4113 or register online at
<https://www.maxicosi.com/us-en/registration/>.

For recall information, call the U.S. Government's Vehicle Safety Hotline at 1-888-327-4236 (TTY: 1-800-424-9153), or go to www.NHTSA.gov.

0515079 Tear Off and Mail This Part or Register Online 4348-0081D

Consumer: Just fill in your name, address and email. Please print (use dark ink).

Your Name

Your Street Address

City State Zip Code

Email Address (optional)

Model Number	Model Name	Manufacture Date
AB123CDE	Maxi-Cosi Car Seat	05/16/2015

Barcode: L#11 B265035

Example of model number, manufacture date, and line code.



If you don't have the card or if your address changes, you will find the model number, manufacture date, and line code on the label located on the side of the car seat.

Aircraft Information

This restraint is certified for aircraft use when used with the internal harness.



Rear-Facing Aircraft Installation

Follow the steps on pages 13-17, skipping the LATCH: Lower Anchor steps.



Forward-Facing Aircraft Installation

Follow the steps on pages 24-27, skipping the LATCH: Lower Anchor & tether strap steps.



Booster Seat

This restraint is not certified for aircraft use when used as a booster seat because aircraft seats do not have shoulder belts.

Install the car seat in a window seat to avoid blocking the aisle. If the aircraft lap belt is too short, ask the flight attendant for a belt extender.

Use only on forward-facing aircraft seats. Contact the airline for their specific policies.

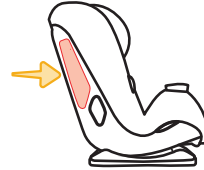

Some airlines may ask to see a label stating that this car seat is certified for aircraft use.

There is an airplane certification label located on the side of this car seat as shown.

WARNING:

You **MUST** store the lower anchor belt and tether strap when installing with aircraft belts.

Dorel Juvenile Group, Inc. (DJG) warrants this product to the original retail purchaser as follows: This product is warranted against defective materials or workmanship for one year from the date of original purchase.

An original receipt is required to validate your warranty.

DJG will, at its option, provide replacement parts or replace this product. DJG reserves the right to substitute if the part or model has been discontinued.

To make a claim under this warranty, please contact our Consumer Care Department by phone: 1-800-951-4113 or text: 1-812-652-2525. Our hours of operation are from 8:00 a.m. to 6:00 p.m. EST Monday through Thursday and from 8:00 a.m. to 4:30 p.m. on Friday.

Proof of purchase is required and shipping charges are the responsibility of the consumer.

Warranty Limitations: This warranty does not include damages which arise from misuse or abuse of this product.

Limitation of Damages: The warranty and remedies as set forth are exclusive and in lieu of all others, oral or written, expressed or implied. In no event will DJG or the dealer selling this product be liable to you for any damages, including incidental or consequential damages, arising out of the use or inability to use this product.

Limitation of warranties and other warranty terms and state law rights: Any implied warranties, including implied warranties of the merchantability and fitness for a particular purpose, shall be limited to the duration and terms of the express written warranty.

Some states do not allow limitations as to how long an implied warranty lasts or the exclusion or limitation of incidental or consequential damages, so the above limitations may not apply to you.

This warranty gives you specific legal rights, and you may have other rights, which vary from state to state. Neither DJG nor the dealer selling this product authorized any person to create for it any other warranty, obligation, or liability in connection with this product.

Please note: Our product warranty only applies when purchased from an authorized Maxi-Cosi retailer. The origin of products not purchased through these authorized retailers is unknown and could be counterfeit.

We cannot support products from an unknown origin as we cannot verify the handling or condition of such merchandise. We maintain a strong network of authorized retailers to ensure you are purchasing safe and complete products.

Fulfillment by a third party does not guarantee you are purchasing from one of these authorized retailers. Pricing which is inconsistent with the majority of retailers

is a strong indication that the retailer is not authorized, as we have a consistent price offering across all authorized retailers.

If you are unsure of the authorization status of a retailer you are considering purchasing from, or have purchased from, you can check www.maxicosi.com/us-en/find-a-retailer; or call our Consumer Care Department at 1-800-951-4113; or text us at 1-812-652-2525.